



III. D.

690 Chesterfield Pkwy W • Chesterfield MO 63017-0760
Phone: 636-537-4000 • Fax 636-537-4798 • www.chesterfield.mo.us

Architectural Review Board Staff Report

Project Type: Site Development Section Plan

Meeting Date: May 12, 2016

From: Aaron Hrenak
Project Planner

CC: Aimee Nassif, Planning & Development Services Director

Location: West of RHL Drive, south of its intersection with Chesterfield Airport Road.

Applicant: CSRS, INC.

Description: Chesterfield Commons West, Outlot 4 (Raising Cane's) SDSP: A Site Development Section Plan, Landscape Plan, Lighting Plan, Architectural Elevations and Architect's Statement of Design for a 2.08 acre tract of land zoned "PC" Planned Commercial District located west of RHL Drive, south of its intersection with Chesterfield Airport Road.

PROPOSAL SUMMARY

CSRS INC, on behalf of the applicant, has submitted a request for a 23 feet 7 inch tall, 3,618 square foot restaurant building located on the west side of RHL Drive, south of its intersection with Chesterfield Airport Road. The subject site is one of the outlots located within the Chesterfield Commons West development, which is zoned "PC" Planned Commercial District and is governed under the terms and conditions of the City of Chesterfield Ordinance Number 2156. The applicant is proposing to demolish the existing restaurant building, formerly Emperor's Palace, and to redevelop the site for a new restaurant user. The exterior building materials will be comprised of stucco, face brick, galvanized steel sheet with kynar finish, and stainless steel.

HISTORY OF SUBJECT SITE

In 2000, the first planned district was approved for the Chesterfield Commons West development and in the years since, the site-specific governing ordinance has been amended to include additional land uses into the planned district. The most recent ordinance amendment occurred in 2005, when the City of Chesterfield approved Ordinance Number 2156 to allow for seasonal outdoor storage for the westernmost anchor store, currently occupied by Home

Depot, within the development. Ordinance Number 2156 did not affect entitlements or restrictions for the subject site; however, it is the current ordinance of record.

The original Site Development Concept Plan for Chesterfield Commons West was approved by the City Council in 2003 with multiple minor amendments in the following years. In August of 2002, the Planning Commission approved a Site Development Section Plan for a 9,496 square foot structure on the subject site. In November of 2003, an Amended Site Development Section Plan was approved. This Amended Site Development Section Plan approved a building addition which expanded the overall building area to 10,430 square feet.

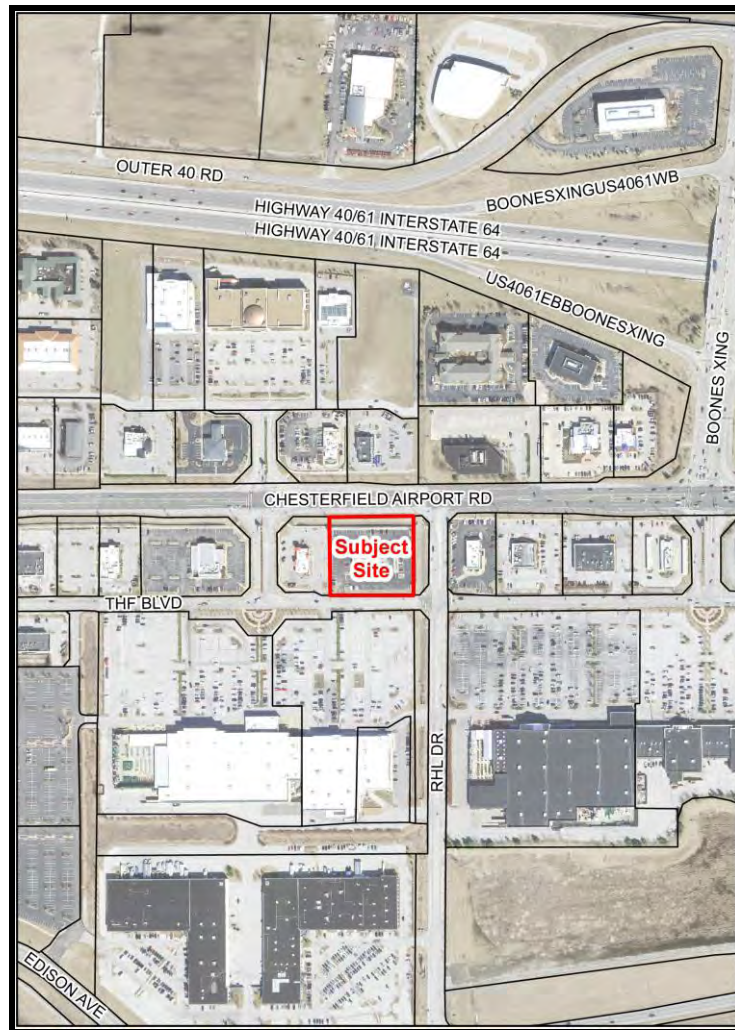

Figure 1

STAFF ANALYSIS

The subject site is zoned "PC" Planned Commercial District under the terms and conditions of City of Chesterfield Ordinance Number 2156. This ordinance allows for a total building floor area not to exceed 246,935 square feet for the portion of the Chesterfield Commons West development governed by Chesterfield Ordinance Number 2156. Thus far 216,920 square foot of the allowable

development area has been constructed. This development proposal will reduce the total developed area by 6,812 square feet.

The table below shows a breakdown of the buildings in Chesterfield Commons West:

Chesterfield Commons West Development		
Lot Number	Tenant	Total Square Feet
Outlot 1	Syberg's	5,741
Outlot 2	Old Spaghetti Factory	9,983
Outlot 3	Hardee's	3,472
Outlot 4	Emperor's Wok	10,430
Outlot 4	Raising Cane's (Proposed)	3,618
Lot 6 (total)	Multiple	187,294
Total Existing Building Area		216,920
Total Proposed Building Area		210,108
Total Building Area Permitted Per Ordinance		246,935

General Requirements for Site Design:

A. Site Relationships

The subject site is located west of RHL Drive, south of its intersection with Chesterfield Airport Road. Like the existing outlot buildings in the development, the main entrance of the building will face north towards Chesterfield Airport Road. Outdoor seating is situated to the front of the structure, with pedestrian access from the sidewalk at the north of the site and from the primary parking area to the west of the site via a painted crosswalk. Primary access from THF Boulevard is aligned with the drive aisles of the parking area for Lot 6, and cross access to Outlot 3 is available to the northwest of the site.

B. Circulation System and Access

The proposal includes one access point off of THF Boulevard, a private drive accessed from RHL Drive or Chesterfield Commons West Drive. Similar to other lots in this development, this lot will not have direct access to Chesterfield Airport Road. There is a shared access between Lots 4 and 5 that provides access to THF Boulevard.

Additionally, the developer has proposed the continuation of a 5 foot sidewalk along Chesterfield Airport Road which will tie the existing sidewalk to the intersection at RHL Drive. A sidewalk along THF Boulevard provides pedestrian access to the southern portion of the development. This proposal provides internal pedestrian connectivity to the sidewalk along the north of the site, and to the parking area to the west. The drive thru queuing line provides access for 9 vehicles prior to conflicting with the pedestrian cross walk to the west of the site.

required by Article 4 of the Unified Development Code, and the windows are partially screened from view from RHL Drive by tree plantings.

C. Materials and Color

The proposed color palette for the building is a mixture of earth tones contrasted with dark metallic grey accents. The building will complement the quality of development in the Chesterfield Valley through the use of brick, stucco, aluminum, and steel. The proposed material colors include light and medium earth tones with darker accent colors, ranging from tan to a dark brown, and aluminum. The entry doors and windows will be an aluminum-framed glass system which will complement the chosen color palette for the building. Additionally, there are canopies constructed of galvanized steel with kynar finish proposed on the front and side elevations to further accent the building.

D. Landscape Design and Screening

The request includes landscaping required by the City of Chesterfield Tree Preservation and Landscape Requirements. This section requires a 30' landscape buffer along all collector or arterial roadways. The applicant has submitted a request for modification to this requirement relative to the limited planting area along Chesterfield Airport Road, and that request is currently under review by Staff. The existing street trees along Chesterfield Airport Road and hedgerow along the retaining wall will be maintained. A landscape strip to the northeast of the structure defines the proposed seating area and additional planting to the northwest of the structure frames the main entryway. Substantial planting to the south of the structure provides a backdrop for the menu board and enhances the spaces created by the articulation of the structure. Landscaping to the west of the site provides adequate screening between Outlots 3 and 4. Furthermore, the Landscape Plan shows plantings along THF Boulevard, RHL Drive, and within the site as required by the Tree Preservation and Landscape Requirements.

There are bio-retention areas along the eastern property line and to the northwest of the site. These areas will be planted and designed to MSD standards and will help capture storm water runoff from the site.

The dumpster enclosure on the site will consist of 8 foot tall brick screen walls to match the building. The proposed enclosure doors will be metal or vinyl painted gloss black. This enclosure will be further screened by evergreens on the north, east, and south sides. The roof-top equipment will be screened by parapets on the building.

E. Lighting

The plan proposes several utilitarian and architectural accent lighting fixtures. The building will include 3 gooseneck fixtures on the front elevation to accent the brick work on this portion of the structure and ultimately will provide lighting to potential signage in this area. Various architectural lights are integrated into the building design and proposed near the entrances and drive-thru windows. The east elevation will also include 3 wall sconces which will illuminate the wall area between the drive-thru windows. The vertical illumination produced by the sconces will terminate below the building roof line. The area near the drive-thru windows will be vertically illuminated from a fixture recessed within the drive-thru awning. The awnings at

building entries will integrate the same recessed vertical lighting fixture to illuminate the walkways at the north and west of the structure. More utilitarian lighting is located above the building entries on the southern elevation and within the "staging area" on the southern elevation. The utilitarian wall packs and fixtures proposed on the southern elevation are not full cut off nor flat lens and do not adhere to the City of Chesterfield Lighting Standards. The applicant is aware of the issue, and is working to find fixtures that meet the standards. The parking area fixtures are proposed to be mounted at 20 feet and are fully shielded, full cut off LED fixtures. The cut-sheets for all the proposed fixtures are included in the ARB submittal.

White neon accent lighting is proposed at the roofline where the stucco and kynar finished galvanized steel materials meet. Neon architectural accent lighting requires Planning Commission approval; however, Staff requests comment on this element at this time.

DEPARTMENTAL INPUT

Staff has reviewed the Site Development Section Plan, Landscape Plan, Lighting Plan, Architectural Elevations and Architect's Statement of Design. Be advised, this project is still going through development review by City Staff and will not proceed to the Planning Commission until all outstanding items have been addressed. All recommendations made by the ARB will be included in Staff's report to the Planning Commission.

Staff requests review and recommendation on this submittal for Chesterfield Commons West, Outlot 4 (Raising Cane's).

MOTION

The following options are provided to the Architectural Review Board for consideration relative to this application:

- 1) "I move to forward the Site Development Section Plan, Landscape Plan, Lighting Plan, Architectural Elevations and Architect's Statement of Design for Chesterfield Commons West, Outlot 4 (Raising Cane's) as presented, with a recommendation for approval (or denial) to the Planning Commission."
- 2) "I move to forward the Site Development Section Plan, Landscape Plan, Lighting Plan, Architectural Elevations and Architect's Statement of Design for Chesterfield Commons West, Outlot 4 (Raising Cane's) to the Planning Commission with a recommendation for approval with the following conditions..."

Attachments

1. Architectural Review Packet Submittal



**ARCHITECTURAL REVIEW BOARD
Project Statistics and Checklist**

Date of First Comment Letter Received from the City of Chesterfield 3/11/16

Project Title: Raising Cane's Chicken Fingers #247 **Location:** 17360 Chesterfield Airport Road

Developer: Raising Cane's Restaurants, LLC **Architect:** CSRS, INC **Engineer:** Premier Civil

PROJECT STATISTICS:

Size of site (in acres): 2.08 **Total Square Footage:** 3,578 **Building Height:** 24'

Proposed Usage: Restaurant with drive-thru service

Exterior Building Materials: Brick wainscot, stucco, and storefront glazing

Roof Material & Design: Parapet, flat roof with TPO membrane

Screening Material & Design: Roof screen with stucco or EIFS

Description of art or architecturally significant features (if any): Painted murals on side of building

ADDITIONAL PROJECT INFORMATION:

Checklist: Items to be provided in an 11" x 17" format

- Color Site Plan with contours, site location map, and identification of adjacent uses.**
- Color elevations for all building faces.**
- Color rendering or model reflecting proposed topography.**
- Photos reflecting all views of adjacent uses and sites.**
- Details of screening, retaining walls, etc.** *Roof top screen detail provided*
- Section plans highlighting any building off-sets, etc. (as applicable)** *Not applicable per Aaron Hrenak*
- Architect's Statement of Design which clearly identifies how each section in the Standards has been addressed and the intent of the project.**
- Landscape Plan.**
- Lighting cut sheets for any proposed building lighting fixtures. (as applicable)**
- Large exterior material samples. (to be brought to the ARB meeting)** *Material samples have been provided*
- Any other exhibits which would aid understanding of the design proposal. (as applicable)**
no other exhibit has been deemed necessary for presentation
- Pdf files of each document required.**

ARCHITECTURAL REVIEW DESIGN STANDARDS

Please refer to [Section 04-01 of the Unified Development Code](#) for the Architectural Review Design Standards.

ARCHITECTURAL TERMS

Please refer to [Section 10-06 of the Unified Development Code](#) for definitions of Architectural Terms.



April 25, 2016

City of Chesterfield Planning

Re: Raising Cane's Chesterfield Commons West, Outlot 4
Project Location: 17360 Chesterfield Airport Rd.
Project Name: Raising Cane's Chicken Fingers, Store #247

CSRS, INC.

6767 Perkins Road, Suite 200
Baton Rouge, Louisiana 70808

Phone. (225) 769-0546
Fax. (225) 767-0060

Architect's Statement of Design

ARCHITECT'S STATEMENT

The following list of items identify how the Architectural Review Design Standards are being addressed for the above mentioned project.

INTRODUCTION

This new development for Raising Cane's Chicken Fingers will occupy Outlot 4 of Chesterfield Commons West, currently the Emperor's Palace Restaurant which recently closed. The site is located at 17360 Chesterfield Airport Road which is the southwest corner of the intersection of Chesterfield Airport Road and RHL Drive. The existing Emperor's Palace building and parking area will be demolished for the construction of the Raising Cane's building and new parking.

GENERAL REQUIREMENTS FOR SITE DESIGN

A. Site Relationships

The site consists of 2.08 acres which is relatively flat. Once demolition is complete the site will be finish graded to prepare the new building pad with no significant change in elevation to the site. The proposed building will be situated facing Chesterfield Airport Road with its entries plainly visible to the adjacent roadways. Landscaping and masonry walls will be used to screen the proposed trash enclosure from the neighboring roadways. Concrete walks will be provided to establish safe and convenient pedestrian access to the entry doors.

B. Circulation System and Access

Access to the site will be from THF Boulevard and via cross access with the adjacent Hardee's to the west. The building will be located on the eastern portion of the site with the parking field kept as close as possible to the entry points while still providing smooth circulation for the drive-thru window traffic. Parking is located on all four sides of the building with accessible parking located across the drive aisle at the front of the building. Designated striped paths are provided for pedestrian access to the walkways at the building. Proposed pavement radii are such that delivery, waste and emergency vehicles can easily enter and circulate around the site. No bicycle racks are proposed but bicycles can be parked in areas near the building which are not used for accessible access.

C. Topography

The site is relatively flat therefore berms could not be incorporated into the site design for screening and/or buffering. Minimal changes will be made to the site topography with the exception of the addition of bioretention areas along the eastern and northwestern portions of the site to satisfy MSD's water quality requirements. Slope changes will be smooth so as to be visually appealing.

D. Retaining Walls

No new retaining walls are proposed for this site however the existing wall located along the drainage swale on Chesterfield Airport Road shall remain in place.

GENERAL REQUIREMENTS FOR BUILDING DESIGN

A. Scale

Building elements are highly compatible in scale and general conformance with the neighboring buildings. The objective is to create an attractive and clear expression of the building through the use of glass and canopy projections that will attract favorable attention to itself. Changes in wall texture are proportional in amounts.

B. Design

1. The building incorporates a combination of masonry, stucco, and glass to create a variety in the design's composition, which maintaining architectural rhythm horizontally and vertically across the building.
2. Landscaping will be used immediately around the building and throughout the site to enhance the nature of this project.
3. The utility incorporates its signature colors with the materials required by Chesterfield Commons.
4. The building elevations constitute similar architectural quality to the surrounding building while architecturally maintaining its signature characteristics.
5. There are not any artistic sculptures proposed for this site.
6. This building is 2% more efficient than current energy code standards.
7. Metal awnings and recesses are used to cover and articulate the building entries.
8. There are no plans for temporary barrier walls.
9. The HVAC units are located on the roof which are screened from view.

C. Materials and Color

The design, general scale, and orientation of the building creates a visual relationship between the neighboring Chesterfield Commons development. The building is composed of masonry, glass, stucco, and metal for a variety of elements that work together as a composition. Vertical and horizontal material proportion integrates nicely with a human scale and pronounced entries invite visitors into the building.

D. Landscaping Design and Screening

Landscaping has been designed by Cynthia Cash of Baton Rouge Louisiana to tie into and compliment the surrounding Chesterfield Commons development. A mixture of evergreen and deciduous trees and shrubs as well as native grasses and flowers have been provided to add color and interest all year round. Landscaped areas will be provided adjacent to the building and along parking areas to create a landscaped foreground for each building elevation and to provide pleasing views from adjacent roadways and property. All landscaped areas are protected from traffic by vertical curbs. The trash enclosure is located at the southeast corner of the site and will be screened by masonry walls and evergreens.

E. Signage

Signage is shown for informational purposes only and will require a separate review.

F. Lighting

Lighting will be situated so as not to cast directly on adjoining properties or roadways. Lighting will require a separate review process.

Sincerely,

Javier Sola, AIA
CSRS, Inc.
310.489.8976
sola@csrsonline.com



1



2



3



4

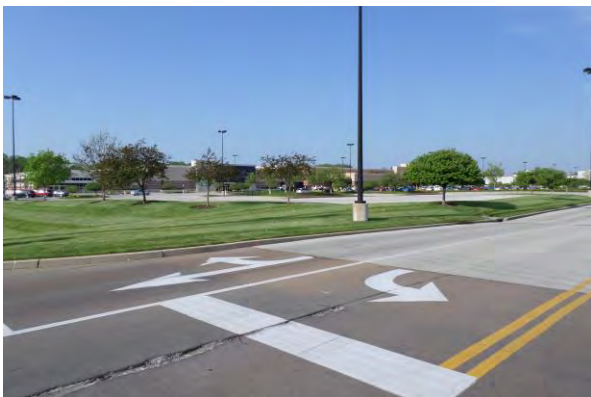

5



6



7



8



9

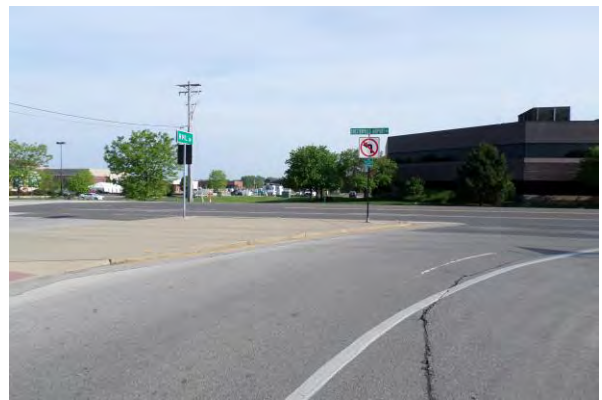

10

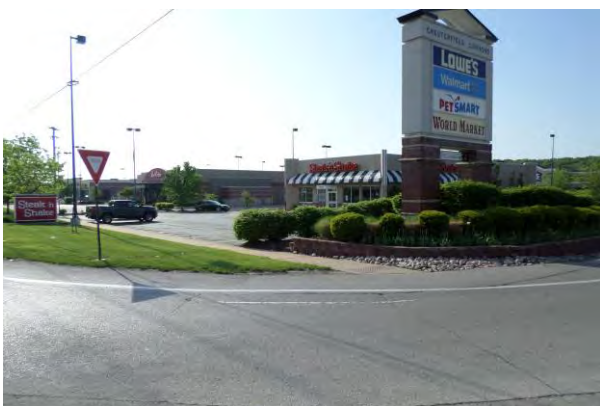

11



12



13



14



15



16



17



18



19



20



21



22



23



24



25



26



27



28



29



30



31



32



33



34



35

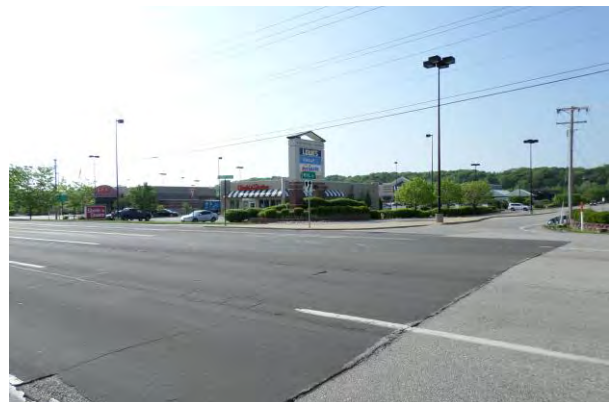

36



37

Catalog Number	Type Q
Notes	
Type	

FEATURES & SPECIFICATIONS

INTENDED USE — Intended for low to medium mounting heights where dust, dirt, humidity or moisture are present. Ideal for canopies, dock areas, wastewater treatment, refrigerated areas, food processing and other non-hazardous environments. Certain airborne contaminants can diminish integrity of acrylic. [Click here for Acrylic Environmental Compatibility table for suitable uses.](#)

CONSTRUCTION — Housing formed from impact resistant, UV stabilized, fiberglass reinforced polyester with cold-rolled steel enclosed wireway. Poured in place gasketing provides a seal between housing and diffuser. Captive, corrosion-resistant cam-action latches secure the diffuser; six on 4' units, and ten on 8' units. Stainless steel latches available.

Finish: Painted parts pretreated with a five-stage iron-phosphate process to ensure superior paint adhesion and corrosion resistance, then finished with a high-gloss, baked white enamel.

OPTICS — High-impact acrylic diffuser with a stippled interior surface to spread lamp image.

PLEASE NOTE: The standard 4' diffuser is 2-1/4" deep, and the standard 8' or 48T8HO diffuser is 3" deep. To order the 4' diffuser so that it matches the depth of the 8' diffuser, order the ARDP option. The 8' diffuser is not available in the 2-1/4" depth.

ELECTRICAL — Thermally protected, resetting, Class P, HPF, non-PCB, UL Listed and CSA Certified ballast is standard.

AWM, TFN, THHN wire throughout, rated for required temperatures.

INSTALLATION — For unit or row installations, surface (ceiling or wall) or suspended mounting. Wall mounting; horizontal orientation only for use in damp locations. Stainless steel surface spring-mounting brackets standard (2 included).

LISTINGS — 120V, 277V and MVOLT are UL Listed and CSA Certified (standard). 347V is CSA Certified (see Options). NOM Certified (see Options). Listed for 25°C ambient and wet locations for covered-ceiling applications. IP65 rated. Optional IP67 rating available (supplied with 8 latches on 4' units and 14 latches for 8' units; covered ceiling not required). Compliance to FDA/USDA requirements and/or NSF splash-zone certification.

WARRANTY — 1-year limited warranty. Complete warranty terms located at www.acuitybrands.com/CustomerResources/Terms_and_conditions.aspx

Actual performance may differ as a result of end-user environment and application.

Note: Specifications subject to change without notice.

Enclosed and Gasketed Industrial



DMW

INSTANT, PROGRAMMED OR RAPID START

4' or 8' length
1, 2 or 3 lamps

Specifications	
Length:	50 (127.0) 98 (248.9)
Width:	8-1/8 (20.6)
Fixture depth:	5-5/8 (14.3) (deep lens) 4-3/4 (12.1) (standard lens)

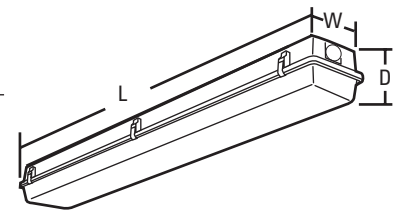

All dimensions are shown in inches (centimeters) unless otherwise noted.

ORDERING INFORMATION

Lead times will vary depending on options selected. Consult with your sales representative.

Example: DMW 2 32 MVOLT GEB10IS

DMW Series	Number of lamps	Lamp type	Diffuser	Voltage	Ballast	Options
DMW	1	28T5 28W T5 (48") ³	(blank)	120	GEB10IS	ELDW Emergency battery pack (nominal 300 lumens) ^{7,8}
Wet location	2	32 32W T8 (48")	2-1/4" Deep high-impact acrylic (50% DR)	277		EL5DW Emergency battery pack (nominal 500 lumens) ^{7,8}
For tandem double-length unit, add prefix T. Example: TDMW ¹	3 ²	48T8HO 44W T8HO (48")	3" Deep high-impact acrylic (50% DR) ⁵	347		EL6DW Emergency battery pack (nominal 600 lumens) ^{7,8}
		54T5HO 54W T5HO (48") ⁴	ARDP	MVOLT	GEB10RS	EL14DW Emergency battery pack (nominal 1400 lumens) ^{7,8}
		96T8 59W T8 slimline (96")		others available		GLR Internal fast-blow fusing ⁹
		96T8HO 86W T8 380mA (96")			GEB10PS	GMF Internal slow-blow fusing ⁹
						RIF1 Radio interference filter, one per fixture
					GEB10PS90	STSL Stainless steel latches
						WLF Wet location fittings (one pair; installed, top, for use with 1/2" rigid conduit)
						IP67 IP67 rated; requires 8 latches for 4' fixtures and 14 latches for 8' fixtures
						CSA CSA certified (only required for 347V)
						NOM NOM certified
						CS89 6' white cord, 16/3, no plug, wet location
						CS88 6' Brad Harrison 16/3 cord and straight blade plug set wet location ⁹
						MSI_ Wet location occupancy sensor pre-wired ^{9,10}
						DL Damp location ¹¹

Accessories: Order as separate catalog number.	
BCD	Bracket for hanger chain mounting. Two per package ¹²
HC36	Chain hangers (1 pair, 36" long); Requires BCD
WLF	Wet location fittings (1 pair, not installed, for use with 1/2" rigid conduit)
DMW/VRISMB	Surface mounting brackets (pair) ¹³

Notes

- Not available with 96T8 or 96T8HO.
- 32W T8 and 28 T5 lamps only.
- Must specify GEB10PS ballast.
- Must specify GEB10PS90 ballast.
- ARDP standard on 48T8HO and 8' fixtures.
- Available 347V T8 only.
- Must specify voltage; 120 or 277V only.
- Check battery pack spec sheet on www.powerentrysafety.com for compatibility.
- Must specify voltage. Not available with MVOLT.
- For mounting up to 8' specify MS18; for mounting up to 20' specify MS120.
- DL option required for battery packs, sensors, and cord sets that are not wet location listed.
- For stainless steel, specify STS (ex: BCD STS).
- Brackets ship standard with fixture. For replacement purposes only.

DMW Instant, Programmed or Rapid Start

MOUNTING DATA

For unit or row installation, surface (ceiling or wall) or suspended mounting.

DMW — Drill holes through housing and channel at appropriate locations. Includes gasketed wet location fittings on ends for power feeding/mounting. Fitting is threaded for 1/2" rigid conduit (optional WLF for top mounting). Attach to surface using fasteners and sealing washers (by others) appropriate for ceiling materials.

Unit installation — Minimum of two hangers required.

Row installation — Minimum of two hangers required. Recommended 1/2" nipple with union (by others) for DMW.

MOUNTING ACCESSORIES

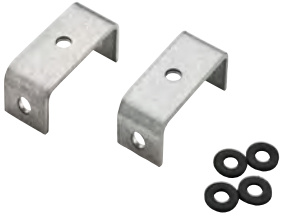

BCD



HC36

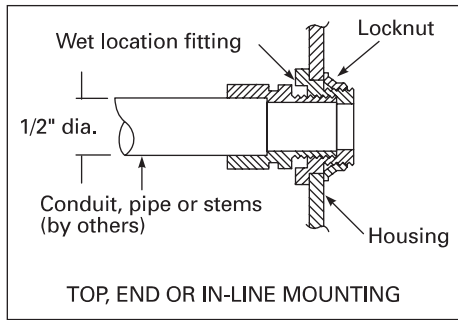

DIMENSIONS

Inches (centimeters). Subject to change without notice.

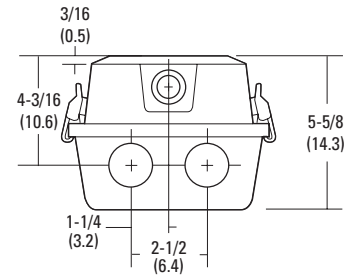
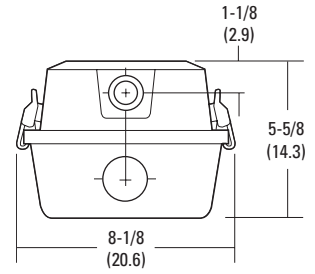

A = 11/16 (17) Dia.

B = 1-1/8 (29) Dia.

Recommended mounting locations
(field drilling required)

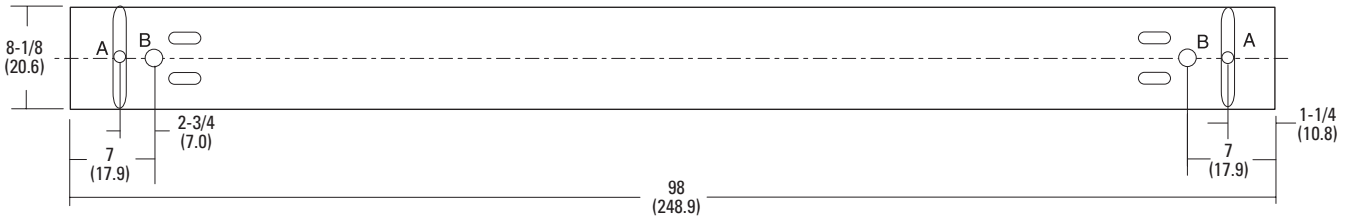
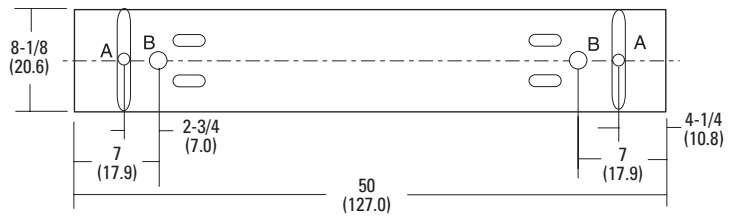

PHOTOMETRICS

See www.lithonia.com.

TWH



Intended Use

For outdoor storage areas, warehouse and factory perimeters and loading docks. **Contact with a direct forceful spray of water during operation can result in glass breakage. Not recommended for car wash applications.**

Features

Housing – Rugged, die-cast aluminum housing. Corrosion-resistant captive external hardware includes slotted hex-head fasteners. Standard finish is dark bronze (DDB) corrosion-resistant polyester powder. Other architectural colors available.

Optics – Reflector is specular anodized aluminum. Refractor is prismatic borosilicate glass. Lens is sealed and gasketed to inhibit entrance of outside contaminants.

Electrical – 70-150W HPS and 100-150M: High-reactance, high-power factor. All others: Constant-wattage autotransformer. Ballasts are

copper wound and 100% factory tested. UL Listed. Electrical components mounted in hinged front cover that includes primary and secondary electrical disconnect.

Socket – Glazed porcelain (mogul-based; 175M and above; medium based: 150M, 150S and below), horizontally oriented with copper alloy, nickel-plated screw shell and center contact. UL Listed 660W, 600V for medium base; 1500W, 600V for mogul base. 4KV pulse rated.

Installation – Back housing is separated from front housing, eliminating ballast weight and promoting easy handling. Top 3/4" threaded wiring access. Back access through removable 3/4" knockout. Mount on any flat, non-combustible vertical surface.

Listings

UL Listed (standard). CSA or NOM Certified (see Options). UL Listed for wet locations. IP65 rated (250W and below) or IP54 rated (400W).

Ordering Information

Designation	Voltage	Options
High pressure sodium		
TWH 70S	120	Installed
TWH 100S	208 ⁶	SF Single fuse, 120V, 277V, 347V (n/a TB or TBV)
TWH 150S	277	DF Double fuse, 208V, 240V, 480V (n/a TB or TBV)
TWH 200S	347	EC Emergency circuit ^{10,11}
TWH 250S	480 ⁷	QRS Quartz restrike system ^{10,11}
TWH 400S	TB ⁸	CR Enhanced corrosion resistance
Metal halide		
TWH 100M	TBV ⁹	CRT Non-stick protective coating ¹²
TWH 150M ¹		PE Photoelectric cell – button type (n/a TB, TBV or 480)
TWH 175M		PER NEMA twist-lock receptacle ¹³
TWH 200M ²		FS Full shield
TWH 250M ¹		TWHWG Wireguard ¹⁴
TWH 320M ²		TWHVG Vandal guard ¹⁴
TWH 350M ²		SCWA Super SCWA pulse start ballast (150M-400M only; n/a 175M)
TWH 400M ^{1,3}		RHP Reactor high-power factor ballast (HPS 150W & below only)
Mercury vapor		
TWH 100H		RNP Reactor normal-power factor ballast (HPS 150W & below only, 120V only)
TWH 175H		XHP Reactance high-power factor ballast (HPS 150W & below only)
TWH 250H		CSA CSA Certified ¹⁵
Low pressure sodium		
TWH 35L ⁴		NOM NOM Certified (consult factory)
Incandescent		
TWH 300I ^{5,10}		LPI Lamp included ¹⁶
		L/LP Less lamp
		TP Tamperproof fasteners

For optional architectural colors, see page 543.

Example: TWH 250S TB LPI

Accessories (Order separately)

RK1PEB1	Photoelectric control kit, 120V
RK1PEB2	Photoelectric control kit, 208V, 240V, 277V
RK1PEB1CSA	Photoelectric control kit, 120V
RK1PEB3CSA	Photoelectric control kit, 347V
RK1TWHGLFS	Field installable full shield, for cutoff
PE1	NEMA twist-lock photocontrol, 120V, 208V, 240V ¹⁷
PE3	NEMA twist-lock photocontrol, 347V ¹⁷
PE4	NEMA twist-lock photocontrol, 480V ¹⁷
PE7	NEMA twist-lock photocontrol, 277V ¹⁷

NOTES:

- 1 May be ordered with SCWA.
- 2 Must be ordered with SCWA.
- 3 Requires ED or BT 28 reduced jacket lamp.
- 4 Not available with TB.
- 5 120V only, A21 lamp.
- 6 Consult factory for availability in Canada.
- 7 Consult factory for availability in Canada, n/a 150M.
- 8 Optional multi-tap ballast (120V, 208V, 240V, 277V). In Canada 120V, 277V, 347V; ships as 120V/347V.
- 9 Optional 5-tap ballast (120V, 208V, 240V, 277V, 480V).
- 10 Lamp not included.
- 11 Quartz lamp wattage not to exceed ballast wattage rating.
- 12 Black finish only.
- 13 Photocell not included.
- 14 Requires factory modification.
- 15 Not available with TBV.
- 16 Not available with incandescent.
- 17 PER must be ordered with fixture.
- 18 Other ballast types available.

Dimensions are shown in inches (centimeters) unless otherwise noted.

- Height: 15-1/4 (40)
- Width: 16-1/4 (41.3)
- Depth: 8 (20.3)
- Weight: 26-42 lbs (12-19 kg)

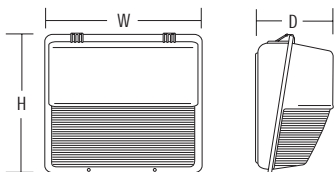

Lamp/Fixture Data ¹⁸			
Wattage	Ballast	Lamp type	Base type
High pressure sodium (med/mog/clear)			
70	HX-HPF	E17	medium
100	HX-HPF	E17	medium
150	HX-HPF	E17	medium
250	CWA	BT28	mogul
400	CWA	BT28	mogul
Metal halide (med(150)/mog/clear)			
150	HX-HPF	E17	medium
175	CWA	BT28	mogul
250	CWA	BT28	mogul
400	CWA	ED or BT28	mogul

lightquick[®] XD
Express delivery products.

See page 11 for details about LightQuick XD.

Description

TWH 250M TB LPI

TWH 400M TB LPI

HH9X9SQPL Type S

9"X9" Architectural Square CFL Downlight

Architectural

Catalog Number:
HH9X9SQPL-1X9-E-MVOLT

Project Name:

Type:

Note:

MAXILUME
ARCHITECTURAL LIGHTING

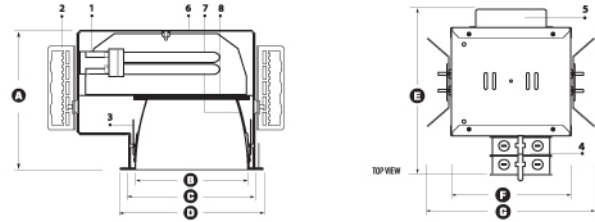

- A. Height** = 5-3/4"
- B. Trim Aperture** = 9-1/8" X 9-1/8"
- C. Cut-out** = 9-1/2" X 9-1/2"
- D. Trim Outside Diameter** = 10-3/8" X 10-3/8"
- E. Width** = 14"
- F. Length** = 9-5/8"
- G. Max. Length** = 12"

DESCRIPTION

1. LAMP HOLDER - Lamp holder effectively provides heat dissipation and ventilation. Unitized optics guarantees proper trim to housing installation. Tool-less installation adjustability from either outside the housing or inside the housing.

2. MOUNTING BRACKET - Constructed from 16-gauge steel. Can be installed with 3/4" or 1-1/2" lathing channel, 1/2" EMT, or with optional C-channel mounting bars (Part# BP31) ordered separately. Housing can be adjusted from the inside of the ceiling.

3. RETAINING SPRINGS - Precision tooled springs secure trim to mounting frame, for effortless and tool-less installation.

4. JUNCTION BOX - UL and ETL listed for through-branch circuit wiring and has four 1/2" KO's, one 3/4" KO and four Romex knockouts with pry-out slots and strain clamps. Junction Box is accessible from below, no tools required.

5. BALLAST - Ballast is accessible from below, no tools required. Ballast supplied is manufactured by Philips Advance, Universal Technologies or Lutron Electronics.

6. MOUNTING FRAME - Die-formed construction for maximum heat dissipation and rust protection.

OPTICS

7. REFLECTOR - Self-flanged .050" aluminum reflector with low iridescent finish. Reflector provides 45-degree lamp-to-reflector image cutoff.

8. LENS - Choice of either tempered clear, tempered prismatic or tempered frosted lens fastened with two torsion springs for easy re-lamping. ETL/UL listed for wet or damp location.

LISTING

ETL/UL listed for through-branch circuit wiring and damp locations. Wet location only with lens trims.



Energy Star Qualified Models:

- HH9X9SQPL-1X13-S-120
- HH9X9SQPL-1X18-S-120
- HH9X9SQPL-1X26-S-120

LAMP BASE GUIDE (Sockets will accept all designated lamp bases listed.)						
13W	18W	26W	32W	42W	57W	70W
G24q-1 GX24q-1	G24q-2 GX24q-2	G24q-3 GX24q-3 GX24q-4	GX24q-3 GX24q-4	GX24q-4	GX24q-5	GX24q-6

HH9X9SQPL - ITEM SELECTOR: (Please check the boxes below for the option desired)

WATTAGE	BALLAST	VOLTAGE	EMERGENCY OPTIONS	TRIM TYPE & DESCRIPTION	REFLECTOR
1 LAMP <input checked="" type="checkbox"/> 1X9 <input type="checkbox"/> 1X13 <input type="checkbox"/> 1X18 <input type="checkbox"/> 1X26 <input type="checkbox"/> 1X32 <input type="checkbox"/> 1X42 2 LAMPS <input type="checkbox"/> 2X9 <input type="checkbox"/> 2X13 <input type="checkbox"/> 2X18 <input type="checkbox"/> 2X26 <input type="checkbox"/> 2X32 <input type="checkbox"/> 2X42	<input checked="" type="checkbox"/> (E) Electronic <input type="checkbox"/> (S) Energy Star ² DIMMING <input type="checkbox"/> Mark 7 ³ <input type="checkbox"/> Mark 10 ⁴ <input type="checkbox"/> Lut-E (EC3D) ⁵	<input checked="" type="checkbox"/> MVOLT (120/277) <input type="checkbox"/> 120 <input type="checkbox"/> 277	<input type="checkbox"/> EMG 750 (750 Lumens) ⁶ <input type="checkbox"/> EMG 1300 (1300 Lumens) ⁶ <input type="checkbox"/> INTG 750 (750 Lumens) ⁷ <input type="checkbox"/> INTG 1300 (1300 Lumens) ⁷ <input type="checkbox"/> EMG-D-750 (750 Lumens) ⁸ <input type="checkbox"/> INTG-D-750 (750 Lumens) ⁹ <input type="checkbox"/> ICE-1300 (1300 Lumens) ¹⁰ OTHER OPTIONS <input type="checkbox"/> FUSE ¹¹ <input type="checkbox"/> RIF ¹² <input type="checkbox"/> BP31 (24" C-Channel Bar Hangers)	<input type="checkbox"/> 9601 <input type="checkbox"/> 9604 <input type="checkbox"/> 9614 <input type="checkbox"/> 9615 <input type="checkbox"/> 9608	<input type="checkbox"/> CL <input type="checkbox"/> SCH ** <input type="checkbox"/> SHZ ** <input type="checkbox"/> WT <input type="checkbox"/> W <input type="checkbox"/> MB

1- (M) Magnetic = Available in 9W, 13W, 18W & 26W fixtures only • **2- (S) Energy Star** = Available on selected fixtures only, please see list above • **3- MARK 7** = Not available in 9W, 13W, 57W, 70W • **4- MARK 10** = Not available in 9W, 13W, 57W, 70W, must specify voltage • **5- LUT-E (EC3D)** = Not available in 9W, 13W, 57W, 70W • **6- EMG** = Emergency battery pack w/ remote test switch • **7- INTG** = Emergency battery pack w/ integral (reflector) test switch • **8- EMG-D** = Emergency battery pack w/ remote test switch for damp location • **9- INTG-D** = Emergency battery pack w/ integral(reflector) test switch for damp location • **10- ICE** = Emergency battery pack w/ remote test switch operating between -18°C and 55°C • **11- FUSE** = Single slow-blow fuse • **12- RIF** = Radio interference filter • **13- ESD** = Emergency self-diagnostic

Specifications:

HH9X9SQPL - 1X9 - E - MVOLT - - - - -
 WATT BALLAST VOLTAGE EMERGENCY OPTIONS TRIM TYPE REFLECTOR RING

REFLECTOR	RING
CL Clear	WH Self-Flange White Standard on all trims
SHZ Satin Haze (Low Iridescent)	
WT Wheat	
MB Black	
W White	

*For custom baffle, reflector, trim ring, glass color and lens options, please consult factory.

Sample of Catalog Number: HH9X9SQPL-1X32-E-MVOLT-EMG750-9601-CL-WH



A division of
Elite Lighting

Submittal form is available @ www.maxilume.com
Tel: 323-888-1973 • Fax: 323-888-1977

Specifications and Dimensions subject to change without notice.

9" X 9" CFL Optics

Catalog Number:
HH9X9SQPL-1X9-E-MVOLT

Project Name:

Type:

Note:

MAXILUME
ARCHITECTURAL LIGHTING

9601-CL - Reflector



REFLECTOR FINISH:



RING FINISH:

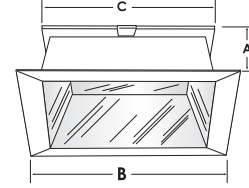

A = 3"
B = 10-3/8" X 10-3/8"
C = 9-1/8"

9604-CL - Reflector with Prismatic Glass Lens

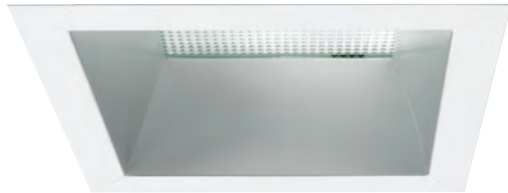

REFLECTOR FINISH:



RING FINISH:

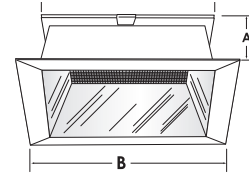

A = 3"
B = 10-3/8" X 10-3/8"
C = 9-1/8"

FOR
WET
LOCATION

9614-CL - Reflector with Frosted Glass Lens

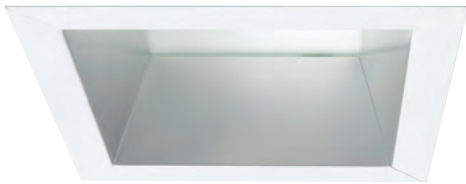

REFLECTOR FINISH:



RING FINISH:

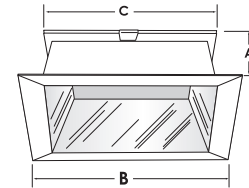

A = 3"
B = 10-3/8" X 10-3/8"
C = 9-1/8"

FOR
WET
LOCATION

9615-CL - Reflector with Tempered Glass Lens



REFLECTOR FINISH:



RING FINISH:

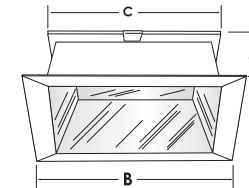

A = 3"
B = 10-3/8" X 10-3/8"
C = 9-1/8"

FOR
WET
LOCATION

9608-CL - Reflector with Crossblade



REFLECTOR FINISH:



RING FINISH:

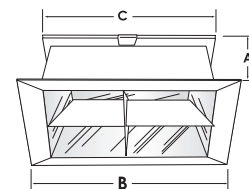

A = 3"
B = 10-3/8" X 10-3/8"
C = 9-1/8"

FOR
WET
LOCATION

WST/WSR/ WSQ



Intended Use

For building- and wall-mounted applications.

Features

Housing – Rugged, die-cast, single-piece housing. Die-cast door frame has 1/8" thick tempered glass lens. Door frame is fully gasketed with one-piece solid silicone. Standard finish is textured dark bronze (DDBT) corrosion-resistant polyester powder with other architectural colors available.

Optics – Interchangeable, segmented reflectors for superior uniformity and control. Three full cutoff distributions available: FT (forward throw), MD (medium throw) and WT (wide throw). Four uplight distributions available in WSR only: FTU (forward throw, 10% up), MDU (medium throw, 10% up), WTU (wide throw, 10% up) and MDU5 (up/down, medium throw, 50% up, 50% down). Compact fluorescent MD (medium throw) only.

Electrical – HID: 50W MH-150W utilizes a high reactance, high-power factor ballast. 35S and 50S utilizes a reactor normal-power factor ballast. 175W utilizes a constant-wattage auto

transformer ballast. Quick-disconnect plug easily disconnects reflector from ballast. Ballasts are copper wound and 100% factory tested. CFL: compact fluorescent ballast is Class P, electronic, high-power factor, <10% THD with starting temp. of 0° F (-18°C).

Socket - HID is porcelain, medium-base copper alloy, nickel-plated screw shell and center contact. (UL Listed 660W, 600V 4KV pulse rated). Fluorescent socket is high-temperature thermoplastic with integral lamp retention clip.

Installation – Universal mounting mechanism with integral mounting support allows fixture to hinge down. Bubble level provides correct alignment with each installation.

Listings

UL Listed suitable for wet locations (damp location listed in lens-up orientation). CSA Certified (see Options). IP65 rated.

Ordering Information

Example: **WST 175M FT 120 SF LPI**

Series	Wattage	Distribution	Voltage	Options/accessories	
WST Trapezoid	High pressure sodium	<u>Downlight distribution</u>	120	Installed	CRT Non-stick protective coating ¹⁴
WSR Half round	35S ¹	FT Forward throw	208 ⁴	SF Single fuse, 120V, 277V, 347V (n/a TB or TBV)	PE Photoelectric cell-button type (n/a TB or TBV) ¹⁶
WSQ Quartersphere	50S	MD Medium throw (coated lamp standard)	240 ⁴	DF Double fuse, 208V, 240V (n/a TB or TBV)	WLU Wet location door for up orientation
	70S	WT Wide throw	277	GMF Internal slow-blow fusing ^{8,9}	IBS Internal backlight shield ¹⁶
	100S	<u>Uplight distribution</u> ³	347	EC Emergency circuit (25W max., lamp included)	DFL Diffusing lens
	150S	FTU Forward throw with 10% uplight	TB ⁵	DC12 Emergency circuit 12 volt (35W lamp included standard) ¹⁰	LPI Lamp included
	<u>Metal halide</u>	MDU Medium throw with 10% uplight (coated lamp standard)	TB ⁶	2DC12 Emergency circuit 12 volt ((2) 35W lamps included standard) ¹⁰	L/LP Less lamp
	50M	WTU Wide throw with 10% uplight	MVOLT ⁷	DC2012 Emergency circuit 12 volt (20W lamp included standard) ¹⁰	UCS Uplight component shield ¹⁷
	70M	MDU5 Up/down medium throw with 50% uplight & 50% downlight (coated lamp standard)		2DC2012 Emergency circuit 12 volt ((2) 20W lamps included standard) ¹⁰	CSA CSA Certified
	100M			ELDW Emergency battery pack (120V or 277V only) ^{8,11}	<i>Architectural colors</i> ¹⁸
	150M			ELDWR Remote battery pack ready (by others) for compact fluorescent lamps ¹²	<i>Standard textured colors</i>
	175M			ELDWC Cold weather emergency battery pack (120V and 277V only) ^{8,20}	DDBT Dark bronze (std.)
	<u>Compact fluorescent</u> ²			QRS Quartz restrike system (100W max., lamp not included) ¹³	DSST Sandstone
	26DTT			CR Enhanced corrosion resistance	DNAT Natural aluminum
	2/26DTT				DWHG White
32TRT				DBLB Black	
2/32TRT				<i>Shipped separately</i>	
42TRT				WSBBW Surface-mounted back box ¹⁹	
2/42TRT				UT5 Uptilt 5 degrees ¹⁹	
				WSTWG Wire guard (WST) ¹⁵	
				WSTVG Vandal guard (WST) ¹⁵	
				WSRWG Wire guard (WSR and WSQ) ¹⁵	
				WSRVG Vandal guard (WSR and WSQ) ¹⁵	

WST

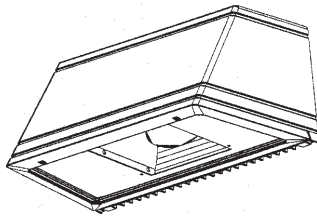

WSR

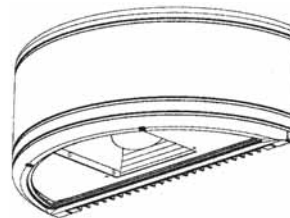

WSQ

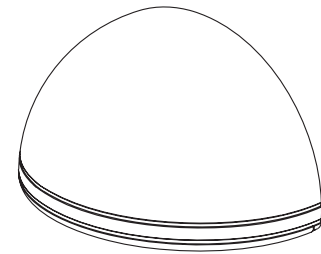

Dimensions are shown in inches (centimeters) unless otherwise noted.

	WST	WSR	WSQ
Width:	16-1/4(41.2)	18(45.7)	18(45.7)
Depth:	9-1/8(23.2)	9(22.8)	9(22.8)
Height:	7-1/4(18.4)	7-1/4(18.4)	9-3/8(23.8)
Max. weight:	30lbs(13.6kg)	30lbs(13.6kg)	30lbs(13.6kg)

NOTES:

- 1 120V only, NPF only
- 2 Only available with MD, MDU and MDU5 distributions.
- 3 Available on WSR fixture only.
- 4 Not available in Canada.
- 5 Optional multi-tap ballast (120V, 208V, 240V, 277V). In Canada 120V, 277V, 347V; ships as 120V/347V.
- 6 Optional 5-tap ballast (120V, 208V, 240V, 277V, 480V; n/a in Canada). 175M only.
- 7 Optional multi-volt electronic ballast (for compact fluorescent lamps only) capable of operating on any line voltage from 120V-277V.
- 8 Available for compact fluorescent units only.
- 9 Must specify volt, n/a MVOLT or TB.
- 10 Not available with SF, DF or QRS.
- 11 Not available with 2/32TRT or 2/42TRT.
- 12 Battery pack by others and mounted external to luminaire. Pilot light/test switch mounting plate included. Consult factory for availability.
- 13 Not available with compact fluorescent.
- 14 Black finish only.
- 15 Must be ordered with fixture; no field modifications.
- 16 IBS not available with MD, MDU and MDU5 distributions.
- 17 For WSR, inverted orientation, with FTU and WTU distributions only.
- 18 Additional architectural colors available; see www.lithonia.com.
- 19 Must specify finish.
- 20 -20°C to 55°C operation. N/A 2/26DTT, 2/32TRT, 2/42TRT, WSQ or WSR with uplight distribution.

Lamp/Fixture Data			
Wattage	Ballast	Lamp type	Base type
High pressure sodium (med/clear)			
35	RHPF	E17	medium
50	RHPF	E17	medium
70	HX-HPF	E17	medium
100	HX-HPF	E17	medium
150	HX-HPF	E17	medium
Metal halide (med/clear)			
50	HX-HPF	E17	medium
70	HX-HPF	E17	medium
100	HX-HPF	E17	medium
150	HX-HPF	E17	medium
175	CWA	E17	medium
Compact fluorescent (double twin-tube/triple-tube)			
26DTT	electronic, HPF	T4	G24Q-3
32TRT	electronic, HPF	T4	GX24Q-3
42TRT	electronic, HPF	T4	GX24Q-4



Consistent with LEED® goals & Green Globes™ criteria for light pollution reduction

Does not meet with uplight distribution options.

Type U



Our custom lighting, post lanterns and wall sconces are handcrafted in Austin, TX in contemporary, Southwestern, mission styles and more. Our architectural lighting, outdoor lighting, media room, church lighting and night lights are sure to please. We use copper, stainless steel, art glass, mica, other materials. Custom orders encouraged! We design and handcraft unique lighting - No order too large or too small. Budget, time and detail oriented.



Home » Architectural Lighting » 102

My Account | Cart Contents | Checkout

- SCONCES/LIGHTING**
- ▶ Contemporary Sconces
 - ▶ Architectural Lighting
 - ▶ Post Lanterns
 - ▶ Southwest Sconces
 - ▶ Mission Wall Sconces
 - ▶ House Numbers
 - ▶ Ceiling Fixtures
 - ▶ Media Room Lighting
 - ▶ Night Lights
 - ▶ Mail Boxes
 - ▶ Bargain Basement
 - ▶ Coe Studios Lighting

Slat Wall Sconce

This is a shopping center we furnished sconces for in Houston, TX. The owner chose one of our more popular metal and glass wall sconces. Those shown are 35" x 15" x 6".

They provides a good amount of light, without much glare because I have placed the bulbs behind the slats. The Slat Wall Sconce is a great exterior light fixture.

See this link also: <http://www.lightcrafters.com/slat-wall-sconce-p-5.html>



Click to enlarge

- Small 6" x 12.5" x 4.5"
- Medium 9" x 17.5" x 4.5"
- Large 10" x 21" x 4.5"
- XL 11" x 24.5" x 5"
- XXL 15" x 35" x 6"

Custom Sizes Welcome - Call for Details

View All Products

Testimonials

Hello, We received the 2 copper sconces with squiggles on them (#601) for our new eye care practi...
Read more...
Progressive Eyecare Center - Portage, MI

Information

Links
Contact Us
Shipping
Returns
Site Security
Map to Shop

Currently Looking

Visitors: 10
Members: 0

Shopping Cart

0 items

Best Sellers

01. Slat Wall Sconce
02. Double roofed post lantern
03. Solid Bronze Footlight
04. Translucent Cone

Reviews

Kent, As I stated in my email to you, these lights are AMA...
★★★★★

Tell a Friend

Tell a Friend

Tell someone you know about this product.

Notifications

Notify me of updates to **Slat Wall Sconce**

Available Options:

1. Size:	Medium (+\$185.00)
2. Clear lens for wet location:	<input checked="" type="checkbox"/> (+\$15.00)
3. Finish:	<div style="display: flex; justify-content: space-around;"> <div style="text-align: center;"> Antique Copper</div> <div style="text-align: center;"> Mottled Copper</div> <div style="text-align: center;"> Brushed Galvanized</div> <div style="text-align: center;"> Pewter Galvanized</div> <div style="text-align: center;"> Dark antique copper</div> <div style="text-align: center;"> Stainless Steel (+\$45.00)</div> </div>
Dawn to Dusk Sensor:	<input type="checkbox"/> (+\$20.00)
Diffuser:	<div style="display: flex; justify-content: space-around;"> <div style="text-align: center;"> mica</div> <div style="text-align: center;"> amber iridescent glass</div> <div style="text-align: center;"> white glass</div> <div style="text-align: center;"> seeded glass</div> <div style="text-align: center;"> frosted glass</div> <div style="text-align: center;"> beige wispy glass</div> </div> <div style="display: flex; justify-content: space-around; margin-top: 10px;"> <div style="text-align: center;"> black frit & streamers (+\$25.00)</div> <div style="text-align: center;"> NONE - customer supplies their own diffuser (-\$20.00)</div> <div style="text-align: center;"> water glass</div> </div>

[Write Review](#)

[Add to Cart](#)

★★★★★ – *Georganne Fultz, 07/19/2010*
Kent, As I stated in my email to you, these lights are AMAZING! The quality of craftsmanship exceeded our expectations. Our home is reaching completion, and we cannot wait to see them installed. Thanks again for the friendly, prompt service. We will definately be doing business with you in the future!! Georganne Fultz Bremerton,WA

★★★★★ – *daniel lowe, 01/30/2009*
Kent--these lights are fantastic!! such workmanship! they look great at the front door and over the garage. thank you, thank you, thank you

Displaying 1 to 2 (of 2 reviews)

Customers who bought this product also purchased

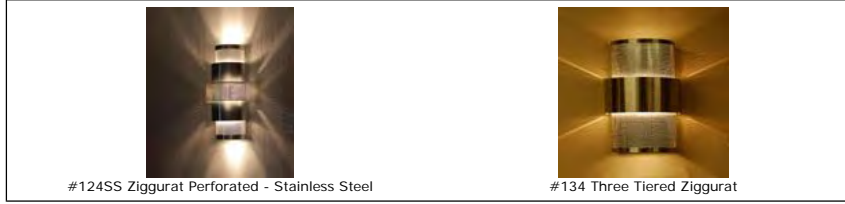

Wednesday 15 June, 2011

3824098 requests since Saturday 25 October, 2003



copyright © 2000 - 2008 Lightcrafters™ All rights reserved.
9603 Saunders Ln. #D-1
Austin, TX 78758
512 458-5406



**HI-LITE MFG.
CO., INC**

13450 Monte Vista Avenue
Chino, California 91710
Telephone: (909) 485-1888
Toll Free: (800) 485-0211
Fax: (909) 485-0807
www.hilltamfg.com

Job Name:
Type:
Quantity:

Type V arm

B-2

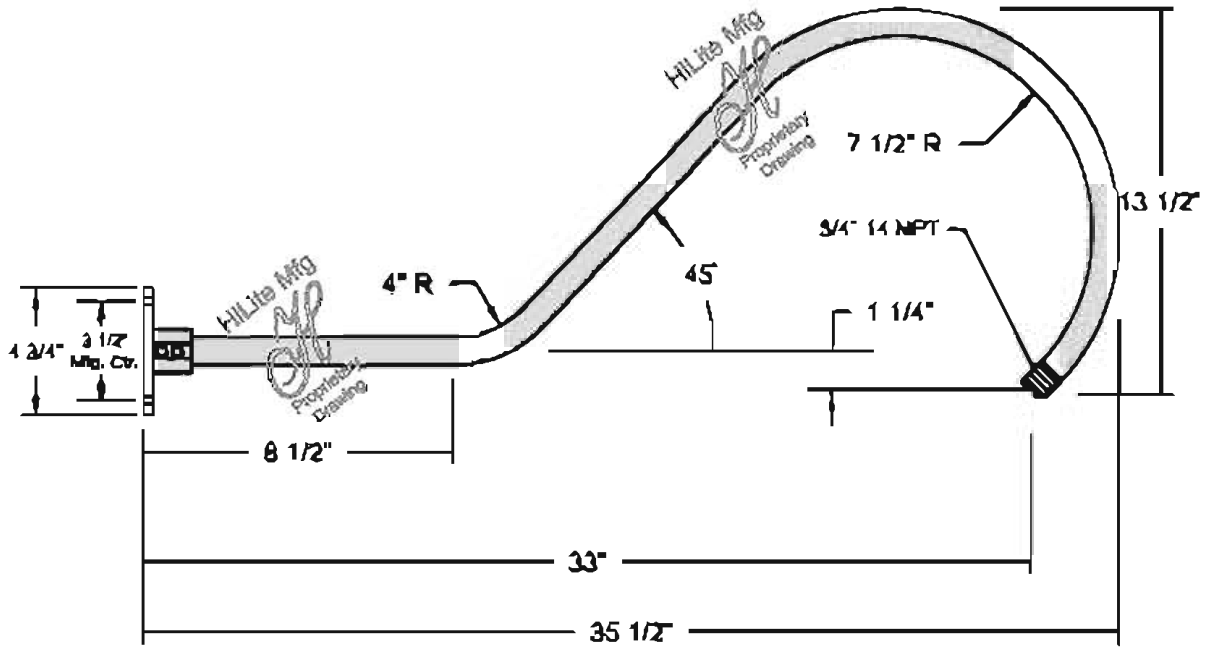



HI-LITE MFG.

CO., INC.

13450 Monte Vista Avenue
Chino, California 91710
Telephone: (909) 485-1999
Fax: (909) 485-0807

Job Name: _____
Type: _____
Quantity: _____

Angle Shade Collection

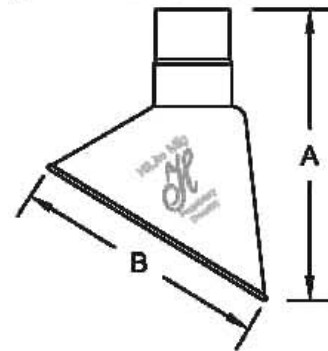

Type V shade

Item Number	Height (A)	Width (B)
H-18107	8"	7"
H-18110	10-1/2"	10"
H-18112	12"	12"
H-18114	14-1/2"	14"

Fixture No.	Fixture Color	Mounting	Mounting Color	Optional Accessories	Accessory Color	Wattage/Lamp options	Ballast	Voltage
H-18107 ⁽¹⁾ H-18110 ⁽¹⁾ H-18112 H-18114	Standard ⁽²⁾ 91 (Black) 93 (White) 95 (Dk. Grm) 98 (Galv.) BR47 (Rust) For all finishes see pages 344-348.	Mounting Options 1/2" 3/4" Stem Options (Stem 1/2") ST Specify length and canopy. HBC (Canopy) BMC (Canopy) Flush Mount Options FHSC FSMC Arm Options B-1 HL-K HL-A HL-U HL-H P-1 HL-C P-3 HL-D For all arms and specs see pages 321-344.	Standard 91 (Black) 93 (White) 95 (Dk. Grm) 98 (Galv.) BR47 (Rust) For all finishes see pages 344-348.	CGU (Cast guard & glass) LCGU (Large cast guard & glass) WGU (Wire guard & glass) LWGU (Large wire guard & glass) ARN (Acorn globe) LARN (Large acorn globe) WGR (Wire guard) BK (Swivel knuckle) For specs and glass color see pages 321-344.	Standard 91 (Black) 93 (White) 95 (Dk. Grm) 98 (Galv.) BR47 (Rust) For all finishes see pages 344-348.	Incandescent (Fixture is standard 200W. Do not specify) CFL ⁽³⁾ (Compact Fluorescent) 13/CFL 18/CFL 26/32/42/CFL 33/CFL 42/CFL 57/CFL DMB (Dimmable Ballast for CFL. Add to Part No.) HID ⁽³⁾ (High Intensity Discharge) MH ⁽³⁾ (Metal Halide) 35/MH 50/MH 70/MH 100/MH 150/MH 175/MH HPS ⁽³⁾ (High Pressure Sodium) 50/HPS 70/HPS 100/HPS 150/HPS	Ballast option not available for INC. RB ⁽⁴⁾ (Remote) BCM (Canopy Mount) PLB ⁽⁵⁾ (Postline) For specs see pages 341-343.	Incandescent (Fixture is standard 120V. Do not specify.) CFL M (Multi 120/277V) HID RB and BCM M (Multi 120/208/240/277V) PLB 1 (120V) 2 (277V)

H-18110 - 91 / 1/2" - 91 / CGU-CLR - 91 / 13/CFL - BCM - M

ORDER EXAMPLE
(USE THIS FORMAT TO PLACE ORDER)

Notes:

- (1) H-18107 not available with glass enclosures.
H-18107 available for 200W Max INC, 32W Max CFL and 100W Max HID.
H-18110 not available with LWGU, LCGU, ARN or LARN.
- (2) For interior finish of fixture refer to color chart on pages 344-348.
- (3) Requires Globe Option. (See pages 338-341 for Globe Options)
Max Wattages for CGU and WGU are
100W INC, 32W CFL and 100W HID.
Max Wattages for LWGU, LCGU, ARN and LARN are
200W INC, 57W CFL and 175W HID.
- (4) (RB) Remote Ballast not available for Fluorescent Lamping.
- (5) (PLB) Post Line Ballast must specify 120V or 277V.
(PLB) 50W MH requires a 3" dia. pole.
(PLB) 70W and 100W MH require a 4" dia. pole.
(PLB) 60W, 70W, 100W and 150W HPS require a 3" dia. pole.

Suitable for wet location.

PRODUCT SPECIFICATIONS

Optics

Reflector: Cascading Vector optical design ensures a 50° visual cut-off to both lamp and lamp image • Low iridescent specular or satin Alzak® .050" thick reflector in clear, gold, wheat, pewter, bronze or black with integral flange of same finish; other finishes available upon request • Painted white flange is optional

Baffle: Specular clear Alzak® upper reflector and white or black painted deep multi-groove aluminum baffle insert with integral flange painted white

Electrical

Ballast: 120/277 Volt dual tap primary core and coil, high power factor, insulation class "H" 180°C, reliable starting to -30°C. Includes capacitor and igniter (where required)

Lamp Holder: Medium base heavy duty 4Kv porcelain socket with nickel plated brass screw shell in die-cast socket housing

Socket Cap: Die-cast aluminum socket cup optimizes lamp performance and securely fastens to reflector with stabilizing ribs to prevent rocking

Mechanical

Mounting Frame: 16-gauge galvanized steel mounting ring with factory installed spring steel friction clips • Accommodates ceilings up to 3/4" thick; ceiling thickness adapter accessory is available for ceilings up to 2" • Common rough-in section accepts open and single wall wash reflectors

Mounting Bracket: Mounting brackets have 3" vertical adjustment and accept proprietary Tru-Lock bar hangers, 1 1/2" C-channel and flat linear bars (ordered as accessories) or 1/2" EMT, 3/4" and 1 1/2" lathing channel (by others) • One-piece Tru-Lock bar hangers have integral T-bar locking screws and alignment notches for locating and locking fixture in the center or 1/4 tile increments

Junction Box: Ballast mounted to J-box cover for optimal heat dissipation and serviceability from below the ceiling • Oversized 4"x 6" galvanized steel junction box with (6) 1/2" and (1) 3/4" knockouts facilitate quick wiring • Junction box rated for eight No. 12 AWG 90°C branch circuit conductors (4-in, 4-out)

Labels and Listings

UL/C-UL listed for feed through and damp locations • I.B.E.W. Union made

Product specifications subject to change without notice.

ENGINEERING DATA

Voltage	120V-HPF	277V-HPF	347V-HPF Canada
Lamp Wattage	39M	39M	39M
Total input power	56W	56W	-
Operating AMPS	0.60	0.30	-
ANSI Code	M130	M130	M130

4" PAR20 VERTICAL METAL HALIDE DOWNLIGHT

OPEN APERTURE

39W PAR20

M4-P20-39M

MAGNETIC BALLAST
MP400-P20, P400B-P20

Type	Cat. No.
_____	_____
Project:	_____
Notes:	_____

DIMENSIONS

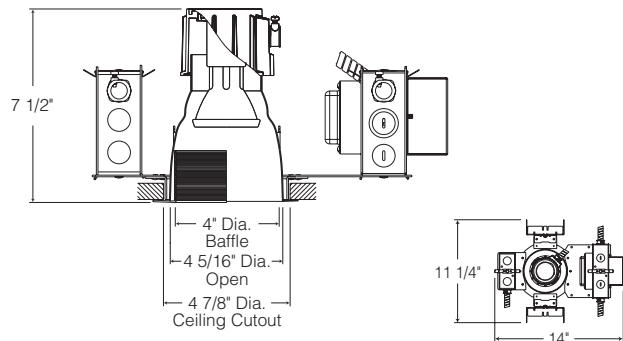

ORDERING INFORMATION: Rough-in, reflector and accessories each ordered separately.

Example: M4-P20-39M			Example: MP400-P20-CL				Example: HB-TL
Rough-In	Wattage/Lamp	Options	Reflector	Color Options	Finish	Options	Accessories
M4-P20-	39M-	_____	_____	_____	_____	_____	_____
M4-P20	39M 39W PAR20 MH, 120/277V Magnetic	347 347 Volt ***F Fuse and Fuse Holder (Where *** = voltage) CP Chicago Plenum FCAN FCAN Ballast in lieu of core and coil (Includes HB-TL bar hangers)	MP400-P20 Open Reflector P400B-P20 Baffle	C Clear G Gold WT Wheat PT Pewter BZ Bronze B Black W White	Low Iridescent Alzak® Finishes: L Specular S Satin Blank for baffle & white	WH White Flange	HB-TL 25" Tru-Lock grid ceiling bar hangers, Pair HB-52 52" C-Channel Bar Hangers, Pair HB-28 28" C-Channel Bar Hangers, Pair LB-27 27" Linear Bar Hangers, Pair SCA4-* Sloped Ceiling Adapter *Angle must be specified when ordering; Available in 5°, 10°, 15°, 20°, 25°, 30° Example: SCA4-20

**OPEN REFLECTOR
(39W PAR20/WIDE FLOOD)**

Catalog Number: M4-P20-39M (MP400-P20-CL)

PHOTOMETRIC REPORT

Test Number: PT05063101

Total Luminaire Efficiency: 93.8%

Luminaire Spacing Criteria: 0.46

Luminaire: Clear specular Alzak® reflector. Open bottom.

Lamps: One OSI HCIPAR20/39W/WFL, rated at 2000 lumens.

CIE-Type: Direct

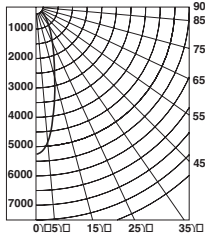

Candlepower Distribution (Candelas)

Angle	Candela	Lumens
0°	5270	
5°	4809	459
15°	2366	671
25°	1020	472
35°	322	202
45°	77	60
55°	14	13
65°	0	0
75°	0	0
85°	0	0

Initial Footcandles

Distance to Illuminated Plane (Feet)	Footcandles Beam Center	Footcandles Beam Edge	Beam Diameter
6'	146.4	67.2	2.9'
7'	107.6	49.4	3.4'
8'	82.3	37.8	3.9'
9'	65.1	29.9	4.3'
10'	52.7	24.2	4.8'
11'	43.6	20.0	5.3'
12'	36.6	16.8	5.8'
13'	31.2	14.3	6.3'
14'	26.9	12.3	6.8'
15'	23.4	10.8	7.2'

Luminaire Data

Ang in Deg	Footlamberts	Candela/M ²
45	3279	11236
55	746	2555
65	0	0
75	0	0
85	0	0

Zonal Lumen Summary

Zone	Lumens	%Lamp	%Fixture
0-30°	1602	80.1	85.4
0-40°	1804	90.2	96.1
0-60°	1876	93.8	100.0
0-90°	1876	93.8	100.0
90-180°	0	0.0	0.0
0-180°	1876	93.8	100.0

AVERAGE INITIAL FOOTCANDLES

Reflectances: 80% Ceiling, 50% Walls, 30% Floors

Luminaire Spacing	Room Cavity Ratio		
	RCR1	RCR4	RCR8
5' x 5'	84	71	59
6' x 6'	58	49	41
7' x 7'	43	36	30
8' x 8'	33	28	23
9' x 9'	26	22	18
10' x 10'	21	18	15
11' x 11'	17	15	12
12' x 12'	15	12	10

COEFFICIENTS OF UTILIZATION - % (Zonal Cavity Method)

Effective Floor Reflectance 20%

PCC	80		70		50		30		10		0							
PW	70	50	30	10	70	50	30	10	50	30	10	0						
0	112	112	112	112	109	109	109	109	104	104	100	96	96	96	95			
1	107	105	103	101	105	103	101	100	99	98	97	96	95	94	93	92	91	90
2	103	99	96	93	101	98	95	92	95	92	90	92	90	88	89	88	86	85
3	99	94	90	87	97	93	89	86	90	87	85	88	86	83	86	84	82	81
4	95	89	85	81	93	88	84	81	86	83	80	84	82	79	83	80	78	77
5	91	85	80	77	90	84	80	77	82	79	76	81	78	75	80	77	75	73
6	88	81	76	73	87	80	76	73	79	75	72	78	74	72	77	74	71	70
7	85	77	73	70	84	77	72	69	76	72	69	75	71	69	74	71	68	67
8	82	74	70	66	81	74	69	66	73	69	66	72	68	66	71	68	66	64
9	79	71	67	64	78	71	66	64	70	66	63	69	66	63	69	65	63	62
10	76	69	64	61	75	68	64	61	67	64	61	67	63	61	66	63	61	60

**OPEN BAFFLE
(39W PAR20/WIDE FLOOD)**

Catalog Number: M4-P20-39M (P400B-P20-B)

PHOTOMETRIC REPORT

Test Number: PT05063102

Total Luminaire Efficiency: 73.7%

Luminaire Spacing Criteria: 0.46

Luminaire: Clear specular Alzak® upper reflector with black baffle lower cone. Open bottom.

Lamps: One OSI HCIPAR20/39W/WFL, rated at 2000 lumens.

CIE-Type: Direct

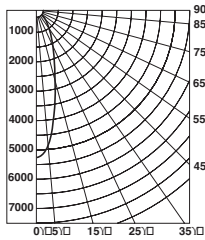

Candlepower Distribution (Candelas)

Angle	Candela	Lumens
0°	5271	
5°	4809	459
15°	2356	668
25°	483	224
35°	158	99
45°	25	19
55°	6	6
65°	0	0
75°	0	0
85°	0	0

Initial Footcandles

Distance to Illuminated Plane (Feet)	Footcandles Beam Center	Footcandles Beam Edge	Beam Diameter
6'	146.4	67.3	2.9'
7'	107.6	49.4	3.4'
8'	82.4	37.8	3.9'
9'	65.1	29.9	4.3'
10'	52.7	24.2	4.8'
11'	43.6	20.0	5.3'
12'	36.6	16.8	5.8'
13'	31.2	14.3	6.3'
14'	26.9	12.4	6.7'
15'	23.4	10.8	7.2'

Luminaire Data

Ang in Deg	Footlamberts	Candela/M ²
45	1355	4641
55	432	1479
65	0	0
75	0	0
85	0	0

Zonal Lumen Summary

Zone	Lumens	%Lamp	%Fixture
0-30°	1350	67.5	91.6
0-40°	1450	72.5	98.3
0-60°	1475	73.7	100.0
0-90°	1475	73.7	100.0
90-180°	0	0.0	0.0
0-180°	1475	73.7	100.0

AVERAGE INITIAL FOOTCANDLES

Reflectances: 80% Ceiling, 50% Walls, 30% Floors

Luminaire Spacing	Room Cavity Ratio		
	RCR1	RCR4	RCR8
5' x 5'	66	58	50
6' x 6'	46	40	34
7' x 7'	34	29	25
8' x 8'	26	23	19
9' x 9'	20	18	15
10' x 10'	17	14	12
11' x 11'	14	12	10
12' x 12'	12	10	9

COEFFICIENTS OF UTILIZATION - % (Zonal Cavity Method)

Effective Floor Reflectance 20%

PCC	80		70		50		30		10		0							
PW	70	50	30	10	70	50	30	10	50	30	10	0						
0	88	88	88	88	86	86	86	86	82	82	78	78	78	75	75	75	74	
1	85	83	82	80	83	82	80	79	79	78	77	76	75	74	73	73	72	71
2	82	79	77	75	80	78	76	74	75	74	72	73	72	71	71	70	69	68
3	79	75	73	70	78	74	72	70	73	71	69	71	69	68	69	68	67	66
4	76	72	69	67	75	71	69	66	70	68	66	69	67	65	67	66	64	63
5	74	69	66	64	73	69	66	64	68	65	63	66	64	63	65	64	62	61
6	72	67	64	61	71	66	63	61	65	63	61	64	62	60	63	61	60	59
7	69	64	61	59	69	64	61	59	63	60	58	62	60	58	62	60	58	57
8	67	62	59	57	67	62	59	57	61	58	57	61	58	56	60	58	56	55
9	65	60	57	55	65	60	57	55	59	57	55	59	56	55	58	56	54	54
10	64	58	55	53	63	58	55	53	58	55	53	57	55	53	57	54	53	52



indy™

1300 S. Wolf Road • Des Plaines, IL 60018 • Phone (800) 367-5866 • Fax (888) 708-6578

Visit us at www.junolightinggroup.com

Printed in U.S.A. ©2016 Acuity Brands Lighting, Inc.

PRODUCT SPECIFICATIONS

Optics

Reflector: Precision reflector with 50° visual cut-off to both lamp and lamp image • Single position optics eliminate possibility of specified lamp being installed in incorrect position • Low iridescent specular or satin Alzak® .050" thick reflector in clear, gold, wheat, pewter or bronze with integral flange of same finish; other finishes available upon request • Painted white flange is optional

Baffle: Specular clear Alzak® upper reflector and white or black painted deep multi-groove aluminum baffle insert with integral flange painted white

Electrical

Ballast: Class "P" thermally protected 120V-277V universal voltage high power factor electronic ballast with end of life protection

Lamp Holder: 4-pin GX24q3 UV stabilized thermoplastic socket with non-fatiguing stainless steel lamp retention spring

Socket Cap: Vented die-cast aluminum socket cup optimizes lamp performance and securely fastens to reflector with stabilizing ribs to prevent rocking

Mechanical

Mounting Frame: 16-gauge galvanized steel mounting ring with factory installed spring steel friction clips • Accommodates ceilings up to 3/4" thick; ceiling thickness adapter accessory is available for ceilings up to 2" • Common rough-in section accepts open, single wall wash and lensed reflectors

Mounting Bracket: Mounting brackets have 3" vertical adjustment and accept proprietary Tru-Lock bar hangers, 1 1/2" C-channel and flat linear bars (ordered as accessories) or 1/2" EMT, 3/4" and 1 1/2" lathing channel (by others) • One-piece Tru-Lock bar hangers have integral T-bar locking screws and alignment notches for locating and locking fixture in the center or 1/4 tile increments

Junction Box: Ballast mounted to J-box cover for optimal heat dissipation and serviceability from below the ceiling • Oversized 4"x 6" galvanized steel junction box with (6) 1/2" and (1) 3/4" knockouts facilitate quick wiring • Junction box rated for eight No. 12 AWG 90°C branch circuit conductors (4-in, 4-out)

Labels and Listings

UL/C-UL listed for feed through and damp locations • I.B.E.W. Union made

Product specifications subject to change without notice.

ENGINEERING DATA

Voltage	120V-HPF		277V-HPF		347V-HPF Canada	
Lamp Wattage	26W	32W	26W	32W	26W	32W
Total input power	27W	36W	27W	36W	31W	36W
Operating AMPS	0.23	0.31	0.10	0.13	0.09	0.11
Ballast factor	1.00	0.98	1.00	0.98	1.02	0.98

6" VERTICAL CFL DOWNLIGHT
OPEN APERTURE

One 26W or 32W Triple Tube

C6V-126/42T

C600, C600B

Type	Cat. No.
_____	_____
_____	_____
Project:	_____
Notes:	_____

DIMENSIONS

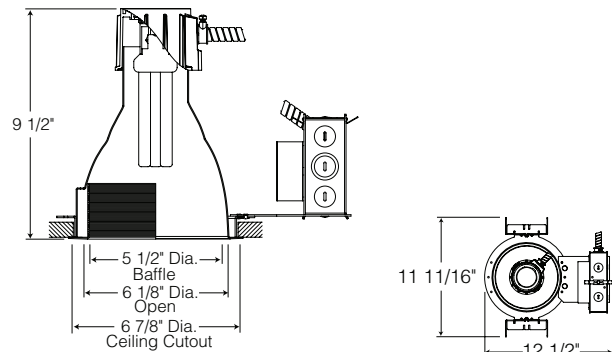

ORDERING INFORMATION: Rough-in, reflector and accessories each ordered separately.

Example: C6V-126/42T-BR			Example: C600-CL				Example: HB-TL
Rough-In	Wattage/Lamp	Options	Reflector	Color Options	Finish	Options	Accessories
C6V-	126/42T-						
C6V	126/42T 1x26W or 32W Triple, 4-pin	347 347 Volt BR Emergency Battery Back-up w/Remote Switch BN Emergency Battery Back-up w/Integral Test Switch HR High-Lumen Emergency Battery Back-up with Remote Switch HN High-Lumen Emergency Battery Back-up with Integral Test Switch D10 ¹ Dimming Ballast Advance Mark 10™ D7 Dimming Ballast Advance Mark 7™ DL ^{1,2} Dimming Ballast Lutron Compact SE ***F Fuse and Fuse Holder (Where *** = voltage) CP Chicago Plenum NV Non-vented Socket Cup	C600 Open Reflector C600B Baffle	C Clear G Gold WT Wheat PT Pewter BZ Bronze B Black W White	Low Iridescent Alzak® Finishes: L Specular S Satin Blank for baffle & white	WH White Flange MAX## Label for maximum wattage (where ## = wattage) BN Hole for emergency test switch	HB-TL 25" Tru-Lock grid ceiling bar hangers, Pair HB-52 52" C-Channel Bar Hangers, Pair HB-28 28" C-Channel Bar Hangers, Pair LB-27 27" Linear Bar Hangers, Pair HB-4 Bar Hanger conversion kit for wooden joists SCA6- ² Sloped Ceiling Adapter *Angle must be specified when ordering; Available in 5°, 10°, 15°, 20°, 25°, 30° Example: SCA6-20

¹ Add a -1 for 120V, a -2 for 277V
² Lutron Dimming Ballast is wattage specific.
 26W/120V = C6V-126T-DL-1
 26W/277V = C6V-126T-DL-2
 32W/120V = C6V-132T-DL-1
 32W/277V = C6V-132T-DL-2



1300 South Wolf Road • Des Plaines, Illinois 60018
 PHONE 800-367-5866 • FAX 888-708-6578
 www.junolightinggroup.com

OPEN REFLECTOR (32W TRIPLE TUBE)

Catalog Number: C6V-126/42T (C600-CL)
PHOTOMETRIC REPORT
Test Number: PRO3060601
Total Luminaire Efficiency: 50.1%
Luminaire Spacing Criteria: 0.87
Luminaire: Clear specular Alzak® reflector. Open bottom.
Lamps: One OSI CF32DT/E/IN/830, rated at 2450 lumens.
CIE-Type: Direct

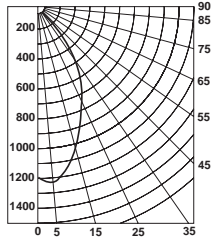

Candlepower Distribution (Candelas)

Angle	Candela	Lumens
0°	1188	
5°	1223	117
15°	999	283
25°	722	334
35°	496	311
45°	198	153
55°	3	2
65°	0	0
75°	2	2
85°	0	0

Initial Footcandles

Distance to Illuminated Plane (Feet)	Footcandles Beam Center	Footcandles Beam Edge	Beam Diameter
6'	33.0	10.9	7.0'
7'	24.2	8.0	8.2'
8'	18.6	6.2	9.3'
9'	14.7	4.9	10.5'
10'	11.9	3.9	11.7'
11'	9.8	3.3	12.8'
12'	8.3	2.7	14.0'
13'	7.0	2.3	15.2'
14'	6.1	2.0	16.3'
15'	5.3	1.8	17.5'

Luminaire Data

Ang in Deg	Footlamberts	Candela/M ²
45	4477	15341
55	71	244
65	0	0
75	137	469
85	0	0

Zonal Lumen Summary

Zone	Lumens	%Lamp	%Fixture
0-30°	734	30.6	61.0
0-40°	1046	43.6	86.9
0-60°	1201	50.0	99.8
0-90°	1203	50.1	100.0
90-180°	0	0.0	0.0
0-180°	1203	50.1	100.0

AVERAGE INITIAL FOOTCANDLES

Reflectances: 80% Ceiling, 50% Walls, 30% Floors

Luminaire Spacing	Room Cavity Ratio			
	RCR1	RCR4	RCR8	
5' x 5'	53	42	33	
6' x 6'	37	29	23	
7' x 7'	27	22	17	
8' x 8'	21	17	13	
9' x 9'	16	13	10	
10' x 10'	13	11	8	
11' x 11'	11	9	7	
12' x 12'	9	7	6	

COEFFICIENTS OF UTILIZATION - % (Zonal Cavity Method)

Effective Floor Reflectance 20%

PCC	80		70		50		30		10		0							
	PW	70	50	30	10	70	50	30	10	50	30	10	0					
0	60	60	60	60	58	58	58	58	56	56	56	53	53	53	51	51	51	50
1	57	55	54	53	56	54	53	52	52	51	50	50	50	49	49	48	48	47
2	54	51	49	47	53	50	48	47	49	47	46	47	46	45	46	45	44	43
3	51	48	45	43	50	47	44	42	45	43	42	44	43	41	43	42	40	40
4	48	44	41	39	47	44	41	39	42	40	38	41	39	38	40	39	37	37
5	45	41	38	36	45	41	38	36	40	37	35	39	37	35	38	36	35	34
6	43	38	35	33	42	38	35	33	37	34	33	36	34	32	36	34	32	31
7	41	36	33	30	40	35	32	30	35	32	30	34	32	30	34	31	30	29
8	39	34	30	28	38	33	30	28	33	30	28	32	30	28	32	29	28	27
9	37	31	28	26	36	31	28	26	31	28	26	30	28	26	30	28	26	25
10	35	30	27	24	34	29	26	24	29	26	24	29	26	24	28	26	24	24

OPEN BAFFLE (32W TRIPLE TUBE)

Catalog Number: C6V-126/42T (C600B-B)
PHOTOMETRIC REPORT
Test Number: PRO5060901
Total Luminaire Efficiency: 34.4%
Luminaire Spacing Criteria: 0.82
Luminaire: Clear specular Alzak® upper reflector with black baffle lower cone. Open bottom.
Lamps: One OSI CF32DT/E/IN/830, rated at 2400 lumens.
CIE-Type: Direct

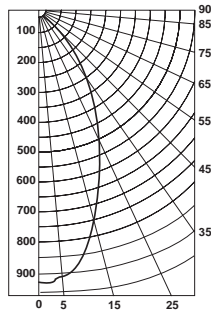

Candlepower Distribution (Candelas)

Angle	Candela	Lumens
0°	932	
5°	925	88
15°	758	215
25°	519	240
35°	311	195
45°	101	78
55°	2	2
65°	0	0
75°	3	3
85°	3	4

Initial Footcandles

Distance to Illuminated Plane (Feet)	Footcandles Beam Center	Footcandles Beam Edge	Beam Diameter
6'	25.9	9.2	6.2'
7'	19.0	6.8	7.2'
8'	14.6	5.2	8.3'
9'	11.5	4.1	9.3'
10'	9.3	3.3	10.3'
11'	7.7	2.7	11.4'
12'	6.5	2.3	12.4'
13'	5.5	2.0	13.5'
14'	4.8	1.7	14.5'
15'	4.1	1.5	15.5'

Luminaire Data

Ang in Deg	Footlamberts	Candela/M ²
45	2280	7813
55	60	206
65	0	0
75	165	566
85	642	2200

Zonal Lumen Summary

Zone	Lumens	%Lamp	%Fixture
0-30°	544	22.6	65.8
0-40°	739	30.8	89.5
0-60°	819	34.1	99.2
0-90°	826	34.4	100.0
90-180°	0	0.0	0.0
0-180°	826	34.4	100.0

AVERAGE INITIAL FOOTCANDLES

Reflectances: 80% Ceiling, 50% Walls, 30% Floors

Luminaire Spacing	Room Cavity Ratio			
	RCR1	RCR4	RCR8	
5' x 5'	36	30	23	
6' x 6'	25	21	16	
7' x 7'	19	15	12	
8' x 8'	14	12	9	
9' x 9'	11	9	7	
10' x 10'	9	7	6	
11' x 11'	8	6	5	
12' x 12'	6	5	4	

COEFFICIENTS OF UTILIZATION - % (Zonal Cavity Method)

Effective Floor Reflectance 20%

PCC	80		70		50		30		10		0							
	PW	70	50	30	10	70	50	30	10	50	30	10	0					
0	41	41	41	41	40	40	40	40	38	38	38	37	37	37	35	35	35	34
1	39	38	37	36	38	37	36	36	36	35	35	35	34	34	33	33	33	32
2	37	35	34	33	36	35	33	32	34	32	32	32	31	31	32	31	30	30
3	35	33	31	30	34	32	31	29	31	30	29	31	29	28	30	29	28	27
4	33	31	29	27	33	30	28	27	29	28	27	29	27	26	28	27	26	25
5	31	29	26	25	31	28	26	25	28	26	25	27	26	24	26	25	24	24
6	30	27	25	23	29	26	24	23	26	24	23	25	24	23	25	24	23	22
7	28	25	23	21	28	25	23	21	24	23	21	24	22	21	24	22	21	21
8	27	24	21	20	26	23	21	20	23	21	20	23	21	20	22	21	20	19
9	26	22	20	19	25	22	20	19	22	20	19	21	20	19	21	20	18	18
10	24	21	19	18	24	21	19	18	21	19	17	20	19	17	20	18	17	17

OPEN REFLECTOR (26W TRIPLE TUBE)

Catalog Number: C6V-126/42T (C600-CL)
PHOTOMETRIC REPORT
Test Number: PRO3060101
Total Luminaire Efficiency: 58.9%
Luminaire Spacing Criteria: 0.84
Luminaire: Clear specular Alzak® reflector. Open bottom.
Lamps: One OSI CF26DT/E/IN/830, rated at 1800 lumens.
CIE-Type: Direct

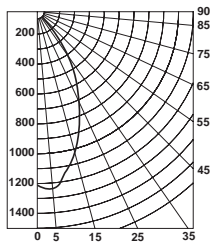

Candlepower Distribution (Candelas)

Angle	Candela	Lumens
0°	1212	
5°	1226	117
15°	1019	289
25°	690	320
35°	371	233
45°	132	102
55°	0	0
65°	0	0
75°	0	0
85°	0	0

Initial Footcandles

Distance to Illuminated Plane (Feet)	Footcandles Beam Center	Footcandles Beam Edge	Beam Diameter
6'	33.7	11.9	6.2'
7'	24.7	8.8	7.3'
8'	18.9	6.7	8.3'
9'	15.0	5.3	9.4'
10'	12.1	4.3	10.4'
11'	10.0	3.6	11.4'
12'	8.4	3.0	12.5'
13'	7.2	2.5	13.5'
14'	6.2	2.2	14.6'
15'	5.4	1.9	15.6'

Luminaire Data

Ang in Deg	Footlamberts	Candela/M ²
45	2989	10240
55	0	0
65	0	0
75	0	0
85	0	0

Zonal Lumen Summary

Zone	Lumens	%Lamp	%Fixture
0-30°	725	40.3	68.4
0-40°	959	53.3	90.4
0-60°	1061	58.9	100.0
0-90°	1061	58.9	100.0
90-180°	0	0.00	0.00
0-180°	1061	58.9	100.0

AVERAGE INITIAL FOOTCANDLES

Reflectances: 80% Ceiling, 50% Walls, 30% Floors

Luminaire Spacing	Room Cavity Ratio			
	RCR1	RCR4	RCR8	
5' x 5'	47	38	30	
6' x 6'	33	27	21	
7' x 7'	24	19	15	
8' x 8'	18	15	12	
9' x 9'	14	12	9	
10' x 10'	12	10	7	
11' x 11'	10	8	6	
12' x 12'	8	7	5	

COEFFICIENTS OF UTILIZATION - % (Zonal Cavity Method)

Effective Floor Reflectance 20%

PCC	80		70		50		30		10		0							
	PW	70	50	30	10	70	50	30	10	50	30	10	0					
0	70	70	70	70	69	69	69	69	65	65	65	63	63	63	60	60	60	59
1	67	65	64	63	65	64	63	62	61	60	59	59	58	57	57	56	55	55
2	64	61	58	56	62	60	58	56	58	56	55	56	55	53	54	53	52	51
3	60	57	54	51	59	56	53	51	54	52	50	53	51	49	51	50	49	48
4	57	53	50	47	56	52	49	47	51	48	46	50	48	46	49	47	45	44
5	54	49	46	43	53	49	46	43	48	45	43	47	44	42	46	44	42	41
6	52	46	43	40	51	46	43	40	45	42	40	44	42	40	43	41	39	38
7	49	44	40	37	48	43	40	37	42	39	37	42	39	37	41			

AccuLite™
Commercial and Industrial Lighting

Type Y1 and Y2

Areos™ LED Area Lighting

High-efficiency, low-maintenance lighting
for area lighting applications



JUNO LIGHTING GROUP



Areos™ Low-Profile LED Area Lights

AccuLite Areos LED Area Lights incorporate the very latest large format LED chip technology. Innovative hybrid TIR/reflector optics and an ultra-thin, thermally efficient housing design produce up to 27,000 lumens of uniform area illumination and industry leading efficacies of 100 lumens per watt.

Areos LED 16" and 22" housings are offered in nine different lumen packages and four optical distributions. Choose between premium efficacy or standard efficacy models to solve virtually any area lighting project challenge.

Areos LED luminaires deliver equivalent photopic illumination levels to traditional metal halide fixtures with better uniformity and back light control using significantly less energy while achieving up to seven times longer life (100,000 hours L_{70} *).

Engineered for longevity and upgradeability, Areos LED luminaires feature proprietary encapsulated LED light engine technology, a thermally and environmentally isolated driver housing and a field rotatable/replaceable LED housing.

Advantages

- Industry leading photometric performance and efficacies
- 100,000 L_{70} hours*
- Custom-tailored combinations of lumen outputs, fixture sizes and distributions to solve virtually any area/site lighting application
- Small footprint design for clean architectural appearance
- Environmentally responsible use of materials and extremely low EPA ratings, enabling use of smaller/lower cost poles
- Dark Sky compliant

* L_{70} is the predicted time when LED performance depreciates to 70% of initial lumen output while operating at 25°C ambient temperature.





Technologically advanced, environmentally responsible and architecturally understated

Take a closer look to see how Areos LEDs deliver new levels of performance, innovation and design to the art and science of area lighting.



Areos LED Luminaires

Advanced optics



Areos LED Area Lights are state-of-the-art luminaires offering a unique balance of advanced technology and functional design. Unparalleled performance and reliability are the sum of the following key Areos LED features:

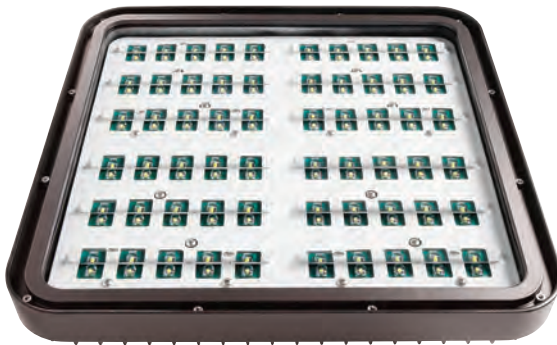

Hybrid TIR/ Reflector Optics

Type 2, 3 and 4 Areos distributions feature a high performance blended optic system combining high-efficiency symmetrical TIR lenses and vertical reflector vanes fabricated out of 95% reflective material featuring a nano-composite coating developed for demanding outdoor applications including lighting and solar collectors. This results in industry leading fixture efficacies, uniformity ratios and exceptional control of back spill light.



Side View Profile of Reflector

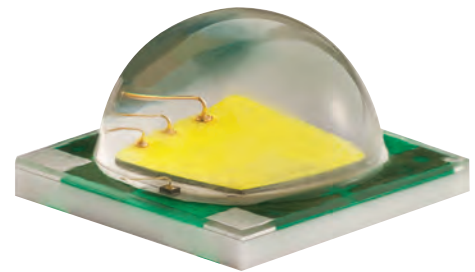

Latest Generation Large Format LED Technology

Larger die offers up to 20% higher efficacy with significantly improved thermal performance and ability to drive the LED more efficiently at higher currents versus smaller format chips used in typical competitive fixtures.

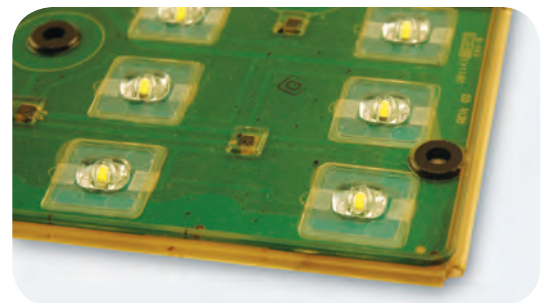

Individual LED Optics

Each LED is covered with an individual chip optic, assuring perfect alignment of LED and optic for consistent optical performance. Regardless of board manufacturing tolerances.

Innovative design

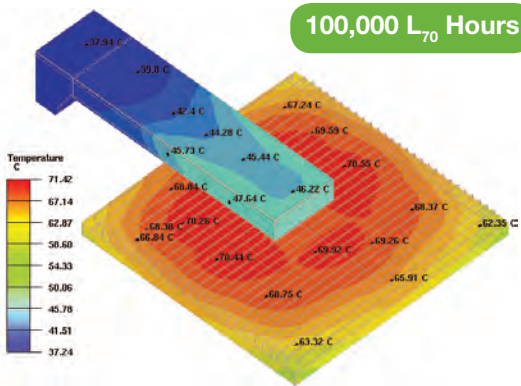

Efficient Thermal Management

The LED circuit boards in direct contact with the finely machined surface of the flat, finned housing offers the most efficient thermal design possible. The driver compartment and light engine housing are thermally isolated to further minimize temperatures of both the light engine and drivers, thereby extending the service life of the entire luminaire.

Field Rotatable and Replaceable Light Engine Housing



The light engine housing can be rotated or replaced after installation to change the orientation of the light distribution or to facilitate future upgrades as technology improves.



Sealed Light Engine Housing

Aeros LED fixtures carry an IP65 rating with a gasket-sealed 90% transmission tempered glass lens to exclude dirt and moisture and protect the optics from environmental contaminants and physical damage. An optional 95% high transmission glass can be specified, as well as a chemically frosted glass lens to soften the light and reduce glare. An integral membrane breather vent equalizes the internal/external air pressure to further enhance the quality and longevity of the seal.

For maximum efficiency Aeros LED fixtures can also be specified without a protective glass lens.

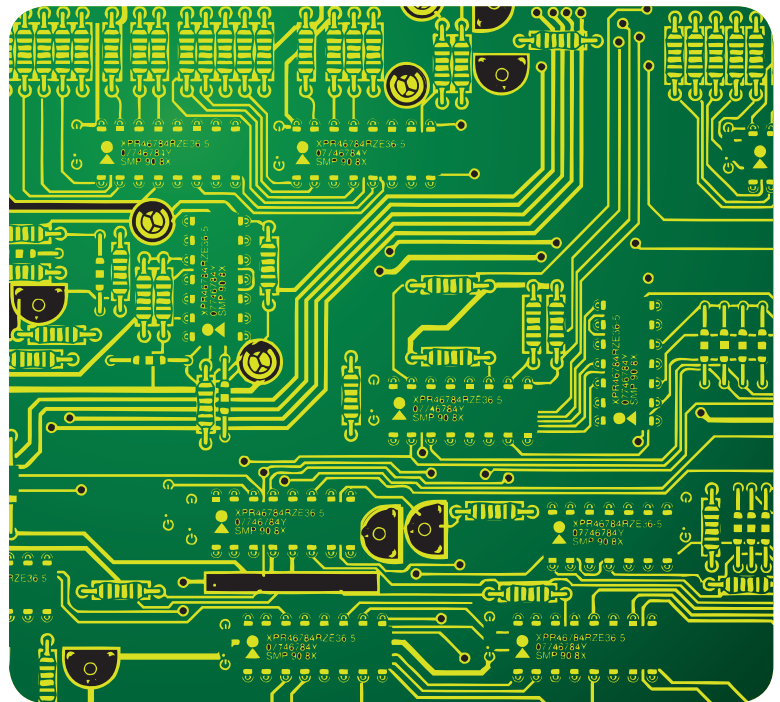

Superior Electronics Topology

Universal drivers accommodate inputs of 120-277VAC or 347-480VAC and have internal 2.5kV surge protection. In addition, each fixture is equipped with a separate surge protector that protects Line-Ground, Line-Neutral and Neutral-Ground in accordance with IEEE/ANSI C62.41.2 guidelines and is rated for 10,000 Amps. A 0-10V dimming driver is optional.

Performance without compromise



Areos LED Area Lights deliver as advertised. With a 27,000 lumen light engine, Areos LED luminaires are a true one-to-one replacement for 400W HID installations. No photopic/scotopic concessions are made and comparable illumination levels are delivered to the ground in the exact same layout. Bottom line, no compromises.

Project Name: Brittonfield Parkway **Goal:** Deliver the same average illumination using less energy.

LED vs. HID Results

This project was originally designed for 400W pulse start, high efficiency metal halide fixtures. Areos LED is able to deliver higher average illumination with less than half of the energy.

- **57% less energy**
- **Higher average illumination**
- **Improved uniformity**

HID Luminaire Schedule

Qty.	Description	LLF	Ave fc.	Max/Min	Fixture Input Watts	Total Site Watts
14	High Performance 400W metal halide, pulse start	0.72	3.28	10.3	455	6,370

LED Luminaire Schedule

Qty.	Description	LLF	Ave fc.	Max/Min	Fixture Input Watts	Total Site Watts
14	Areos LED Luminaires, A18 LED Engine	0.85	3.49	6.67	194	2,716

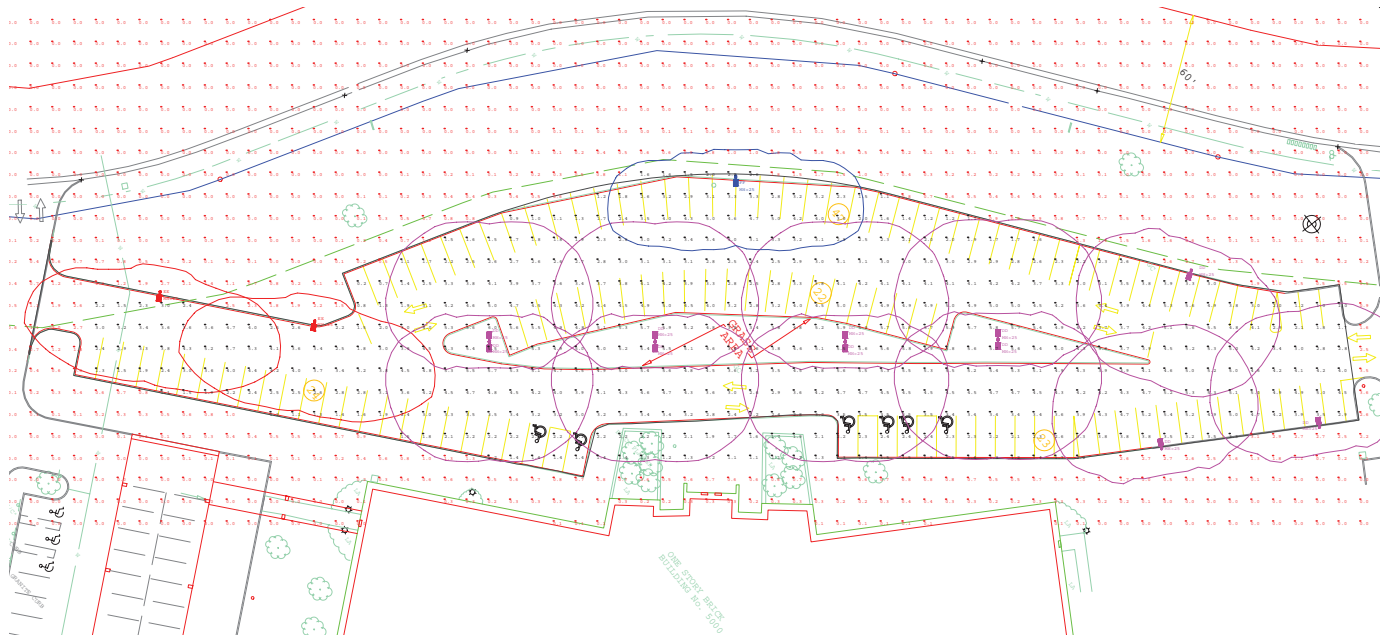

Scale: 1 inch= 60 Ft.

Areos LED Performance & Data

Premium Efficacy Fixtures @ 6500K CCT - 65 CRI

	Distribution	Fixture Size	Delivered Lumens (with lens)	Delivered Lumens (without lens – option "NL")	System Watts
SS1-A06-6K-UN-2B	Type II	16"	5,188	5,859	67
SS1-A06-6K-UN-3B	Type III	16"	5,395	6,134	67
SS1-A06-6K-UN-FT	FT	16"	6,328	6,414	67
SS1-A06-6K-UN-5	Type V	16"	5,063	5,939	67
SS1-A09-6K-UN-2B	Type II	16"	7,782	8,789	97
SS1-A09-6K-UN-3B	Type III	16"	8,092	9,201	97
SS1-A09-6K-UN-FT	FT	16"	9,492	9,620	97
SS1-A09-6K-UN-5	Type V	16"	7,595	8,909	97
SS1-A12-6K-UN-2B	Type II	16"	10,376	11,718	128
SS1-A12-6K-UN-3B	Type III	16"	10,790	12,268	129
SS1-A12-6K-UN-FT	FT	16"	12,657	12,827	129
SS1-A12-6K-UN-5	Type V	16"	10,127	11,879	128
LS1-A18-6K-UN-2B	Type II	22"	15,564	17,577	194
LS1-A18-6K-UN-3B	Type III	22"	16,185	18,402	194
LS1-A18-6K-UN-FT	FT	22"	18,985	19,241	194
LS1-A18-6K-UN-5	Type V	22"	15,190	17,818	194
LS1-A24-6K-UN-2B	Type II	22"	20,751	23,437	254
LS1-A24-6K-UN-3B	Type III	22"	21,580	24,537	254
LS1-A24-6K-UN-FT	FT	22"	25,313	25,654	254
LS1-A24-6K-UN-5	Type V	22"	20,253	23,758	254

For 4500K CCT apply a 0.9 multiplier to above values.
All tests were performed according to IES LM-79-08.

Standard Efficacy Fixtures @ 6500K CCT - 65 CRI

	Distribution	Fixture Size	Delivered Lumens (with lens)	Delivered Lumens (without lens – option "NL")	System Watts
SS2-B08-6K-UN-2B	Type II	16"	7,320	8,267	107
SS2-B08-6K-UN-3B	Type III	16"	7,612	8,655	107
SS2-B08-6K-UN-FT	FT	16"	8,929	9,049	107
SS2-B08-6K-UN-5	Type V	16"	7,144	8,381	107
SS2-B12-6K-UN-2B	Type II	16"	10,980	12,401	153
SS2-B12-6K-UN-3B	Type III	16"	11,418	12,983	153
SS2-B12-6K-UN-FT	FT	16"	13,394	13,574	153
SS2-B12-6K-UN-5	Type V	16"	10,716	12,571	153
SS2-B16-6K-UN-2B	Type II	16"	14,640	16,535	200
SS2-B16-6K-UN-3B	Type III	16"	15,225	17,311	200
SS2-B16-6K-UN-FT	FT	16"	17,859	18,099	200
SS2-B16-6K-UN-5	Type V	16"	14,289	16,761	200
LS2-B24-6K-UN-2B	Type II	22"	21,960	24,802	295
LS2-B24-6K-UN-3B	Type III	22"	22,837	25,966	295
LS2-B24-6K-UN-FT	FT	22"	26,788	27,148	295
LS2-B24-6K-UN-5	Type V	22"	21,433	25,142	295

Y1
Y2

For 4500K CCT apply a 0.9 multiplier to above values. 4500K luminaires have an 80 CRI.
All tests were performed according to IES LM-79-08.

Areos LED Ordering Information & Accessories

Example: SS1-A06-6K-UN-2B-BZ-D

Model	Light Engine ¹	CCT	Voltage	Distribution	Finish	Options
SS1-	A06	-6K	-UN	-2B	-BZ	-D

Premium Efficacy Fixtures:

Model	Light Engine ¹	CCT	Voltage	Distribution	Finish	Options
SS1 16" Fixture	A06 67 watts	- 6K 6500K 65 CRI	- UN - 120V thru 277V	- 2B Type II with back light control	BL Black	- PC* Photo control
	A09 97 watts	- 4K 4500K 80 CRI	- E12 - 120V	- 3B Type III with back light control	WH White	- PCR* Twist-lock photo control receptacle (photo control to be supplied by user)
	A12 127 watts		- E20 - 208V - E24 - 240V - E27 - 277V	- UH - 347V thru 480V	SL Silver	- F1* Fuse single pole line to neutral
LS1 22" Fixture	A18 194 watts		- E34 - 347V	- FT Forward throw with back light control	BZ Bronze	- F2* Fuse two pole line to line
	A24 254 watts		- E48 - 480V	- 5 Type V Square		- D 0-10V dimming driver
						- HT High transmission lens
						- FG Frosted glass lens
						- NL No lens (Wet Location Listed only)
						- RR Optics aimed to the right (when facing pole)
						- RL Optics aimed to the left (when facing pole)

* Must specify voltage

Standard Efficacy Fixtures:

SS2 16" Fixture	B08 ¹ 107 watts
	B12 ¹ 153 watts
	B16 ¹ 200 watts
LS2 22" Fixture	B24 295 watts

Accessories (Ordered & Shipped Separately)

Description	Cat. No.
Wall Mount Bracket	Bronze A-WMB-BZ Black A-WMB-BL White A-WMB-WH
Round Pole Adapter Fits 3" to 4" pole	Bronze A-RPA34-BZ Black A-RPA34-BL White A-RPA34-WH
Fits 5" to 6" pole	Bronze A-RPA56-BZ Black A-RPA56-BL White A-RPA56-WH
Post Top Fitter Fits 2" and 2 1/2" tenons (2 3/8" and 2 7/8" dia)	Bronze A-PTF-BZ Black A-PTF-BL White A-PTF-WH
Motion Sensor, Pole Mounted ON/OFF motion sensor HI/LO motion sensor. Requires fixture with "D" option (dimming driver)	MSONOFF** MSHILO**

** Sensor to be mounted on pole by installer

Light Engine Configurations

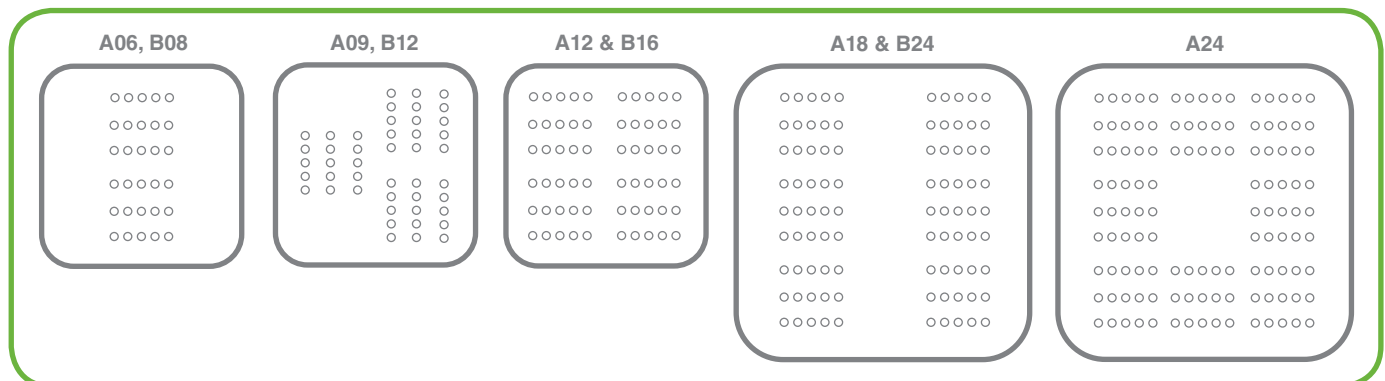

¹ NOTE: Fixtures in 480V or 347V (suffixes "UH", "E48" and "E34") are supplied with a larger driver housing.

Areos LED Customizable Options

Photo Controls

Two photo control options are available:

- Option “PC” is a factory-installed button style, photo control mounted on the side of the driver housing.
- Option “PCR” is a receptacle that is factory installed to the top of the driver housing to accept industry standard twist lock sensors. Twist lock sensors are user supplied and not available through the factory.



Photo Control Unit

Motion Sensors

Two motion sensor accessories deliver additional energy savings and longer fixture life:

- “MSONOFF” is an ON/OFF motion sensor that will turn the fixture ON only when it senses a passing pedestrian or vehicle. The infrared motion sensor is intended to be mounted on the pole by the installer – approximately 15 feet from the ground – for optimal performance.
- “MSHILO” uses the same motion sensor but with the ability to switch the fixture from high-to-low light levels. Normal operation is in the “low” mode. When the sensor detects movement, the fixture switches to “high”. The sensor is installed on the pole. The fixture must have a dimming driver (option “D”).



Glass Lenses

The standard luminaire comes with a tempered glass lens with 90% light transmission. As an alternative to the standard glass lens, the following options are available:

- Option “HT”, a high transmission lens, delivers an additional 5% light transmission improving the fixture efficacy.
- Option “FG” is a chemically frosted glass lens that softens the light and reduces glare.
- Option “NL”, with no glass lens, offers maximum efficacy and performance. Without a glass lens, Areos LED Area Lights have a wet location listing only.

Rotatable Optics

The Areos LED can be ordered with factory rotated optics. To request factory rotated optics to the right or left (when facing the pole), specify options “RR” or “RL” respectively. Additionally, the entire LED housing can be easily field rotated by the user or installer.

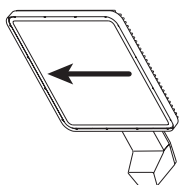

Left Facing
“-RL”

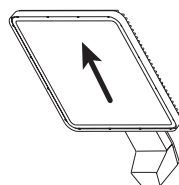

Standard
no suffix

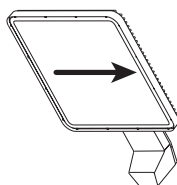

Right Facing
“-RR”

Areos LED luminaires can be ordered with these customizable options.

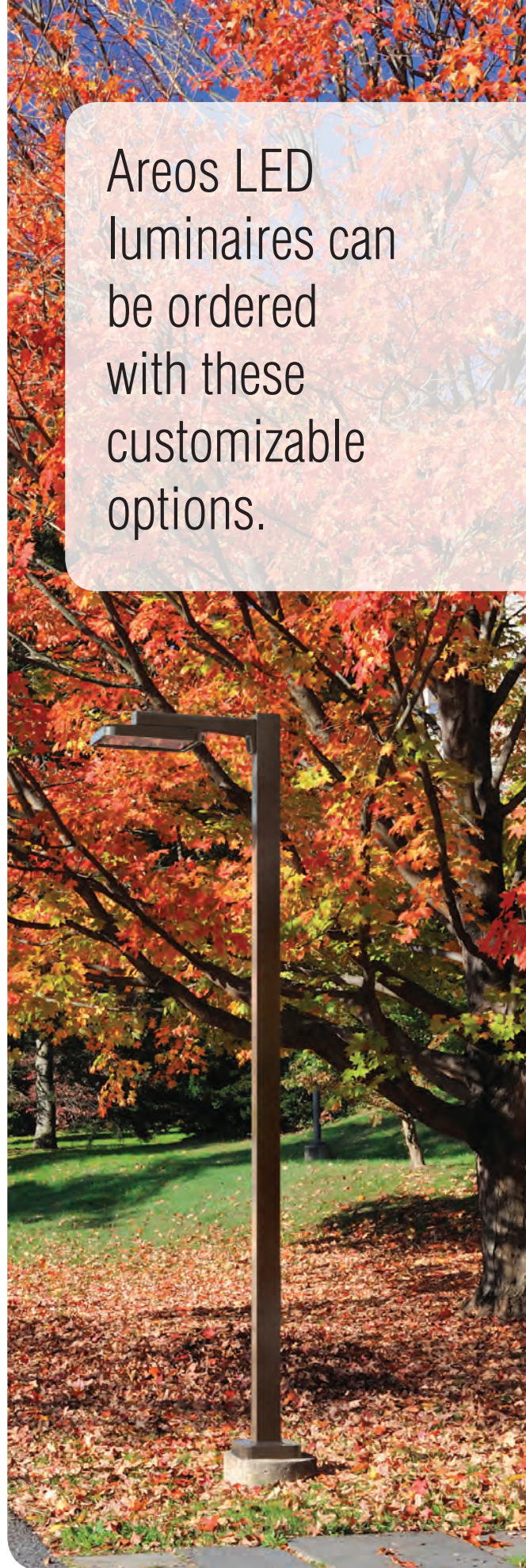



Areos LED Dimensions

Fixture	EPA	Weight
16" Pole Mount	0.78 ft ²	28 lb.
22" Pole Mount	0.82 ft ²	46 lb.

16" Pole Mount

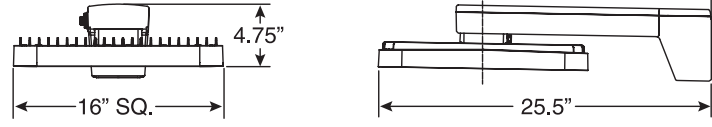

22" Pole Mount

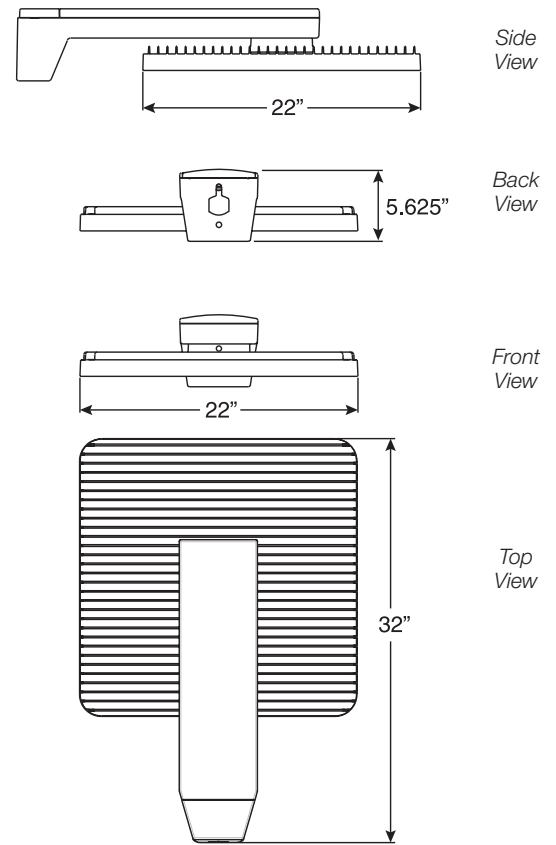

Pole Drilling Pattern

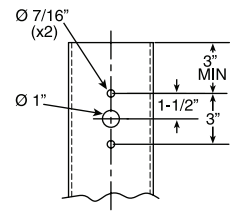

Areos LED Photometry

Premium Efficacy Fixtures

	SS1-A12-4K-UN-2B Total Lumens: 9,432		SS1-A12-4K-UN-3B Total Lumens: 9,809		SS1-A12-6K-UN-FT Total Lumens: 12,657		SS1-A12-4K-UN-5 Total Lumens: 9,207	
Zone	Luminaire Lumens	% of Luminaire Lumens	Luminaire Lumens	% of Luminaire Lumens	Luminaire Lumens	% of Luminaire Lumens	Luminaire Lumens	% of Luminaire Lumens
Forward Light	7,386	78.3%	7,871	80.2%	10,194	80.5%	4,603	50.0%
FL (0°-30°)	811	8.6%	697	7.1%	906	7.2%	474	5.1%
FM (30°-60°)	4,330	45.9%	4,290	43.7%	6,133	48.5%	1,997	21.7%
FH (60°-80°)	2,235	23.7%	2,874	29.3%	3,135	24.8%	2,119	23.0%
FVH (80°-90°)	10	0.1%	10	0.1%	20	0.2%	13	0.1%
Back Light	2,046	21.7%	1,938	19.8%	2,463	19.5%	4,603	50.0%
BL (0°-30°)	599	6.4%	576	5.9%	723	5.7%	474	5.1%
BM (30°-60°)	941	10.0%	908	9.3%	1,372	10.8%	1,997	21.7%
BH (60°-80°)	502	5.3%	450	4.6%	344	2.7%	2,119	23.0%
BVH (80°-90°)	4	0.0%	4	0.0%	24	0.2%	13	0.1%
Up Light	0	0.0%	0	0.0%	0	0.0%	0	0.0%
UL (90°-100°)	0	0.0%	0	0.0%	0	0.0%	0	0.0%
UH (100°-180°)	0	0.0%	0	0.0%	0	0.0%	0	0.0%
Trapped Light	N/A	N/A	N/A	N/A	N/A	N/A	N/A	N/A
BUG Rating	B2-U0-G2		B2-U0-G2		B2-U1-G2		B3-U0-G3	

All tests were performed according to IES LM-79-08.

Standard Efficacy Fixtures

	SS2-B16-4K-UN-2B Total Lumens: 13,309		SS2-B16-4K-UN-3B Total Lumens: 13,840		SS2-B16-6K-UN-FT Total Lumens: 17,859	
Zone	Luminaire Lumens	% of Luminaire Lumens	Luminaire Lumens	% of Luminaire Lumens	Luminaire Lumens	% of Luminaire Lumens
Forward Light	10,422	78.3%	11,106	80.2%	14,384	80.5%
FL (0°-30°)	1,144	8.6%	983	7.1%	1,278	7.2%
FM (30°-60°)	6,110	45.9%	6,053	43.7%	8,654	48.5%
FH (60°-80°)	3,154	23.7%	4,055	29.3%	4,423	24.8%
FVH (80°-90°)	14	0.1%	14	0.1%	28	0.2%
Back Light	2,887	21.7%	2,735	19.8%	3,475	19.5%
BL (0°-30°)	845	6.4%	813	5.9%	1,020	5.7%
BM (30°-60°)	1,328	10.0%	1,281	9.3%	1,936	10.8%
BH (60°-80°)	708	5.3%	635	4.6%	485	2.7%
BVH (80°-90°)	6	0.0%	6	0.0%	34	0.2%
Up Light	0	0.0%	0	0.0%	0	0.0%
UL (90°-100°)	0	0.0%	0	0.0%	0	0.0%
UH (100°-180°)	0	0.0%	0	0.0%	0	0.0%
Trapped Light	N/A	N/A	N/A	N/A	N/A	N/A
BUG Rating	B2-U0-G2		B2-U1-G2		B3-U1-G2	

All tests were performed according to IES LM-79-08.



Juno[®]

Recessed and Trac Lighting

indy[™]

Architectural Recessed Lighting

AccuLite[™]

Commercial and Industrial Lighting

AcuLux[®]

Precision Recessed Lighting

Navilite[®]

Exit and Emergency Lighting

DanaLite

Architectural Linear Lighting



Juno Lighting Group

1300 South Wolf Road
Des Plaines, IL 60018
Ph: 847.827.9880
www.junolightinggroup.com

Regional Offices & Warehouses

California
Illinois
Indiana
Pennsylvania
Texas
Ontario, CN

To learn more about AccuLite[™] Areos LED Low-Profile Luminares, please visit us at www.junolightinggroup.com.

©2013 JUNO LIGHTING, LLC. The marks appearing in this catalog are registered trademarks of Juno Lighting, LLC unless otherwise noted. Products shown in this brochure are covered by U.S. and international patents and patents pending. Specifications subject to change without notice.

TREE PRESERVATION NOTES:

- CLEARING LIMITS SHALL BE ROUGH STAKED TO FACILITATE LOCATION FOR TRENCHING AND FENCING INSTALLATION.
- NO CLEARING OR GRADING SHALL BEGIN IN AREAS WHERE TREE TREATMENT, PRESERVATION AND PROTECTION MEASURES HAVE NOT YET BEEN COMPLETED.
- SEE TREE FENCING DETAIL THIS SHEET.
- DEPENDING OF THE TIME OF THE YEAR OF CONSTRUCTION, TREES TO BE PRESERVED SHALL BE LIGHTLY PRUNED AND FERTILIZED BY A LICENSED TREE SPECIALIST.
- NAME OF TREE SPECIALIST (PENDING APPROVAL).

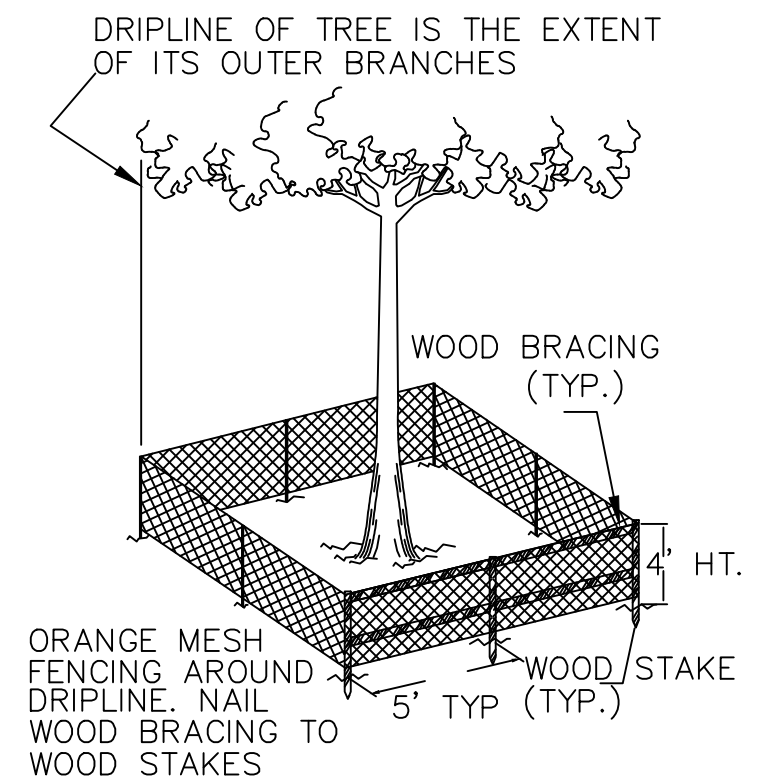
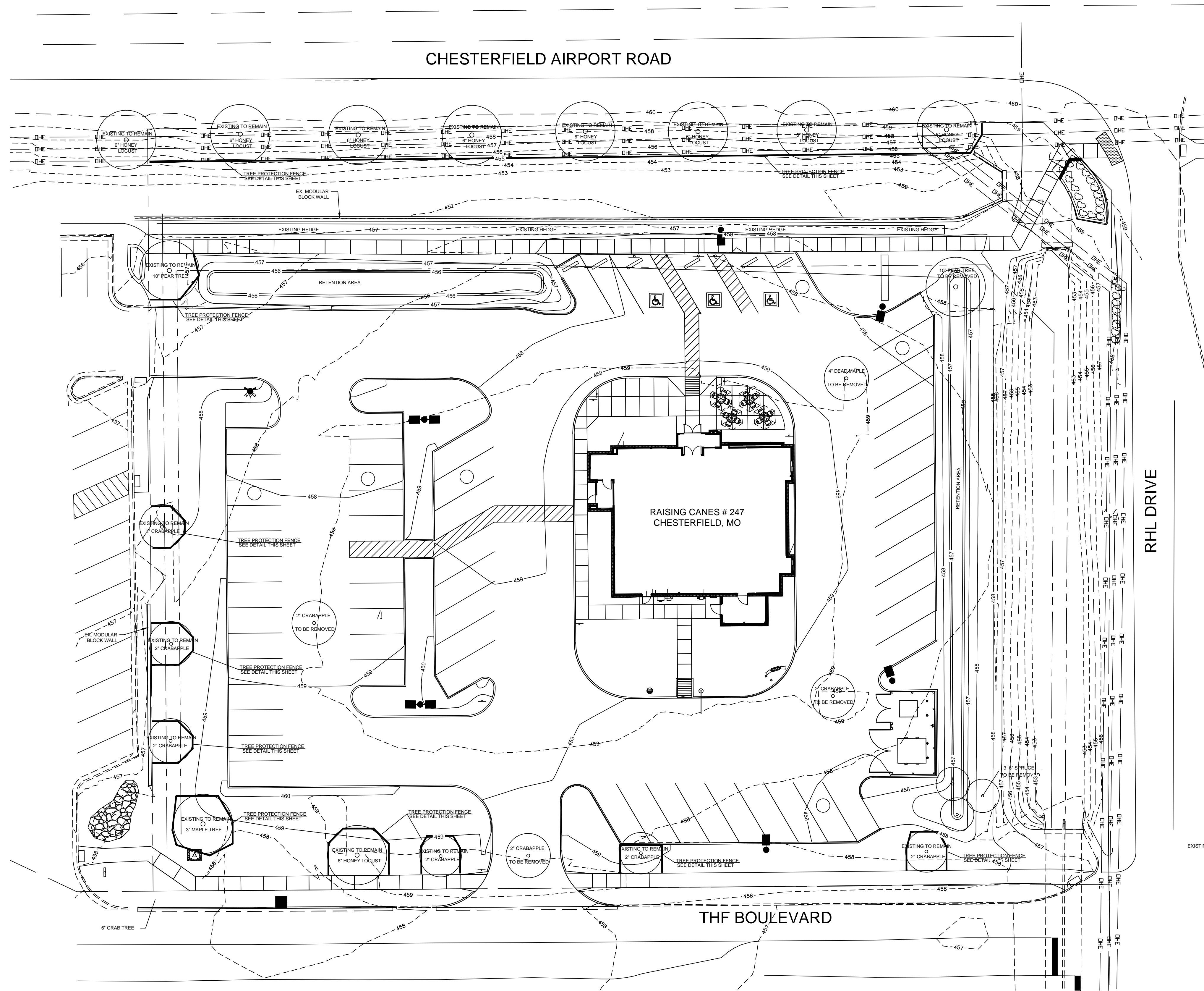

TREE PROTECTION FENCE n.t.s.
 NOTE: NO BARBED WIRE IS PERMISSIBLE
 TREE PROTECTION FENCE BY GENERAL CONTRACTOR
 FENCE TO BE INSTALLED ALL TIMES DURING CONSTRUCTION

TPP - Canopy Table

	Ac.	Sq Ft.
Total site Area	2.08	90,605 s.f.
1. Existing Canopy Coverage		
	Qty	
Honey Locust	1	400 s.f.
Pear	2	600 s.f.
Maple	1	400 s.f.
Crab	9	1,800 s.f.
Spruce	3	1,200 s.f.
		4,400 s.f. Total Canopy Coverage
2. Canopy Coverage Proposed for Removal		
	Qty	
Crab	3	600 s.f.
Spruce	3	1,200 s.f.
		1,800 s.f. Total Removed
3. Canopy Coverage Proposed for Preservation		
	Qty	
Honey Locust	1	400 s.f.
Pear	2	600 s.f.
Maple	1	400 s.f.
Crab	6	1,200 s.f.
		2,600 s.f. Total Preserved

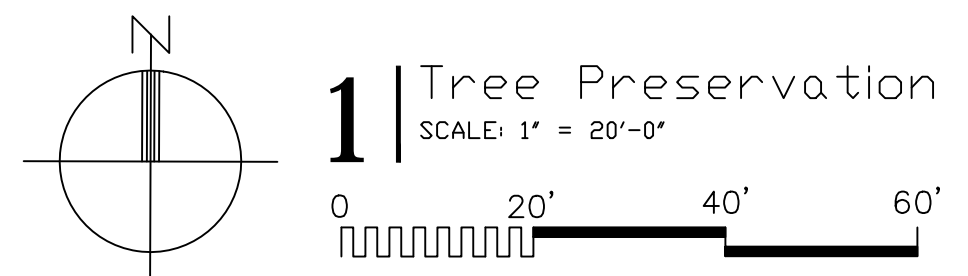

Restaurant Support Office
 6800 Bishop Road, Plano, TX 75024
 Tele: 214-455-7776

Prototype Issue Date:
 Store:
Raising Canes
Chesterfield Airport Road
Chesterfield, MO
Prototype 1
Store #247

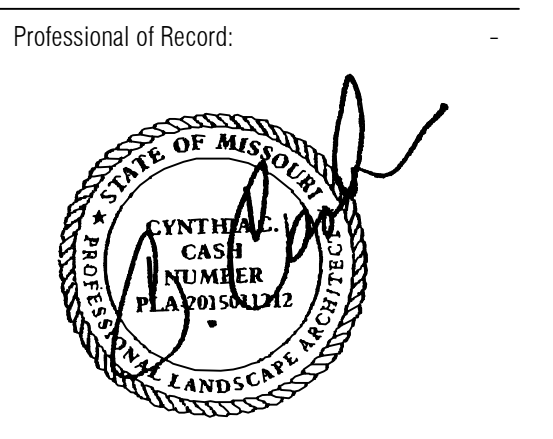

Designer's Information:
CSRS
 IMAGINE SHAPE DELIVER
 6767 Perkins Road Suite 200 Baton Rouge, LA 70808
 Telephone: 225 769-0546 Fax: 225 767-0060
 www.csronline.com

PRELIMINARY PLAN ONLY. NOT TO BE USED FOR CONSTRUCTION, BIDDING, RECORDATION, CONVEYANCE, OR SALES.

Set Control Information:

#	Date:	Description:

FOR PERMIT

Sheet Revisions:

#	Date:	Description:
01	04/15/2016	Revised

Sheet Title:
Tree Preservation Plan

Date: February 4, 2016
 Project Number: 216000
 Drawn By: CCC / FJS 03/05/2016

Sheet Number:
TP 1.0

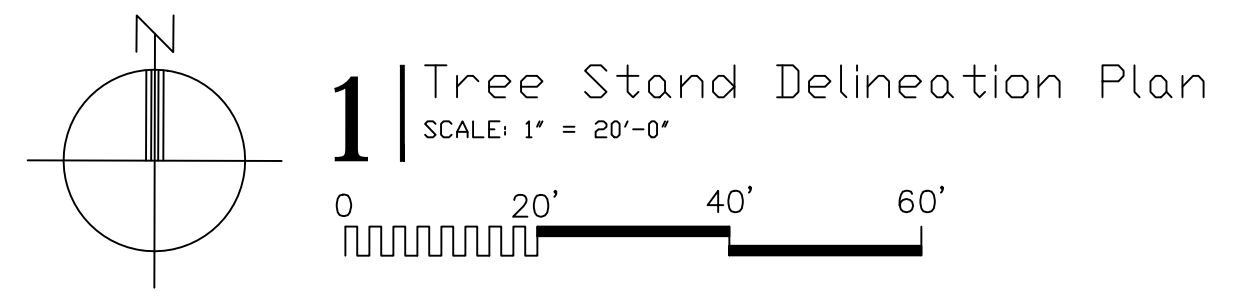
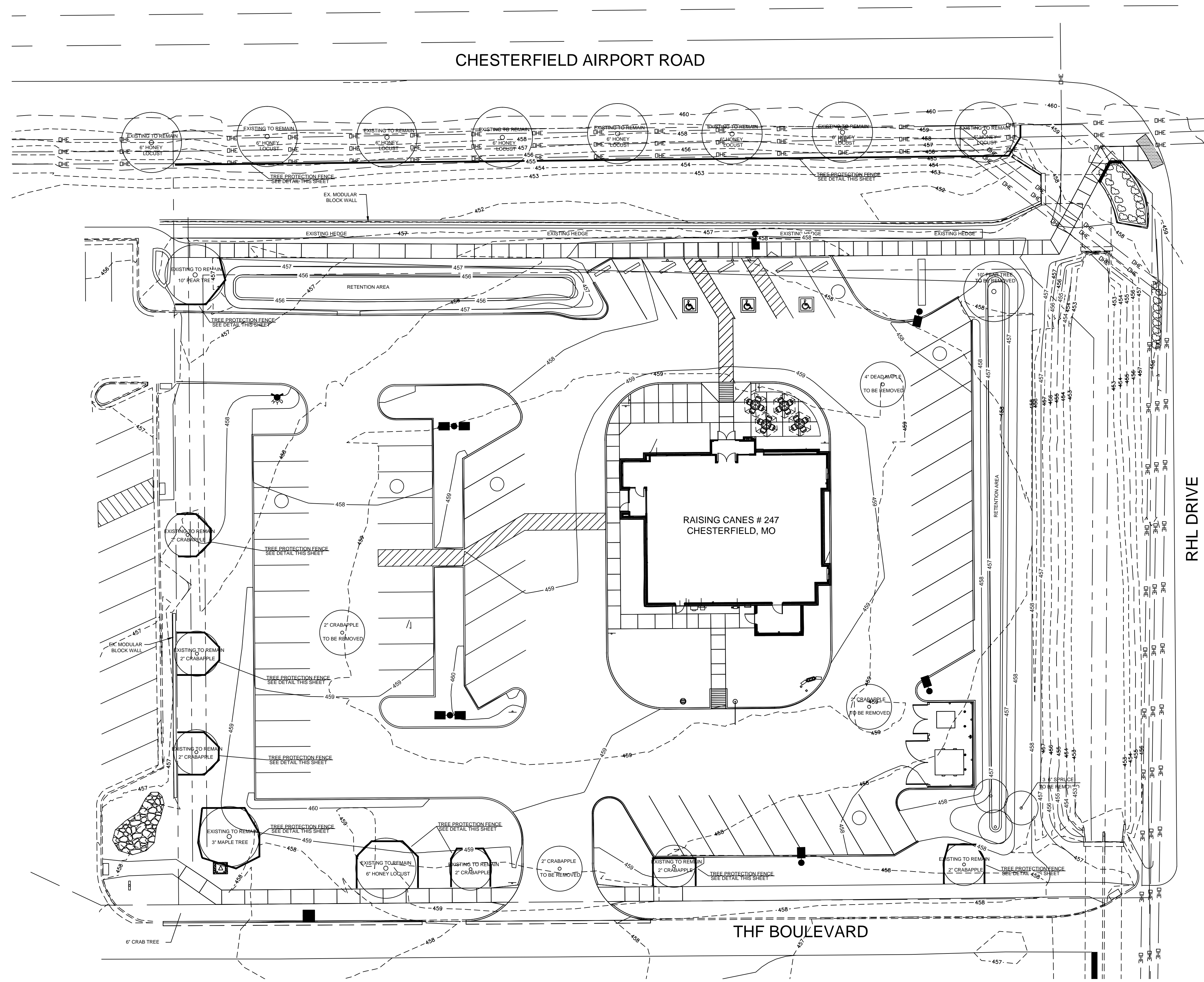

Restaurant Support Office
6800 Bishop Road, Plano, TX 75024
Tele: 214-455-7776

Prototype Issue Date: _____

Store:
Raising Cane's
Chesterfield Airport Road
Chesterfield, MO
Prototype 1
Store #247

Professional of Record:

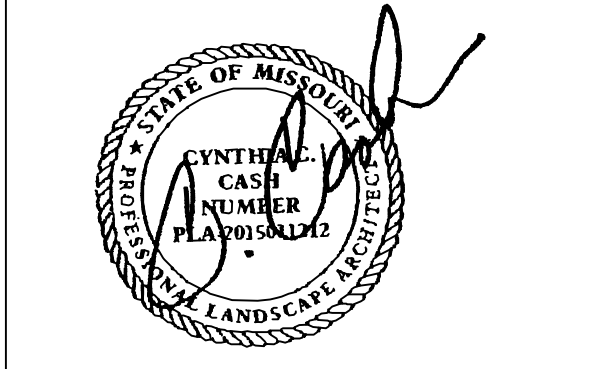

Designer's Information:

CSRS
IMAGINE SHAPE DELIVER
6767 Perkins Road Suite 200 Baton Rouge, LA 70808
Telephone: 225 769-0546 Fax: 225 767-0060
www.csrsline.com

PRELIMINARY PLAN ONLY. NOT TO BE USED FOR CONSTRUCTION, BIDDING, RECORDATION, CONVEYANCE, OR SALES.

Set Control Information:

#	Date:	Description:

FOR PERMIT

Sheet Revisions:

#	Date:	Description:
01	04/15/2016	Revised

Sheet Title:

Tree Stand Delineation Plan

Date: February 4, 2016

Project Number: 216000

Drawn By: CCC / FJS 03/05/2016

Sheet Number:

TSD 1.0

PRE-FINISHED METAL FLASHING W/SPRING LOCK COUNTER FLASHING APPLIED OVER TOP PLATE W/EXP. JT. @ 10'-0" O.C. MAX.

PROVIDE CONTINUOUS TS 4X4X1/8" FRAME SET ON 4"Ø PIPE SUPPORTS. RE: 4/S3

1" E.F.I.S. ON 5/8" DENS- GLASS OVER 4" METAL STUDS @ 16" O.C. E.F.I.S. TO MATCH STUCCO

ATTACH VERTICAL STEEL SUPPORTS TO PRE-FABRICATED WD ROOF TRUSSES W/ 3/4" THROUGH BOLT TOP & BOTTOM CORD, RE: 1/S3

PRE-FABRICATED WD TRUSSES EACH SIDE OF VERTICAL SUPPORT

2x4 "X" BRACING TO ADJACENT TRUSS AT EACH ROOF SCREEN VERTICAL SUPPORT.

2X BLOCKING

LIGHT GAUGE METAL STUD INFILL

GALV MTL. PANEL WITH KYNAR FINISH

PROVIDE PIPE FLASHING BOOT WITH ELASTOMETRIC SEALANT AND PIPE CLAMP PER ROOF MANUF. STANDARDS

SINGLE PLY ROOF SYSTEM

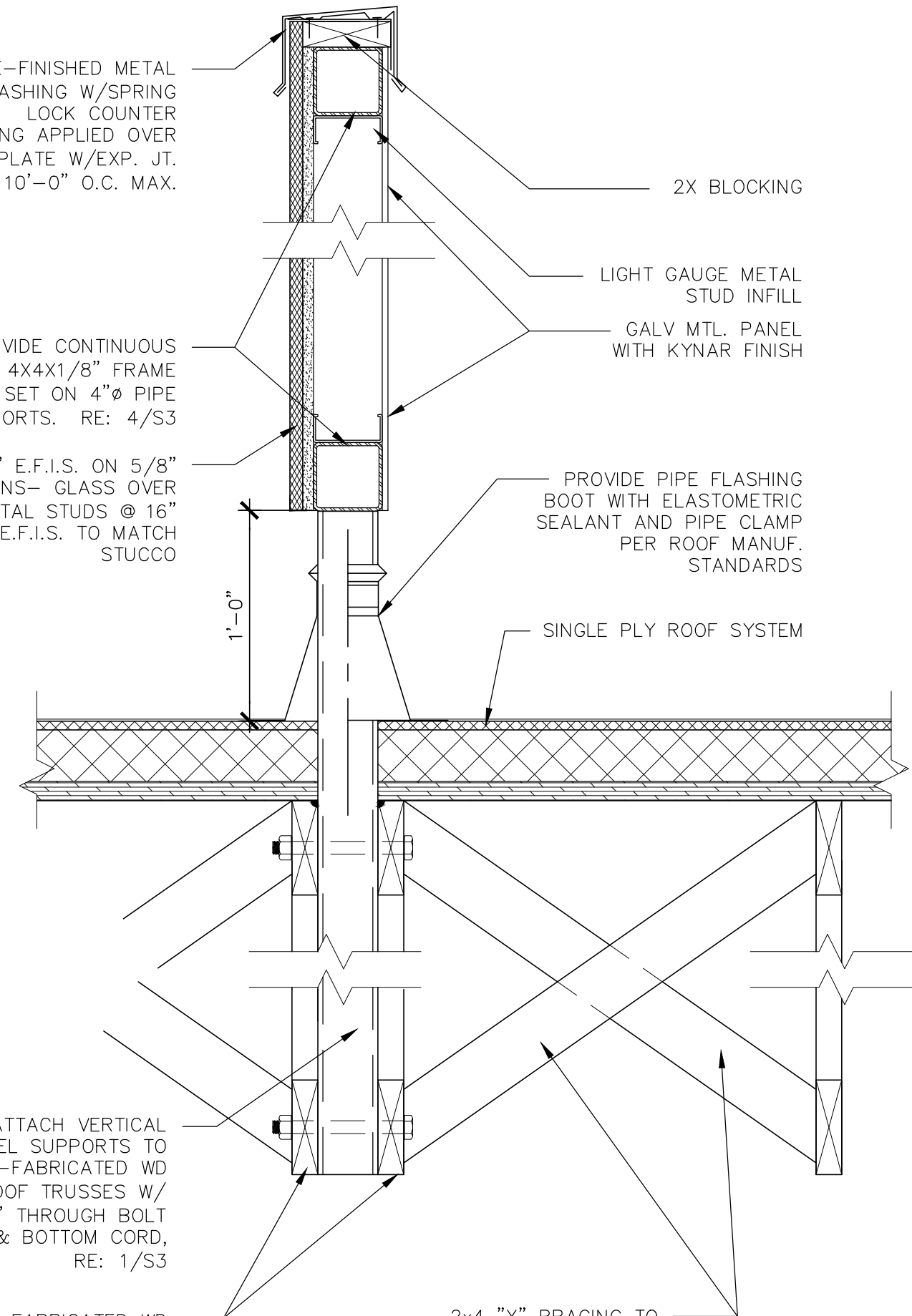

1 ROOF_SCREEN - SOLID
1'-1/2" = 1'-0"
1/8" = 1"



Restaurant Support Office
6800 Bishop Road, Plano, TX 75024
Tel: 972-769-3100 Fax: 972-769-3101

Prototype Issue Date: 15-1215

Store:
Raising Cane's
17360 Chesterfield
Airport Rd., Chesterfield,
MO 63005
Store #247 Prototype 1

Professional of Record: CHRIS J. PELLEGRIN



Designer's Information:

CSRS
IMAGINE SHAPE DELIVER

6767 Perkins Road Suite 200 Baton Rouge, LA 70808
Telephone: 225 769-0546 Fax: 225 767-0060
www.csronline.com

Set Control Information: (ARCH use only)

Setup / Update Date: 15-1105 | 15-1209

#	Date:	Description:

FOR PERMIT

Sheet Revisions: (sheet specific per Designer)

#	Date:	Description:

Sheet Title:

DETAILS

Initial sheet issue date: 15-1215

Project Number: 216000.23.247

Project Manager: JS

Drawn by: JS

Sheet Number:

A08.3

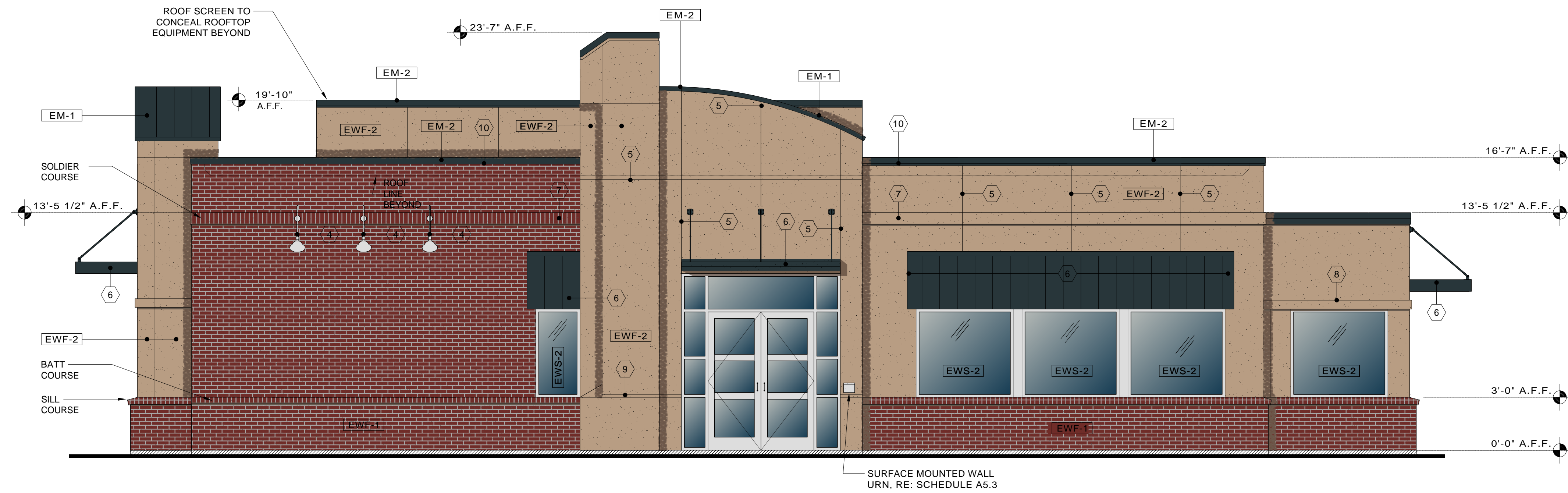

01 | FRONT ELEVATION
1/4" = 1'-0"
01:A4.1

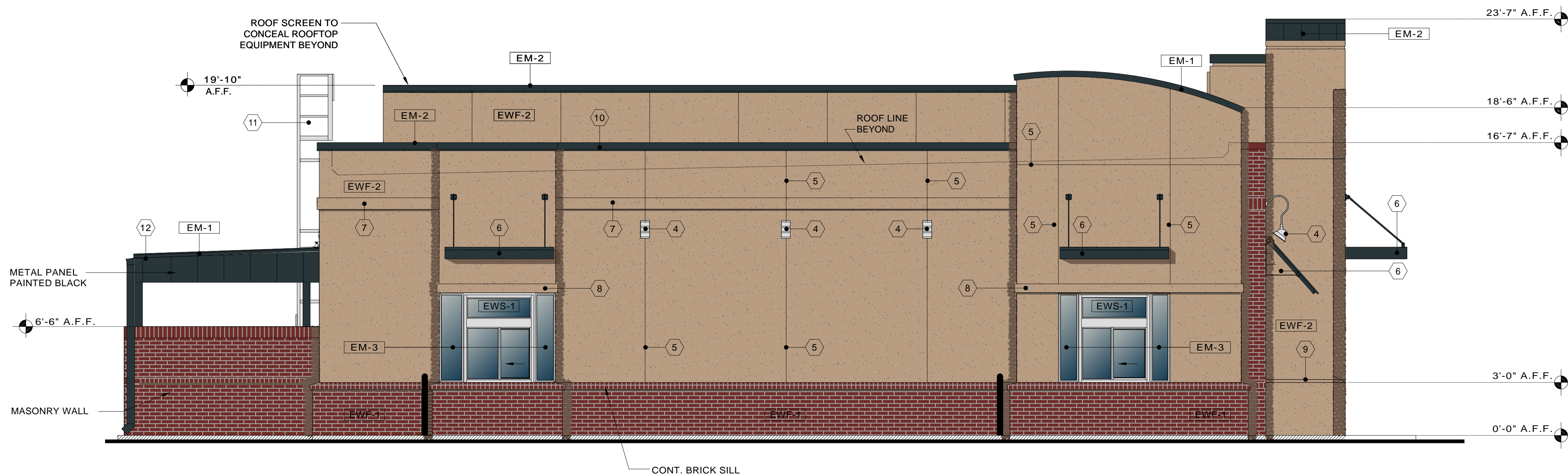

02 | DRIVE-THRU ELEVATION
1/4" = 1'-0"
02:A4.1

KEY NOTES

MARK	DESCRIPTION
1	NOT USED
2	NOT USED
3	NOT USED
4	EXTERIOR LIGHTING, RE: ELEC.
5	CONTROL JOINT
6	PRE-FABRICATED METAL AWNING OR CANOPY, G.C. TO PERMIT SEPARATELY
7	8" STUCCO OR BRICK BAND AS SHOWN
8	6" STUCCO OR BRICK BAND AS SHOWN
9	2" WIDE STUCCO REVEAL (1/4" DEEP)
10	NEON CHANNEL & NEON BY OWNER NEON TO BE WHITE
11	ROOF ACCESS LADDER RE: SP3. PROVIDE ALL REQ'D. BLOCKING FOR INSTALLATION.
12	METAL ROOF, GUTTER & DOWNSPOUT (RE: DETAIL 1A10.2)

NOTES:

- NOT USED
- CANOPIES AND AWNINGS ARE REQUESTED AS DEFERRED SUBMITTALS AS INDICATED ON SHEET CS1. G.C. TO PERMIT CANOPIES AND AWNINGS USING MANUFACTURER SPECIFICATIONS AND SHOP DRAWINGS.

EXTERIOR MATERIALS

MARK	DESCRIPTION
EM-1	STANDING SEAM METAL ROOF GALVANIZED STEEL SHEET W/ KYNAR FINISH (24 GA.) STANDARD COLOR.
EM-2	METAL CAP FLASHING GALVANIZED STEEL SHEET W/ KYNAR FINISH (24 GA.) STANDARD COLOR.
EM-3	STAINLESS STEEL COVER PANEL FASTENED TO WALL W/ STAINLESS STEEL SEAT AND SCREWS PROVIDED BY OWNER INSTALLED BY G.C.

EXTERIOR WINDOW SYSTEMS

MARK	DESCRIPTION
EWS-1	DRIVE THRU WINDOW
EWS-2	4 1/2" ALUM. STOREFRONT KAWNEER TRIFAB 451 II ANODIZED, TYP. U.N.O.

EXTERIOR WALL FINISHES

MARK	DESCRIPTION
EWF-1	FACE BRICK: ENDICOT BRICK, MEDIUM IRONSPOT#46, SMOOTH FACE, 4"X12"
EWF-2	COLOR: DRYVIT #383 HONEY TWIST, SANDPEBBLE FINISH. 7/8" STUCCO FINISH ON SELF FURRING GALV. METAL LATH W/ FRY REGLET CORNERS, MOLDING & TRIM AS REQUIRED (RE: SPECIFICATIONS);

SEALANT

- PROVIDE SEALANT & BACKER RODS AT ALL DISSIMILAR MATERIALS.
- TWO-PART NONSAG POLYURETHANE SEALANT BY SONNEBORN BUILDING PRODUCTS. CUSTOM COLOR TO MATCH STUCCO AT ALL DOOR FRAMES, STOREFRONT & WINDOWS, WALL PENETRATIONS AND STUCCO TO MASONRY CONNECTIONS.



Restaurant Support Office
6800 Bishop Road, Plano, TX 75024
Tel: 972-769-3100 Fax: 972-769-3101

Prototype Issue Date: 15-1215

Store:
**Raising Cane's
Chesterfield Airport &
Chesterfield Commons
W. Drive
Store #247 Prototype 1**

Professional of Record: CHRIS J. PELLEGRIN



Designer's Information:

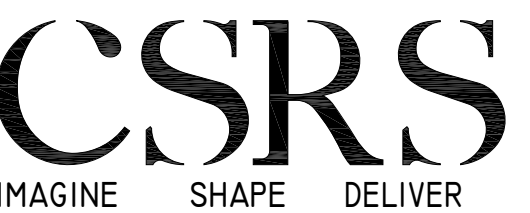

6767 Perkins Road Suite 200 Baton Rouge, LA 70808
Telephone: 225 769-0546 Fax: 225 767-0060
www.csrsnline.com

Set Control Information: (ARCH use only)

Setup / Update Date: 15-1105 | 15-1209

#	Date:	Description:

FOR PERMIT

Sheet Revisions: (sheet specific per Designer)

#	Date:	Description:

Sheet Title:

EXTERIOR ELEVATIONS

Initial sheet issue date: 15-1215

Project Number: 216000.23.247

Project Manager: JS

Drawn by: JS

Sheet Number:

A04.1

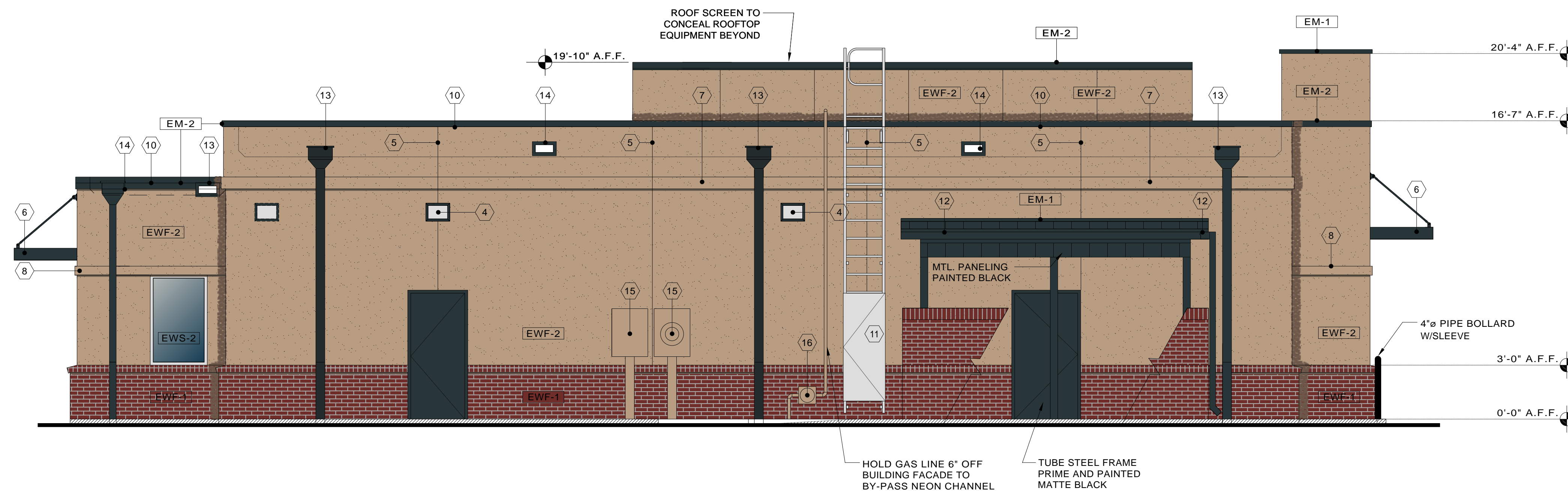

01 | REAR ELEVATION
1/4" = 1'-0"
01:A4.2

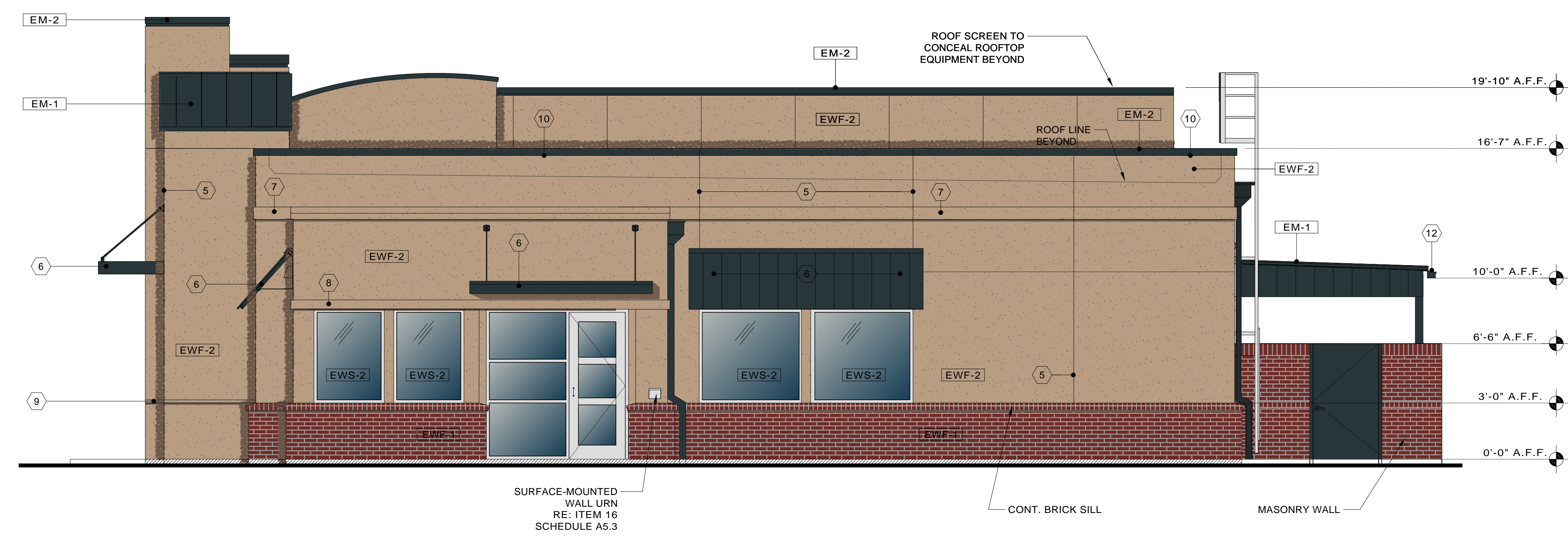

02 | SIDE ENTRY ELEVATION
1/4" = 1'-0"
02:A4.2

KEY NOTES

MARK	DESCRIPTION
1	NOT USED
2	NOT USED
3	NOT USED
4	EXTERIOR LIGHTING, RE: ELECTRICAL
5	CONTROL JOINT
6	METAL COVERED CANOPY, GC TO PERMIT SEPARATELY
7	8" STUCCO OR BRICK BAND AS SHOWN
8	6" STUCCO OR BRICK BAND AS SHOWN
9	2" WIDE STUCCO REVEAL (1/4" DEEP)
10	NEON CHANNEL & NEON BY OWNER NEON TO BE WHITE
11	ROOF ACCESS LADDER RE: SP3. PROVIDE ALL REQ'D. BLOCKING FOR INSTALLATION.
12	METAL ROOF, GUTTER & DOWNSPOUT (RE: DETAIL 1A10.2)
13	ROOF SCUPPER & DOWNSPOUT OMIT STUCCO BAN @ DOWNSPOUT (RE: 1A10.2)
14	OVER FLOW SCUPPER
15	ELECTRICAL CABINETS, PAINT TO MATCH STUCCO (PT-10). COORDINATE EXACT REQUIREMENTS WITH ELEC. SUB-CONTR.
16	GAS METER & PIPING, PAINT TO MATCH STUCCO (PT-10)
17	COMBUSTION AIR LOUVERS, PROVIDE INSECT SCREENS, PAINT TO MATCH STUCCO (RE: MECHANICAL) (PT-10)

- NOTES:
- NOT USED
 - CANOPIES AND AWNINGS ARE REQUESTED AS DEFERRED SUBMITTALS AS INDICATED ON SHEET CS1. G.C. TO PERMIT CANOPIES AND AWNINGS USING MANUFACTURER SPECIFICATIONS AND SHOP DRAWINGS.

EXTERIOR MATERIALS

MARK	DESCRIPTION
EM-1	STANDING SEAM METAL ROOF GALVANIZED STEEL SHEET W/ KYNAR FINISH (24 GA.) STANDARD COLOR.
EM-2	METAL CAP FLASHING GALVANIZED STEEL SHEET W/ KYNAR FINISH (24 GA.) STANDARD COLOR.
EM-3	STAINLESS STEEL COVER PANEL FASTENED TO WALL W/ STAINLESS STEEL SEAT AND SCREWS PROVIDED BY OWNER INSTALLED BY G.C.

EXTERIOR WINDOW SYSTEMS

MARK	DESCRIPTION
EWS-1	DRIVE THROUGH WINDOW
EWS-2	4 1/2" ALUM. STOREFRONT KAWNEER TRIFAB 451 II ANODIZED, TYP. U.N.O.

EXTERIOR WALL FINISHES

MARK	DESCRIPTION
EW-1	FACE BRICK: ENDICOT BRICK, MEDIUM IRONSPOT#46, SMOOTH FACE, 4"X12"
EW-2	COLOR: DRYVIT #383 HONEY TWIST, SANDPEBBLE FINISH. 7/8" STUCCO FINISH ON SELF FURRING GALV. METAL LATH W/ FRY REGLET CORNERS, MOLDING & TRIM AS REQUIRED (RE: SPECIFICATIONS);

SEALANT

- PROVIDE SEALANT & BACKER RODS AT ALL DISSIMILAR MATERIALS.
- TWO-PART NONSAG POLYURETHANE SEALANT BY SONNEBORN BUILDING PRODUCTS. CUSTOM COLOR TO MATCH STUCCO AT ALL DOOR FRAMES, STOREFRONT & WINDOWS, WALL PENETRATIONS AND STUCCO TO MASONRY CONNECTIONS.



Restaurant Support Office
6800 Bishop Road, Plano, TX 75024
Tel: 972-769-3100 Fax: 972-769-3101

Prototype Issue Date: 15-1215

Store:
**Raising Cane's
Chesterfield Airport &
Chesterfield Commons
W. Drive
Store #247 Prototype 1**

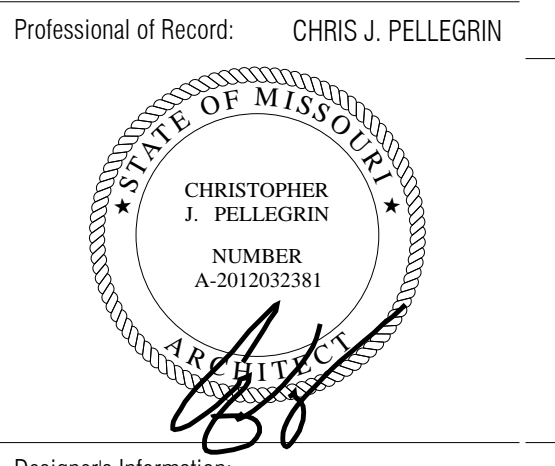

Designer's Information:
CSRS
IMAGINE SHAPE DELIVER

6767 Perkins Road Suite 200 Baton Rouge, LA 70808
Telephone: 225 769-0546 Fax: 225 767-0060
www.csronline.com

Set Control Information: (ARCH use only)

#	Date:	Description:

FOR PERMIT

#	Date:	Description:

Sheet Title:

EXTERIOR ELEVATIONS

Initial sheet issue date: 15-1215
Project Number: 216000.23.247
Project Manager: JS
Drawn by: JS

Sheet Number:
A04.2



