

# Memorandum

## Department of Public Works



**TO:** Michael O. Geisel, P.E.  
City Administrator

**FROM:** James A. Eckrich, P.E. *JAE*  
Public Works Dir. / City Engineer

**DATE:** January 6, 2020

**RE:** Parking Restriction Removal on Deerhorn Drive

---

The Greenleaf Estates Home Owners Association has requested the removal of a parking restriction on Deerhorn Drive. Schedule IX of the City's Model Traffic Ordinance includes a parking restriction on "Deerhorn Drive, both sides, from Greenleaf Valley Drive to its terminus, including cul-de-sac." This parking restriction pre-dates the City's incorporation, and the residents do not know why it was originally implemented. However, they would like to see it removed so that they can park on the street. Additionally, the Trustees believe the removal of the parking restriction will prevent damage to adjacent common ground caused by utility vehicles which cannot currently park on Deerhorn Drive.

It is unusual for the City to receive a request to remove a parking restriction. City Council Public Works Policy 25 (attached) covers the implementation of a parking restriction. It requires 90% support of residents immediately adjacent to the area where the parking restriction is proposed. In this case I have told the Trustees that the same level of support (90%) is required to remove the parking restriction.

A representative of the subdivision who lives on Deerhorn Drive, Marlene Lischwe, circulated a petition to remove the parking restriction. She received support from 20 of the 21 properties (95.2%) with access to Deerhorn Drive. The signed petitions and letter from the Greenleaf Estates Home Owners Association are attached.

Removal of the parking restriction has been reviewed by City Staff, and we have no objection to the request. Accordingly, I recommend approval of the removal of the parking restriction on Deerhorn Drive.

**Action Recommended**

This matter should be forwarded to the Planning and Public Works Committee. Should PPW concur with Staff's recommendation, it should recommend approval of the attached ordinance to the full City Council.

Please forward to PPW for review and recommendation for the full Council.



2020-1-6

BILL NO. \_\_\_\_\_

ORDINANCE NO. \_\_\_\_\_

**AN ORDINANCE AMENDING SECTION 300, SCHEDULE IX OF THE MODEL TRAFFIC ORDINANCES OF THE CITY OF CHESTERFIELD BY REMOVING THE PARKING RESTRICTION ON DEERHORN DRIVE.**

**WHEREAS**, the City of Chesterfield has received a request from the Greenleaf Estates Home Owners Association to remove the parking restriction on both sides of Deerhorn Drive; and,

**WHEREAS**, the Greenleaf Estates Home Owners Association has obtained approval of 95% of the property owners abutting the parking restriction; and

**WHEREAS**, the City Engineer has reviewed the request and has no objection to the removal of the parking restriction; and,

**WHEREAS**, the Planning and Public Works Committee, having considered said request, recommended approval of the removal of the parking restriction on both sides of Deerhorn Drive from Greenleaf Valley Drive to the cul-de-sac;

**NOW THEREFORE BE IT ORDAINED BY THE CITY COUNCIL OF THE CITY OF CHESTERFIELD, ST. LOUIS COUNTY, MISSOURI, AS FOLLOWS:**

**Section 1.** Section 300, Schedule IX of the Model Traffic Ordinances as it relates to Parking Restrictions is hereby amended by deleting the following:

<i>Part of Road or Street Where Parking is Regulated</i>	<i>Parking Restriction</i>
Deerhorn Drive, both sides, from Greenleaf Valley Drive to its terminus, including cul-de-sac	No Parking Anytime

**Section 2.** This ordinance shall be in full force and effect from and after its passage and approval.

Passed and approved this \_\_\_\_\_ day of \_\_\_\_\_, 2020.

\_\_\_\_\_  
PRESIDING OFFICER

\_\_\_\_\_  
Bob Nation, MAYOR

ATTEST:

---

Vickie Hass, CITY CLERK

FIRST READING HELD:

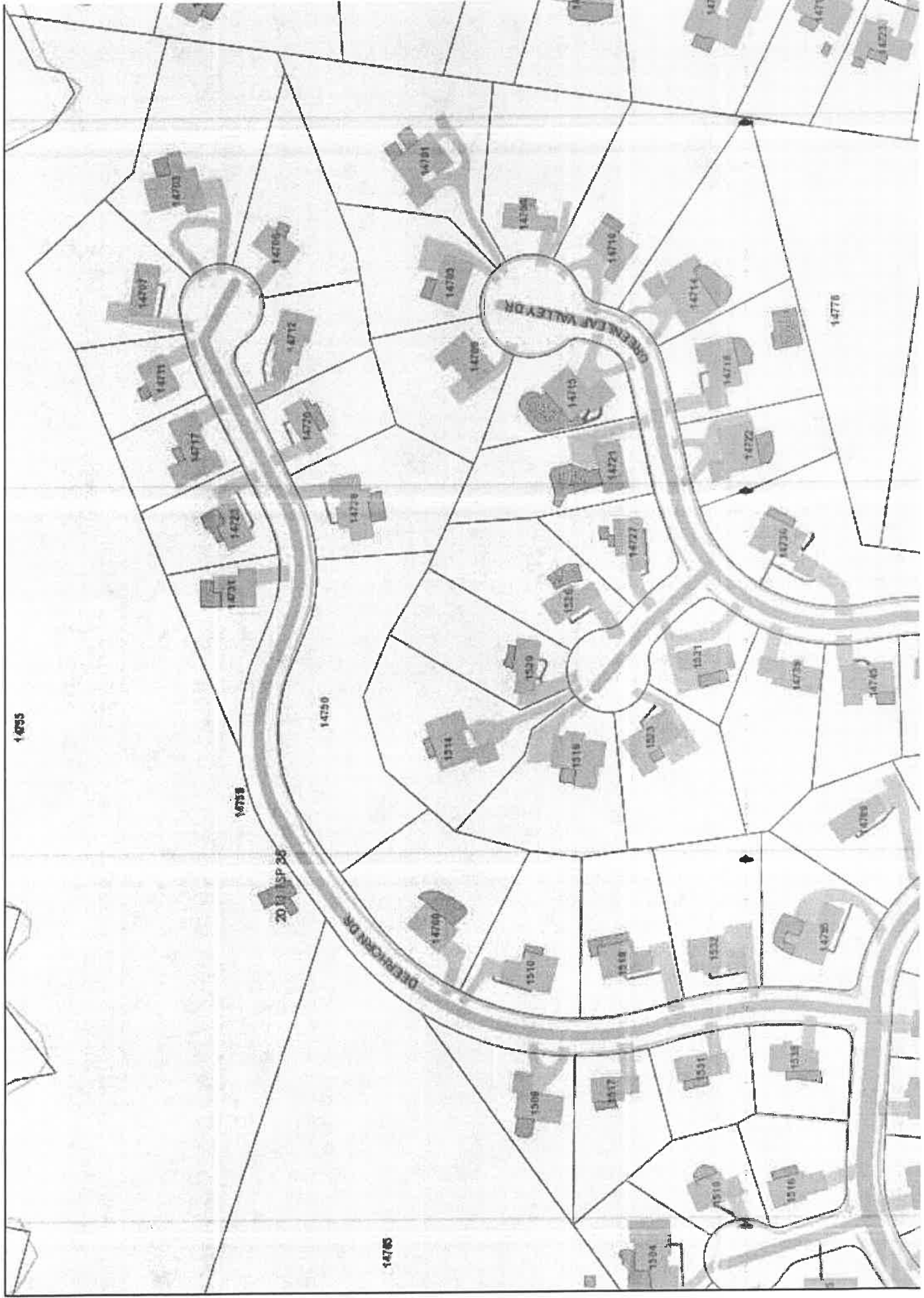

# Greenleaf Estates HOA

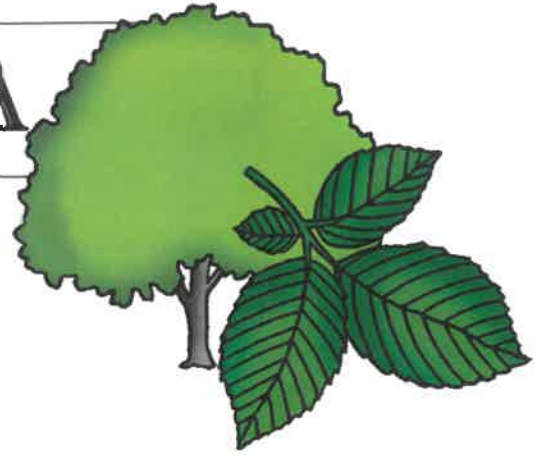

04305+20

01-06-20 A 11:43 IN

December 31, 2019

To: City of Chesterfield

Subject: Repeal of Schedule IX Subdivision Parking Restriction

Hello,

On behalf of the Trustees of Greenleaf Estates, we are in full agreement with the consensus of the property owners identified in the accompanying petition to request the complete repeal of the parking restriction contained in Schedule IX reading "*Deerhorn Drive, both sides, from Greenleaf Valley Drive to its terminus, including cul-de-sac*". The posted restriction serves no benefit in our subdivision and contributes to vehicle damage to our common grounds. We are happy to have it removed from the City record.

Let us know if any further information is required to facilitate this request by contacting me directly at 314.604.0253.

Cordially,

A handwritten signature in black ink, appearing to read "Bryan Hunt".

Bryan Hunt, Trustee Greenleaf Estates  
Jim Otis, Trustee Greenleaf Estates  
Dorian Jamison, Trustee Greenleaf Estates

bhunt@rgare.com  
jimotis@otisandclark.com  
jingle331@yahoo.com

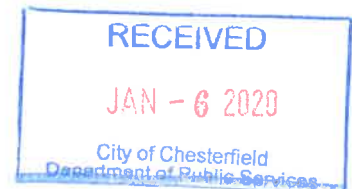

To the City of Chesterfield:

I/WE are requesting the removal of the "NO PARKING" signs on Deerhorn Drive. One of these signs is adjacent to my property.

NAME: DENNIS POKRES

SIGNATURE: 

DATE: 12/29/2019

ADDRESS: 14717 Deerhorn Dr

To the City of Chesterfield:

I/WE are requesting the removal of the "NO PARKING" signs on Deerhorn Drive. This sign is adjacent to my property.

NAME: Kevin Armstrong

SIGNATURE: 

DATE: 1/29/18

ADDRESS: 14723 Deerhorn Dr  
Chesterfield, MO  
63017

To the City of Chesterfield:

I/WE are requesting the removal of the "NO PARKING" signs on Deerhorn Drive. One of these signs is adjacent to my property.

NAME: Karen + Dennis Huighe

SIGNATURE: *Karen Huighe*

DATE: 12/29/19

ADDRESS: 14731 Deerhorn Dr  
Chesterfield, MO 63017

To the City of Chesterfield:

I/WE are requesting the removal of the "NO PARKING" signs on Deerhorn Drive. This sign is adjacent to my property.

NAME: *Sharon/Steve Hargrave*

SIGNATURE: *Sharon/Steve Hargrave*

DATE: 12/29/2019

ADDRESS: 1509 Deerhorn Dr.  
Chesterfield, Mo. 63017



To the City of Chesterfield:

I/WE are requesting the removal of the "NO PARKING" signs on Deerhorn Drive. One of these signs is adjacent to my property.

NAME: Carey, Stacy

SIGNATURE: 

DATE: 12/30/2019

ADDRESS: 14728 Deerhorn Dr

To the City of Chesterfield:

I/WE are requesting the removal of the "NO PARKING" signs on Deerhorn Drive. This sign is adjacent to my property.

NAME: Judy Brown Rowden

SIGNATURE: 

DATE: 12-29-19

ADDRESS: 14712 Deerhorn Dr

To the City of Chesterfield:

I/WE are requesting the removal of the "NO PARKING" signs on Deerhorn Drive.

NAME: Lanson, Douglas

SIGNATURE:



DATE:

1/6/20

ADDRESS:

1531 Deerhorn Dr

To the City of Chesterfield:

I/WE are requesting the removal of the "NO PARKING" signs on Deerhorn Drive.

NAME: Hunt, Mulima

SIGNATURE:

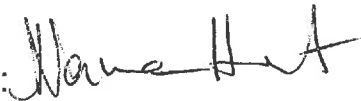

DATE:

12/30/2019

ADDRESS:

1518 Deerhorn

To the City of Chesterfield:

I/WE are requesting the removal of the "NO PARKING" signs on Deerhorn Drive.

NAME: *Phillips*

SIGNATURE: *Barbara J. Phillips*

DATE: *12/30/19*

ADDRESS: *14720 Deerhorn Dr.*

To the City of Chesterfield:

I/WE are requesting the removal of the "NO PARKING" signs on Deerhorn Drive.

NAME: *Otis*

SIGNATURE: *Jan Otis*

DATE: *1/5/2020*

ADDRESS: *14795 Greenleaf Valley Dr.*

To the City of Chesterfield:

I/WE are requesting the removal of the "NO PARKING" signs on Deerhorn Drive.

NAME: Ben Wand Ben Wand

SIGNATURE: Ben Wand

DATE: 12/29/19

ADDRESS:

~~1539~~ 1539 Deerhorn dr.  
Chesterfield, ma 03017

To the City of Chesterfield:

I/WE are requesting the removal of the "NO PARKING" signs on Deerhorn Drive.

NAME: Daniel + Marlene Lischwe

SIGNATURE: Marlene Lischwe  
Daniel Lischwe

DATE: 12/29/2019

ADDRESS:

14703 Deerhorn Dr.

To the City of Chesterfield:

I/WE are requesting the removal of the "NO PARKING" signs on Deerhorn Drive. One of these signs is adjacent to my property.

NAME: Erin Stewart

SIGNATURE: 

DATE: 12/29/19

ADDRESS: 14706 Deerhorn Dr.

To the City of Chesterfield:

I/WE are requesting the removal of the "NO PARKING" signs on Deerhorn Drive. This sign is adjacent to my property.

NAME: Trustees

SIGNATURE: See letter 12/31/2019

DATE:

ADDRESS: 14750 / 14759 Deerhorn

To the City of Chesterfield:

I/WE are requesting the removal of the "NO PARKING" signs on Deerhorn Drive.

NAME: LEONARD HORTNER

SIGNATURE: 

DATE: 12-29-19

ADDRESS: 19707 DEERHORN D

To the City of Chesterfield:

I/WE are requesting the removal of the "NO PARKING" signs on Deerhorn Drive.

NAME: G Stephen Brown

SIGNATURE: 

DATE: 12/29/2019

ADDRESS: 14760 Deerhorn Dr

To the City of Chesterfield:

I/WE are requesting the removal of the "NO PARKING" signs on Deerhorn Drive.

NAME: KENNETH JONES

SIGNATURE: 

DATE: 12/29/19

ADDRESS: 1532 Deerhorn Dr

To the City of Chesterfield:

I/WE are requesting the removal of the "NO PARKING" signs on Deerhorn Drive.

NAME: ANN JONES

SIGNATURE: 

DATE: 12/29/19

ADDRESS: 1532 Deerhorn Dr

To the City of Chesterfield:

I/WE are requesting the removal of the "NO PARKING" signs on Deerhorn Drive.

NAME: *James W. Struthen*  
James W. Struthen

SIGNATURE: *James W. Struthen*

DATE: 12/29/2019

ADDRESS: 1510 Deerhorn Dr.

To the City of Chesterfield:

I/WE are requesting the removal of the "NO PARKING" signs on Deerhorn Drive.

NAME: TERRY ISAAC

SIGNATURE: *Terry Isaac*

DATE: 12-29-19

ADDRESS: 1517 DEERHORN  
CHESTERFIELD, MO



To the City of Chesterfield:

I/WE are requesting the removal of the "NO PARKING" signs on Deerhorn Drive.

NAME: Ryan, Shane

SIGNATURE: Refused

DATE:

ADDRESS: 14711 Deerhorn Dr.

To the City of Chesterfield:

I/WE are requesting the removal of the "NO PARKING" signs on Deerhorn Drive.

NAME:

SIGNATURE:

DATE:

ADDRESS:

**CITY OF CHESTERFIELD  
POLICY STATEMENT**

**PUBLIC WORKS**

**NO.** 25

**SUBJECT** Parking Restrictions

**INDEX** PW

**DATE** 2/20/02

**DATE** 5/01/2017

**ISSUED**

**REVISED**

**POLICY**

**Federal, State and County Roadways**

All requests for parking restrictions on Federal, State and County roads will be forwarded to the appropriate agency for their consideration and approval.

**City Public Streets - Subdivision**

All resident requests for parking restrictions on City of Chesterfield Public Streets, within a subdivision, must be submitted in writing to the City Engineer. The request will be forwarded to the appropriate subdivision trustees, who, if they support the request, must survey, or otherwise verify to the City Engineer that there exists among the residents a 75% level of support within the general area for the parking restriction, and a 90% level of support among property owners immediately adjacent to the area where parking restrictions are proposed. Immediately adjacent refers to those properties that have frontage where parking is to be restricted on the same side of the street or on the opposite side of the street.

For the purpose of this policy, the "general area" is defined as the area within the subdivision and a 500 foot radius of the proposed parking restriction. If the parking restriction is proposed on a cul-de-sac, the general area is limited to those residents who have driveway access on the street containing the cul-de-sac.

If the required levels of support are met, a draft of an ordinance calling for the parking restriction shall be submitted to the Planning and Public Works Committee for review and then, if approved by the Committee, forwarded to City Council for consideration.

If the required levels of support are not met, the Department of Public Works shall review the request and prepare a recommendation based upon traffic engineering principles and forward same to the Planning and Public Works Committee for review and consideration. Said recommendation shall include the original written request, data provided by the Trustees, traffic volumes, and accident history.

**City Public Streets – Non-Subdivision**

All requests for parking restrictions on City Public Streets that are not located within a subdivision must be submitted in writing to the City Engineer. The Department of Public Services shall then conduct a survey of those property owners who are immediately adjacent to the area where parking restrictions are proposed. A 75% level of support among property owners immediately adjacent to the area where parking restrictions are proposed is required. If the required levels of support are met, a draft of an ordinance calling for the parking restriction shall be submitted to the Planning and Public Works Committee for review and then, if approved by the Committee, forwarded to City Council for consideration.

If the required levels of support are not met, the Department of Public Services shall review the request and prepare a recommendation based upon traffic engineering principles and forward same to the Planning and Public Works Committee for review and consideration. Said recommendation shall include the original request, the survey of the adjacent property owners, traffic volumes, and accident history.

**City Private Streets**

Any resident requesting a parking restriction on a private street shall be notified that the street is private and referred to the street owner or subdivision trustees.

Per the codified ordinances of the City of Chesterfield, the obligation and responsibility for installation and maintenance of appropriate traffic control devices rests with the City Engineer. This policy shall in no way interfere with the obligations assigned to the City Engineer by the Traffic Code.

**RECOMMENDED BY:**

 3/1/2017 PPW Committee 3/23/2017  
Department Head/Council Committee (if applicable) Date

**APPROVED BY:**

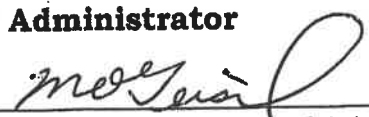
\_\_\_\_\_  
City Administrator  
  
\_\_\_\_\_  
City Council (if applicable) 5/1/2017  
Date