

Architectural Review Board Staff Report

Project Type:	Architectural Specialty Lighting Package
Meeting Date:	January 09, 2020
From:	Mike Knight, Assistant City Planner <i>JmK</i>
Location:	North side of North Outer 40 Road and east of Boone's Crossing
Description:	<u>Chesterfield Outlets (The District) ASLP:</u> Architectural Specialty Lighting Package for a 48.2 acre tract of land zoned "PC" Planned Commercial District located north of North Outer 40 Road east of Boone's Crossing (17T420027).

PROPOSAL SUMMARY

This is a request for an Architectural Specialty Lighting Package within the Chesterfield Outlets subdivision commonly known as (The District). Specifically, this lighting package is seeking approval for the application of blue lighting in the form of exterior parapet mounted blue linear LED to illuminate the varied parapets and blue accent wall mount downlighting on one specific building within the development. Although this submittal solely focusses on one building (Recreational Facility), the specialty lighting package is for the entire Chesterfield Outlets development (The District). If approved, future tenants of The District would have to amend this lighting package to request specialty architectural lighting.



Figure 1: Aerial

HISTORY OF SUBJECT SITE

St. Louis County zoned the subject site “NU” Non-Urban District in 1965. On November 21, 2011, the City of Chesterfield approved Ordinance 2682, which zoned the subject site from a “NU” Non-Urban District to a “PC” Planned Commercial District. Subsequent to the change in zoning, a Site Development Plan was submitted proposing a 472,282 square foot outlet retail center on the site. The plan was approved by the City of Chesterfield on March 26, 2012.

In May of 2019, City Council approved the current governing ordinance, City of Chesterfield Ordinance 3049. The primary purpose of this ordinance amendment was to establish a maximum height of 60 feet for the pavilion and indoor theater uses.

In October of 2019 an Amended Site Development Plan for the construction of Phase 1 of the entertainment district known as “The District” was approved by Planning Commission. Phase 1 has three primary components: an indoor theatre, a parking garage, and a 48,559 square foot recreational facility. Although the request for the specialty lighting package solely focusses on amendments to lighting for the recreational facility (Building N), the specialty lighting package encompasses “The District” as a whole.

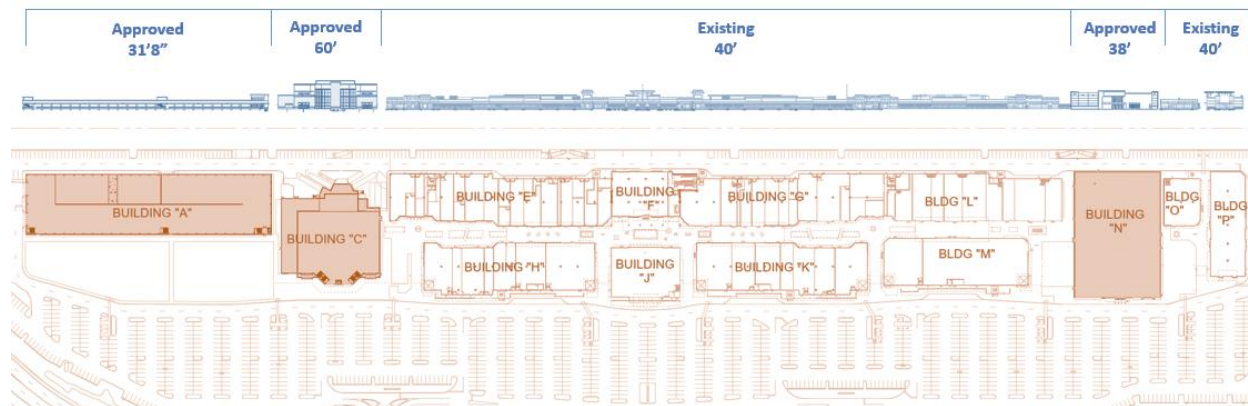

Figure 2: The District Phase 1

REQUEST OVERVIEW

The Amended Site Development Plan (ASDP) for The District was approved in 2019. A lighting plan was included within the ASDP. The approved fixtures for the recreational facility are all static white in the form of both wall packs around the whole building and a linear grazer on the front and sides. This request is seeking approval for the use of blue linear LED lighting to illuminate the varied parapets and exchange 12 static *white* wall mounted fixtures with *blue* wall mounted fixtures. The specialty lighting updates are on the highly visible south, east, and west facades, but no updates from the approved Lighting Plan exist on the rear of the recreational facility building.

STAFF ANALYSIS

The Unified Development Code (UDC) allows for Architectural Specialty Lighting Packages (Sec. 31-04-03.C). Specialty architectural lighting is defined as lighting applications located on the exterior or visible from the exterior of a building that highlight and accentuate certain portions, features, or entire facades of a building or structure and that may utilize non-traditional colors, motion, or other similar features. The use of such lighting transforms the architecture rather than simply embellishing it; architectural elements may be designed specifically for the specialty lighting application. Lighting that uses projection to display logos, text, animations, holograms, etc., shall be classified as signage. The UDC also defines that the **purpose of an architectural specialty lighting package is to provide comprehensive, complementary and unified architectural specialty lighting throughout a single development.**

Review factors include color, intensity, impact on surrounding properties, and accentuation of architectural features of a development. As this request is for specialty lighting, specifically for blue lighting visible from I-64, all other light fixtures on the property would be required to comply with the regulations established in the Unified Development Code.

The UDC provides several considerations for Architectural Specialty Lighting Packages (**bold**):

- **Architectural specialty lighting should highlight and accentuate traditional building detailing and architectural features. Additionally, precise lighting applications should highlight distinctive architectural features.**

The blue linear LED lighting the applicant has requested will illuminate the varied parapets and blue accent wall mount downlighting on one building within the development. Below is the proposed application of lighting on a rendering of the front façade at night (Figure 3).



Figure 3: Rendering – Front Facade

- **The color temperature of architectural specialty lighting should underscore the building materials and character. Additionally, architectural specialty lighting should be unobtrusive in intensity and should not turn a building into an attention-getting device or blanket signage.**

The color pallet of both the existing buildings and the buildings to be constructed in Phase 1 within The District primarily consist of earth tones. The architect’s statement of design for The District states that “Vintage Industrial” is the architectural style for the development.

The applicant states in their submittal that: *“Neon lighting, particularly blue, was a pinnacle part of commercial buildings / branding in the 40s and 50s, the same time as manufacturing was booming – hence the era of industrial design was born. The natural elements; water and the sky are perfect examples of blue found in nature”. Also, “Metallic hues of zinc and cobalt metal are both natural elements and have a bluish hue”.*

- **All proposed light fixtures should be permanently mounted.**

All of the proposed fixtures within the approved lighting plan and the proposed Specialty Lighting Package are to be permanently mounted.

- **Architectural specialty lighting shall not interfere with or obscure the public's capacity to receive information, or cause visual confusion by interfering with pedestrian or vehicular traffic. Architectural specialty lighting shall conform to the character of the community, enhance the visual harmony of development, and preserve the public health, convenience, welfare and/or safety within the City of Chesterfield by maintaining the high aesthetic quality of the community.**

The District parallels Interstate 64 and North Outer 40 Road. The buildings are set back roughly 300 feet from right of way of North Outer 40 Road and 485 feet from the centerline of Interstate 64. The proposed occupant of the recreational facility, “Main Event”, has various locations around the country, some with similar lighting. Below (Figure 4) are photographs of a similar lighting package within a different community.



Figure 4: Photographs – Existing Building in a Different Community

Chesterfield Valley Design Policies: The City of Chesterfield’s Comprehensive Plan has a specific Chesterfield Valley Policies Element. The policies include commercial development with particular concern over the image presented by development along I-64. There are six specific policies of which two are applicable to the design of this project. Staff outlines the applicable policies below.

Policy 1: Facades of Buildings Along I-64 and Arterial Roadways – Care should be taken to make sure that any portion of a building is equally uniform in materials and attractiveness as the primary facade. The intent is to avoid projects having their view from I-64/US 40 or the roadways appear to be the rear or side of a development.

The primary view of the entertainment district would be from the south, east, and west as one would see the buildings driving east to west/ west to east along I-64 and North Outer 40 Road. Rivers Edge Park and the Levee Trail system are located directly to the north of the subject site.

Policy 2: Lighting of Buildings Along I-64/US 40 - The facades of buildings facing I-64 should be lighted to provide an attractive image at night for individuals traveling along I-64.

The approved lighting plan currently consists of both static white decorative and utilitarian lighting. The blue color is the only color being requested other than the previously approved white lighting and is also static in nature. Although the request for the specialty lighting package solely focusses on amendments to the lighting for the recreational facility, the specialty lighting package is for “The District” as a whole.

DEPARTMENTAL INPUT

Staff is requesting a recommendation from the Architectural Review Board (ARB) on the Specialty Lighting Package proposed for Chesterfield Outlets (The District). All recommendations made by the ARB will be included in Staff’s report to the Planning Commission. Attached is the architectural specialty lighting package submittal containing the approved color elevations with the application of lighting for all facades, additional renderings at night, photos of other locations with similar lighting, photos of adjacent development, and the architect’s statement of design.

MOTION

The following options are provided to the Architectural Review Board for consideration relative to this application:

- 1) “I move to forward the Architectural Specialty Lighting Package for Chesterfield Outlets (The District), as presented, with a recommendation for approval (or denial) to the Planning Commission.”
- 2) “I move to forward the Architectural Specialty Lighting Package Chesterfield Outlets (The District) to the Planning Commission with the following recommendations...”

Attachments

1. Architectural Specialty Lighting Package Submittal

MAIN EVENT

December 23, 2019

City of Chesterfield Planning
Architectural Review Board – Specialty Lighting
Mike Knight, Senior Planner
690 Chesterfield Parkway West
Chesterfield, MO 63017

Architectural Review Board – Specialty Lighting

RE: The District - Main Event Entertainment, 17027 North Outer 40 Road, Chesterfield, MO 63005

Dear Mr. Knight,

Please let this submittal package serve as official formal submittal of 15 packets for the Specialty Lighting/ARB approval on the above referenced site.

The following has been included in all packets:

- Architectural Review Board application
- Architectural Specialty Lighting Package Application
- Updated narrative to the Architectural Specialty Lighting Package, including purpose, scope, design, and consistency with the development's architectural themes.
- Previously Approved Photometric Sheet S-5
- Detailed, high-resolution, color elevations drawn to scale containing proposed updated architectural specialty lighting fixtures
- Photographs of existing Highlands Ranch facility showing all existing architectural specialty lighting fixtures – canopy lighting, blue parapet lighting, blue accent lighting
- Photometric plan showing location of updated fixtures and the type of illuminating devices, fixtures denoting foot-candle levels on all impacted building elevations and adjacent ground areas
- A cut sheet for each proposed fixture and associated shielding
- Shielding detail for blue parapet lighting
- Photographs of adjacent properties

Should you need anything further, please feel free to reach out to me directly.

Respectfully,

Angel Robinson | Property Development Manager
Office. 469-661-2644; Cell: 817-437-5563



December 20, 2019

City of Chesterfield Planning
Architectural Review Board – Specialty Lighting
RE: Main Event Entertainment, 17027 North Outer 40 Road, Chesterfield, MO 63005

Introduction:

Main Event Entertainment is excited to be a part of the reimagining of the old Taubman Outlet Mall. The District project will provide a forum to bring people together to eat, drink, shop and play in a convenient one-stop center. The development is proposing to combine a variety of uses bringing vitality to the area while providing young and old from Chesterfield and the metropolitan St. Louis area with a safe, convenient and fun place to gather.

The development will be done in phases and when the development is completed the central portion of The District, under the main steel structure of the development, will be a communal area with a stage and open space to be used for concerts and a variety of entertainment options. Main Event Entertainment will be a key family-friendly entertainment choice within The District, offering a unique family entertainment experience for customers.

Site Relationship:

The District is located on North Outer 40 just west of the Top Golf development and east of the Boone's Crossing bridge. Surrounding the development is The Midwest Bank Building, proposed Hotel and Top Golf. Main Event Entertainment will occupy a shell building being constructed by TSG Chesterfield Lifestyle, LLC (shopping center owner) at 17027 North Outer 40 Road, Chesterfield, MO 63005. The Main Event building location is identified as proposed Building N in the 3rd Amended Site Development Plan for The District, recorded 10/23/19.

We believe the blue neon lighting strip on The District fits well with the vintage industrial design style of The District. Neon lighting, particularly blue, was a pinnacle part of commercial buildings/branding in the 40s and 50s, the same time as manufacturing was booming – hence the era from which industrial design was born. Neon has enthralled generations of people for close to 100 years and we think it will be a perfect decorative element to help light up the exterior of The Main Event in The District. Furthermore, in the Design Criteria for The District, we specified a color palette depicting natural elements; water and the sky are perfect examples of blue found in nature. We also specified metallic hues and Zinc and cobalt metal, both natural elements, have a bluish hue. For these reasons, we believe the blue color in Main Event's Lighting package is acceptable for display in The District.

Purpose of Application:

The purpose of this application is to update the exterior lighting proposed on the building.

MAIN EVENT

Building Lighting:

Main Event strives to incorporate architectural elements in the building design that accentuate both the variety of materials used in building design, as well as the entertainment offered inside. A key component in architectural elements is tasteful lighting that lends itself to the “entertainment excitement” families will experience within The District and inside the building. It will provide a visually appealing and definable design. All lighting will be situated with no direct cast on adjoining properties or roadways, and it is static lighting. Lighting for the building is controlled by a photocell. Typically, it is on from 15 minutes prior to dusk to 1.5 hours after close of business. Business hours are as follows:

- Monday and Friday - 11 a.m. - 2 a.m.
- Sunday, Tuesday - Thursday - 11 a.m.-12 a.m.
- Saturday 9 a.m. - 2 a.m.

Exterior parapet mounted blue linear LED lighting is incorporated into the design to illuminate the varied parapets on the building. Lights are full cut off at 30 degrees and above with no uplighting towards the sky. A shield is incorporated into the parapet design to prevent any light pollution above the parapet line. Night photos of an existing location in Highlands Ranch, CO have been included. This location has incorporated the parapet lighting shield in the building design. A photometric elevation has also been included to demonstrate the lighting effect of the LED parapet lighting, as well as the technical data sheet and detail of lighting shield

Blue accent lighting (EL-1) is a key design component in that it accents the varied building materials proposed on the front and side facades. Canopy lighting (EL-2) is also provided for pedestrian safety and emergency lighting. A cut sheet with photometric data is included for fixtures shown on the provided photometric plan.

Respectfully,



Angel Robinson | Property Development Manager

Office: 469-661-2644

Cell: 817-437-5563



690 Chesterfield Pkwy W • Chesterfield MO 63017-0760
Phone: 636-537-4000 • Fax 636-537-4798 • www.chesterfield.mo.us

**The City of Chesterfield is committed to excellence
in service and overall quality of life:
By being the City of Choice in the St. Louis Region
within which to live, work, play, and visit.**

- City of Chesterfield Mission Statement

The Planning Commission and the Department of Planning and Development Services strive for the above in the review of projects presented to the City of Chesterfield for development. To assist with this process, the Architectural Review Board was established in 1998.

The terms and provisions of the Architectural Review Standards ([Section 04-01 of the Unified Development Code](#)) shall apply to all vacant or undeveloped land and all property to be redeveloped including additions and alterations. Projects will be reviewed by the Architectural Review Board (ARB) to provide recommendations to the Planning Commission and Department of Planning and Development Services.

The Planner assigned to your development project will notify you when the project is ready for submission to the ARB. This may be upon completion of the first full review by the City or upon resubmittal after comments raised by the City have been addressed if said comments will impact the site layout or design. The Planner will work with you and advise you on the appropriate agenda review date for your project.

To aid you in preparing an item for review, the attached information has been developed:

- Project Statistics and Checklist
- Architectural Review Standards

To ensure you have everything you need for ARB review, once the project is ready for ARB submittal, you will be notified by your Project Planner to submit one copy of your full ARB application for review. **This review is done to ensure you have everything you need prior to submitting the required fourteen (14) copies necessary for the meeting. Again, your Project Planner will notify you of all submittal deadline dates as they assist you through this process.*

All items requested must be submitted by the date provided to you by your assigned Planner in order to have the project placed on the ARB's agenda.

If you have questions about the architectural review process, contact your assigned Project Planner, or contact the Planner of the Day at 636-537-4733 or pod@chesterfield.mo.us

Thank you



**ARCHITECTURAL REVIEW BOARD
Project Statistics and Checklist**

Date of First Comment Letter Received from the City of Chesterfield _____

Project Title: Main Event Entertainment in The District **Location:** 17027 North Outer 40 Road

Developer: TSG Chesterfield Lifestyle **Architect:** Chiodini Architects **Engineer:** _____

PROJECT STATISTICS:

Size of site (in acres): 48.15overall **Total Square Footage:** 48,559 **Building Height:** Varies

Proposed Usage: Family Entertainment

Exterior Building Materials: Brick, stone, EIFS, metal panels, Concrete Tilt-up walls

Roof Material & Design: Membrane roof system over rigid insulation

Screening Material & Design: Perforated metal panels on steel structure

Description of art or architecturally significant features (if any): architectural accent lighting

ADDITIONAL PROJECT INFORMATION:

Checklist: Items to be provided in an 11" x 17" format

- Color Site Plan with contours, site location map, and identification of adjacent uses.
- Color elevations for all building faces.
- Color rendering or model reflecting proposed topography.
- Photos reflecting all views of adjacent uses and sites.
- Details of screening, retaining walls, etc.
- Section plans highlighting any building off-sets, etc. (as applicable)
- Architect's Statement of Design which clearly identifies how each section in the Standards has been addressed and the intent of the project.
- Landscape Plan.
- Lighting cut sheets for any proposed building lighting fixtures. (as applicable)
- Large exterior material samples. (to be brought to the ARB meeting)
- Any other exhibits which would aid understanding of the design proposal. (as applicable)
- Pdf files of each document required.

ARCHITECTURAL REVIEW DESIGN STANDARDS

Please refer to [Section 04-01 of the Unified Development Code](#) for the Architectural Review Design Standards.

ARCHITECTURAL TERMS

Please refer to [Section 10-06 of the Unified Development Code](#) for definitions of Architectural Terms.

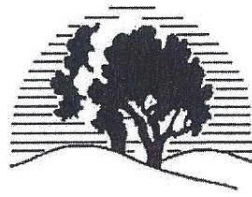

City of Chesterfield

PLANNING & DEVELOPMENT SERVICES

ARCHITECTURAL SPECIALTY LIGHTING PACKAGE APPLICATION

The purpose of an architectural specialty lighting package is to provide comprehensive, complementary and unified architectural specialty lighting throughout a single development or contiguous lots under common ownership. If an architectural specialty lighting package exists for a multi-lot development or subdivision, then individual lots within that subdivision or development may not submit their own, separate architectural specialty lighting package. In addition, developments of a certain size, quality, or mix of uses may require special architectural specialty lighting consideration. Therefore, in order to encourage superior design, quality and character, comprehensive architectural specialty lighting packages allow for specialized review of architectural specialty lighting and flexibility from standard site lighting requirements.

Consideration of flexibility in architectural specialty lighting criteria is based on a number of review factors including, but not limited to, the physical impact of the proposed architectural specialty lighting package, the quality of the proposed architectural specialty lighting package, and mitigation of unfavorable conditions such as excessive lighting, light spillover, height, and other related conditions and potentially negative impacts.

Prior to submitting an application to the Dept. of Planning & Development Services, the Applicant is encouraged to schedule a pre-application meeting to discuss the proposal. To schedule a meeting, contact the Department at (636) 537-4748. For questions about this application, contact the "Planner of the Day" at (636)-537-4733.

I. APPLICANT INFORMATION

Owner(s) of record of the hereinafter described property according to St. Louis County Assessor's

Record: TSG Chesterfield Lifestyle LLC - Tim Lowe

Address: 2127 Innerbelt Business Center Drive; Suite 310

City: St. Louis **State:** MO **Zip:** 63114

Tel.: 314-513-0018 **Fax:**

Applicant, if other than owner(s): Main Event - Angel Robinson

Address: 5445 Legacy Drive; Suite 400

City: Plano **State:** TX **Zip:** 75024

Tel.: 469-661-2644 **Fax:** 972-943-5805

Legal Interest: Tenant for Building N in The District development

(Provide date of contract and date of expiration of contract)

690 Chesterfield Parkway West, Chesterfield, MO 63017-0760
Ph. (636)537-4746 Fax (636)537-4798 www.chesterfield.mo.us

II. PROPERTY INFORMATION

Project Name: Main Event

Locator Number(s): _____

(List additional locator numbers on separate sheet and attach to application)

Acreage: 48.151 (To the nearest tenth of an acre)

Subdivision Name: _____

Plat Book/Page: Book 3567, Page 444-447

Proximity to closest major intersection: Boones Crossing and N Outer 40 Road

Existing Overlay Districts: Check (✓) all that apply C.U.P. C.S.P. L.P.A.
 Other: _____

III. ZONING

Current Zoning District: PC Planned Commercial

Existing Uses(s) on property: Entertainment and Retail Lifestyle Center

IV. ADJACENT PROPERTY

Identify surrounding land uses and zoning designations. Include existing/approved square footage or number of dwelling units, type of units, and density.

Property	Land Use	Zoning	Lighting Package? Y/N	Ordinance No.
North	River's Edge Park	FPNU		
South	Highway 64	PC		
East	Top Golf	PC		
West	Bank Office Building	PC		

V. ARCHITECTURAL SPECIALTY LIGHTING PACKAGE SUBMITTAL

All Applications shall be accompanied by an Architectural Specialty Lighting Package that presents the information below in a clear, concise, and orderly manner.

- 1) A narrative to the Architectural Specialty Lighting Package, including purpose, scope, design, and consistency with the development's architectural themes. The narrative should address how the Architectural Specialty Lighting package promotes superior design, quality and character.
- 2) The narrative shall include a description of the location, illumination level, color, dimensions, mounting height, construction material, hours of use, nature (static, shifting, flashing, blinking, animation, graphics, light patterns, etc.), frequency and duration of lighting shifts/changes, brightness, and type of all proposed architectural accent lighting fixtures.
- 3) Detailed, high-resolution, color elevations drawn to scale of all structures containing proposed architectural specialty lighting fixtures.
- 4) Night view perspectives or renderings.
- 5) Photographs of all existing architectural specialty lighting fixtures.
- 6) Lighting plans indicating the location of all standards and fixtures and the proposed type of illuminating devices, fixtures, lamps, supports, reflectors, and other devices as well as three-dimensional photometric elevations denoting foot-candle levels on all impacted building elevations and adjacent ground areas.
- 7) A cut sheet will be required for each proposed fixture and associated shielding.
- 8) Where shielding is not provided in conjunction with the proposed light fixture, information indicating that no light trespass or sky glow will result from the requested fixture is required.
- 9) Photographs of similar installations or building applications.
- 10) Photographs of adjacent properties.
- 11) Any additional materials as required by the City of Chesterfield.

VI. STATEMENT OF CONSENT

AGENCY CONSENT

I hereby give CONSENT to Angel Robinson - Main Event (type, stamp or print clearly full name of agent) to act on my behalf to submit, this application and all required material and documents, and to attend and represent me at all meetings pertaining to the application(s) indicated above. Furthermore, I hereby give consent to the party designated above to agree to all terms and conditions which may arise as part of the approval of this application.

I hereby certify I have full knowledge of the property and I have an ownership interest and/or am the owner under contract in the subject of this application. I further certify the statements or information made in any paper or plans submitted herewith are true and correct to the best of my knowledge. I understand this application, related material and all attachments become official records of the City of Chesterfield, Missouri, and will not be returned. I understand that any false, inaccurate or incomplete information provided by me or my agent will result in the denial, revocation or administrative withdrawal of this application, request, approval or permits. I acknowledge that additional information may be required to process this application. I further consent to the City of Chesterfield to publish, copy or reproduce any copyrighted document submitted as a part of this application for any third party. I further agree to all terms and conditions which may be imposed as part of the approval of this application.

OWNER/CONTRACT PURCHASER INFORMATION:

I am the owner contract purchaser. (check (✓) one)

Michael Staenberg

(Name- type, stamp or print clearly)

TSG Chesterfield Lifestyle LLC

(Name of Firm)

Attach additional sheets as necessary.



(Signature)

2127 Innerbelt Business Center Drive
ST. Louis, MO 63144

(Address, City, State, Zip)

NOTARY PUBLIC INFORMATION: STATE OF MISSOURI, CITY OF CHESTERFIELD

Before me appears Michael Staenberg who has executed the foregoing instrument was subscribed and sworn to before me this

18th day of November

20 19

Signed

Kimberly Thomas
Notary Public

Print Name:

Kimberly Thomas

Seal/Stamp:

My Commission Expires: 3.28.2023

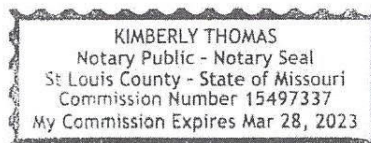

690 Chesterfield Parkway West, Chesterfield, MO 63017-0760
Ph. (636)537-4746 Fax (636)537-4798 www.chesterfield.mo.us

VII. COMPLETENESS AND ACCURACY

INSTRUCTIONS: To be completed by individual submitting application (property owner, applicant with consent, or authorized agent).

Project Name: The District - Main Event **Submittal Date:** _____

I hereby certify all property owners have full knowledge that the property they own is the subject of this application. I hereby certify that all owners and petitioners have been provided a complete copy of all material, attachments and documents submitted to the City of Chesterfield relating to this application. I further certify the statements or information made in any paper or plans submitted herewith are true and correct to the best of my knowledge. I understand this application, related application material and all attachments become official records of the City of Chesterfield, Missouri and will not be returned. I understand that any knowingly false, inaccurate or incomplete information provided by me will result in the denial, revocation or administrative withdrawal of this application, request, approval or permit. I further acknowledge that additional information may be required by the City of Chesterfield to process this application. I further represent and warrant that I have not made any arrangement to pay any commission, gratuity, or consideration, directly or indirectly, to any official, employee, or appointee of the City of Chesterfield with respect to this application. I further consent to the City of Chesterfield to publish, copy or reproduce any copyrighted documents submitted as a part of this application for any third party. I further agree to all terms and conditions which may be imposed as part of the approval of this application.

Consent is required from all property owner(s) and/or contract purchaser, if applicable, for an agent to act if the property owner(s) or contract purchaser does not intend to attend all meetings and public hearings and submit in person all material pertaining to the application. A separate form is required from each owner/contract purchaser. Consent to a firm shall be deemed consent for the entire firm, unless otherwise specified. Consent is valid for one year from date of notary, unless otherwise specified. Attach copy of last recorded warranty deed for subject property.

Check (✓) one: * I am the property owner. I have legal interest in the property.
 I am the duly appointed agent of the petitioner.

Angel Robinson

(Name- type, stamp or print clearly)

Main Event

(Name of Firm)

Angel Robinson
(Signature)
5445 Legacy Drive; Suite 400
Plano, TX 75024

(Address, City, State, Zip)

* Attach additional sheets as necessary.

NOTARY PUBLIC INFORMATION: STATE OF MISSOURI, CITY OF CHESTERFIELD

Before me appears Angel Robinson who has executed the foregoing instrument was subscribed and sworn to before me this

19 day of November

20 19

Signed *[Signature]*
Notary Public

Print Name: Courtney Poteete

My Commission Expires: 9-7-22

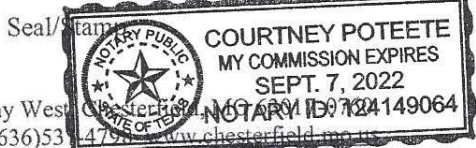

690 Chesterfield Parkway West
Ph. (636)537-4746 Fax (636)537-4750

VIII. PARTIES OF INTEREST

Principal Contact: Angel Robinson Title: Property Development Manager
Address: 5445 Legacy Drive; Suite 400
City: Plano State: TX Zip: 75024
Tel.: 469-661-2644 Fax: 972-943-5805
Email: angel.robinson@mainevent.com

Other Contact: Tim Lowe
Address: 2127 Innerbelt Business Center Drive; Suite 310
City: St. Louis State: MO Zip: 63114
Tel.: 314-513-0018 Fax:
Email: tlowe@tsgproperties.com

Other Contact: Michael Chiodini
Address: 1401 South Brentwood Blvd; Suite 575
City: St. Louis State: MO Zip: 63144
Tel.: 314-561-6525 Fax:
Email: mchiodini@chiodini.com

Other Contact:
Address:
City: State: Zip:
Tel.: Fax:
Email:

Attach additional sheets as necessary.

IX. FEES

The filing fees for an application for review of architectural specialty lighting package submissions shall be based on the information below:

- 1. A new architectural specialty lighting package or modification of an existing architectural specialty lighting package will require a non-refundable fee of \$50.00.

STAFF USE ONLY

Planner: Intake Date:
[] Application NOT Sufficient (date) [] Application Sufficient (date):
Entered into Project List:

690 Chesterfield Parkway West, Chesterfield, MO 63017-0760
Ph. (636)537-4746 Fax (636)537-4798 www.chesterfield.mo.us



#	Date	Comments

Revisions	

Drawn By: LU
 Checked By:
 Date: 8/29/2019
 Scale: None

THE DISTRICT - Main Event
 Chesterfield, MO
 SP-5

Luminaire Schedule						
Symbol	Qty	Label	Arrangement	Total Lamp Lumens	LLF	Description
□	19	EL3	SINGLE	N.A.	0.900	GPC-AF-01-LED-E1-T2-7030-600
•	10	X3	SINGLE	N.A.	0.900	XTOR1B-W
⊥	3	EL4	GROUP	N.A.	0.900	LED Linear - Kalypso Linear Grazer

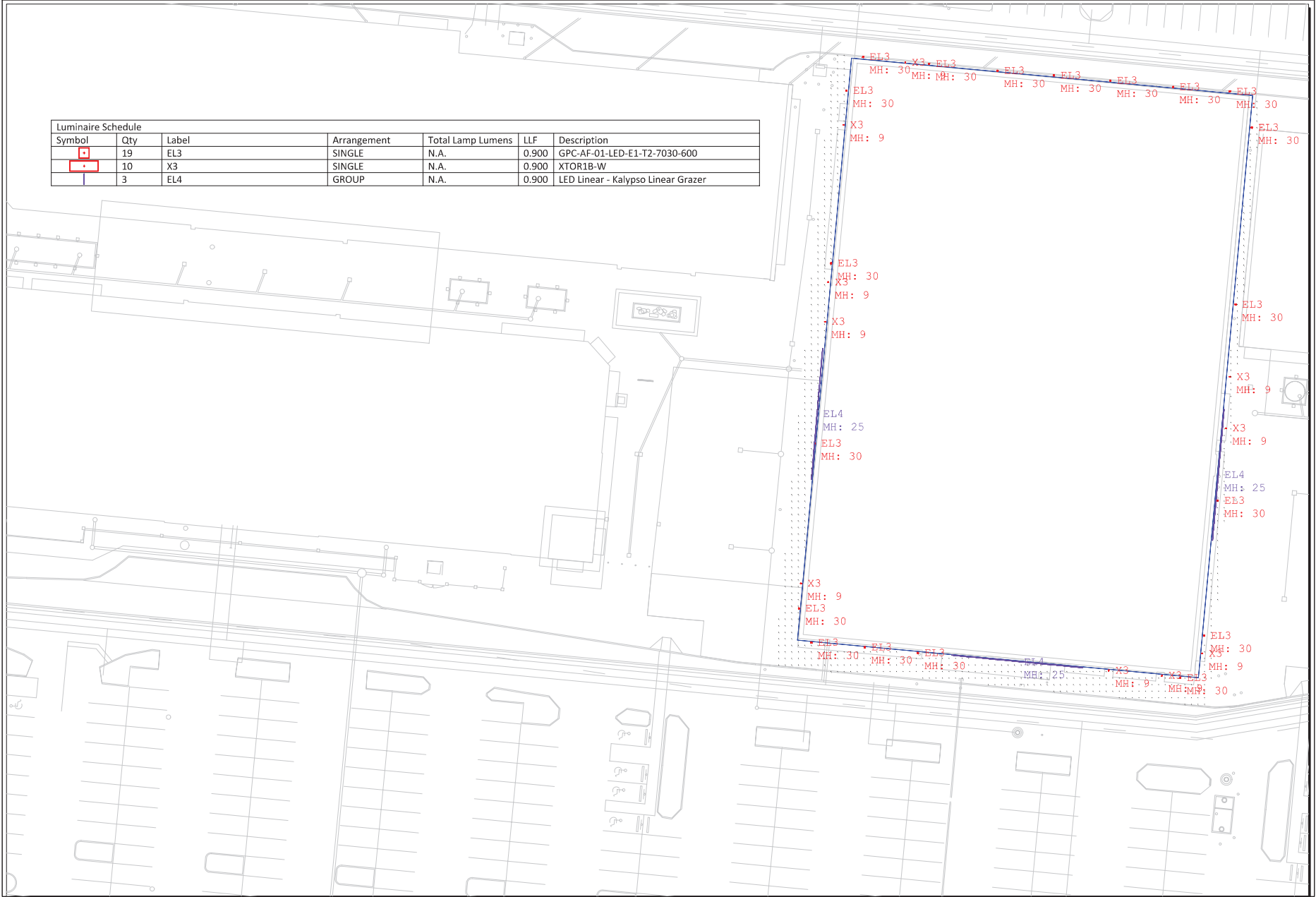

MAIN EVENT



FRONT ELEVATION



SIDE ELEVATION 4

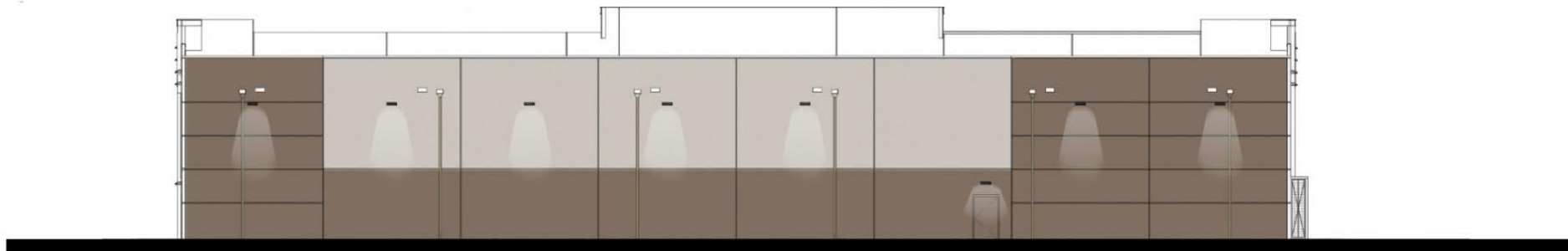

REAR ELEVATION



SIDE ELEVATION 2



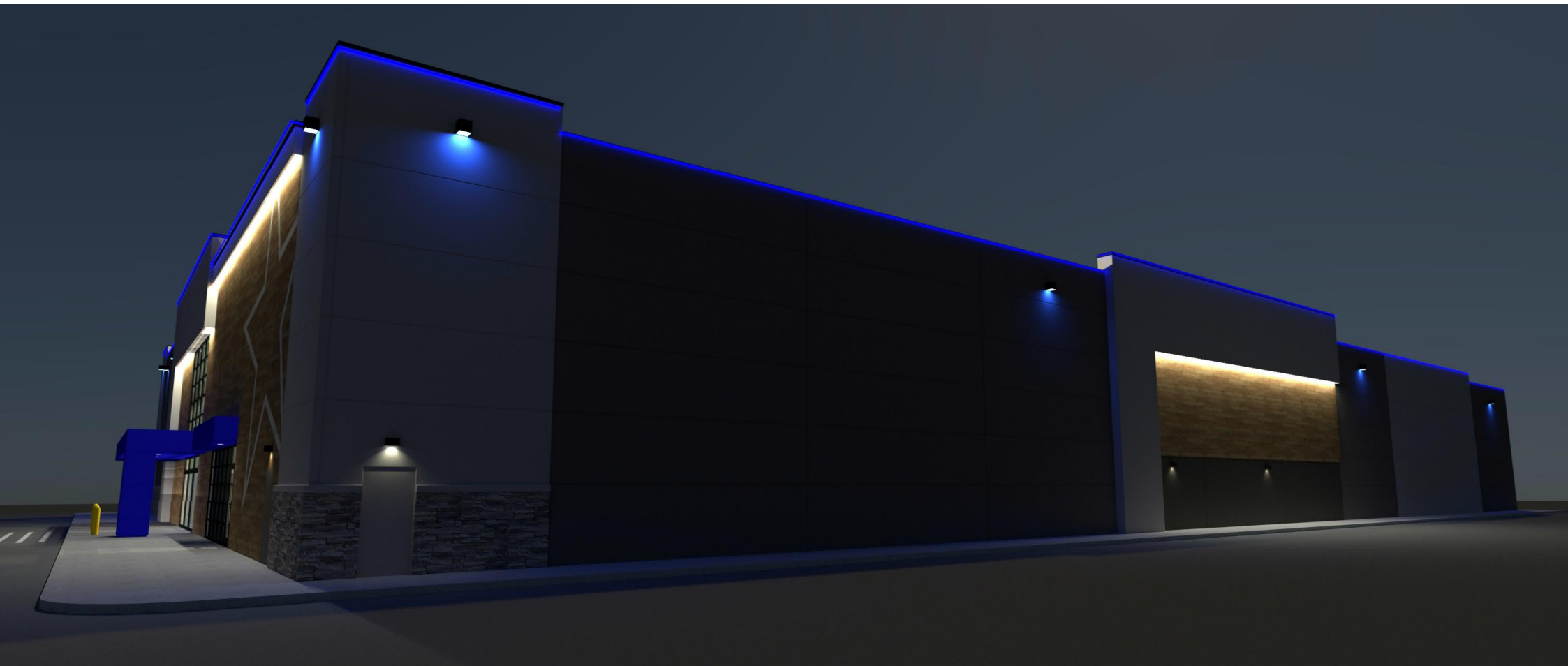

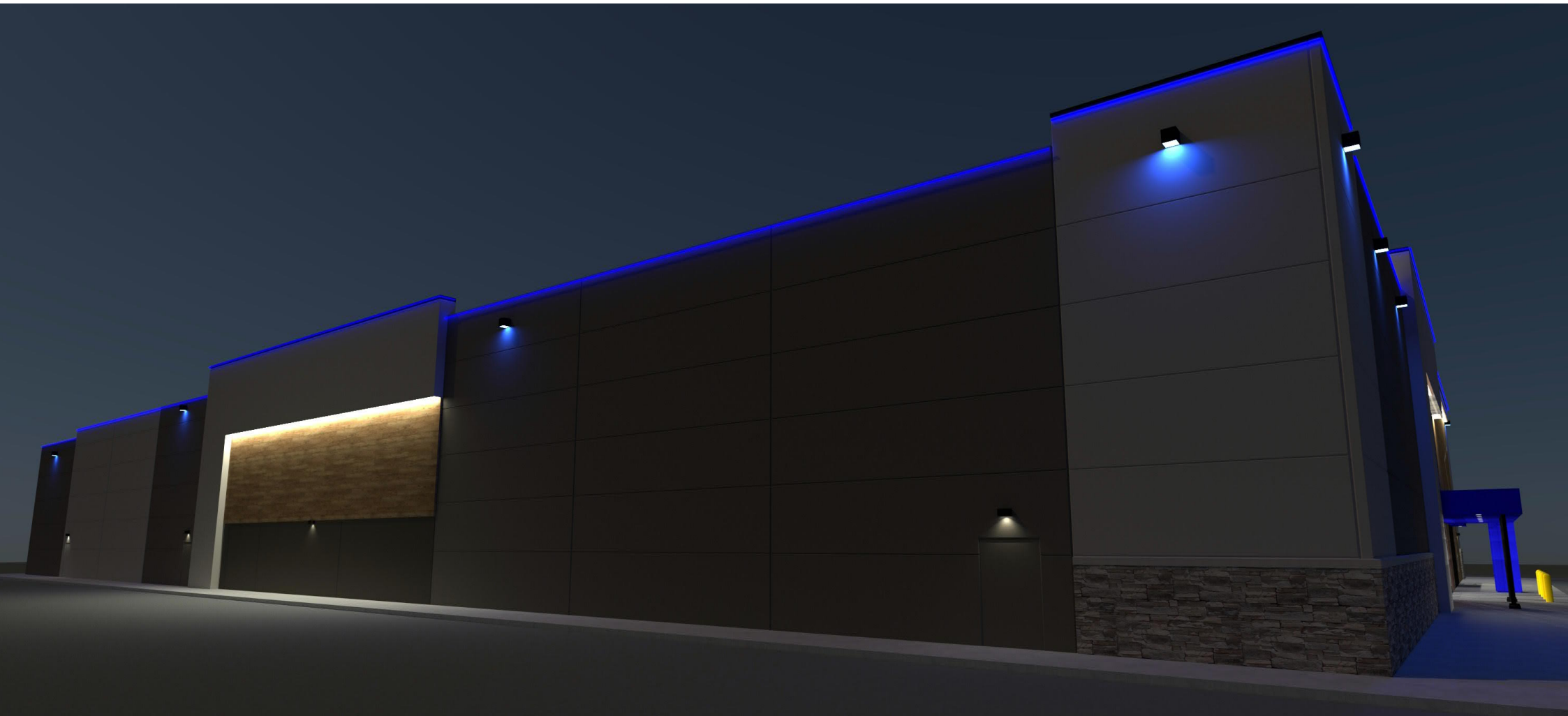

MAIN EVENT
ENTERTAINMENT



MAIN EVENT
ENTERTAINMENT







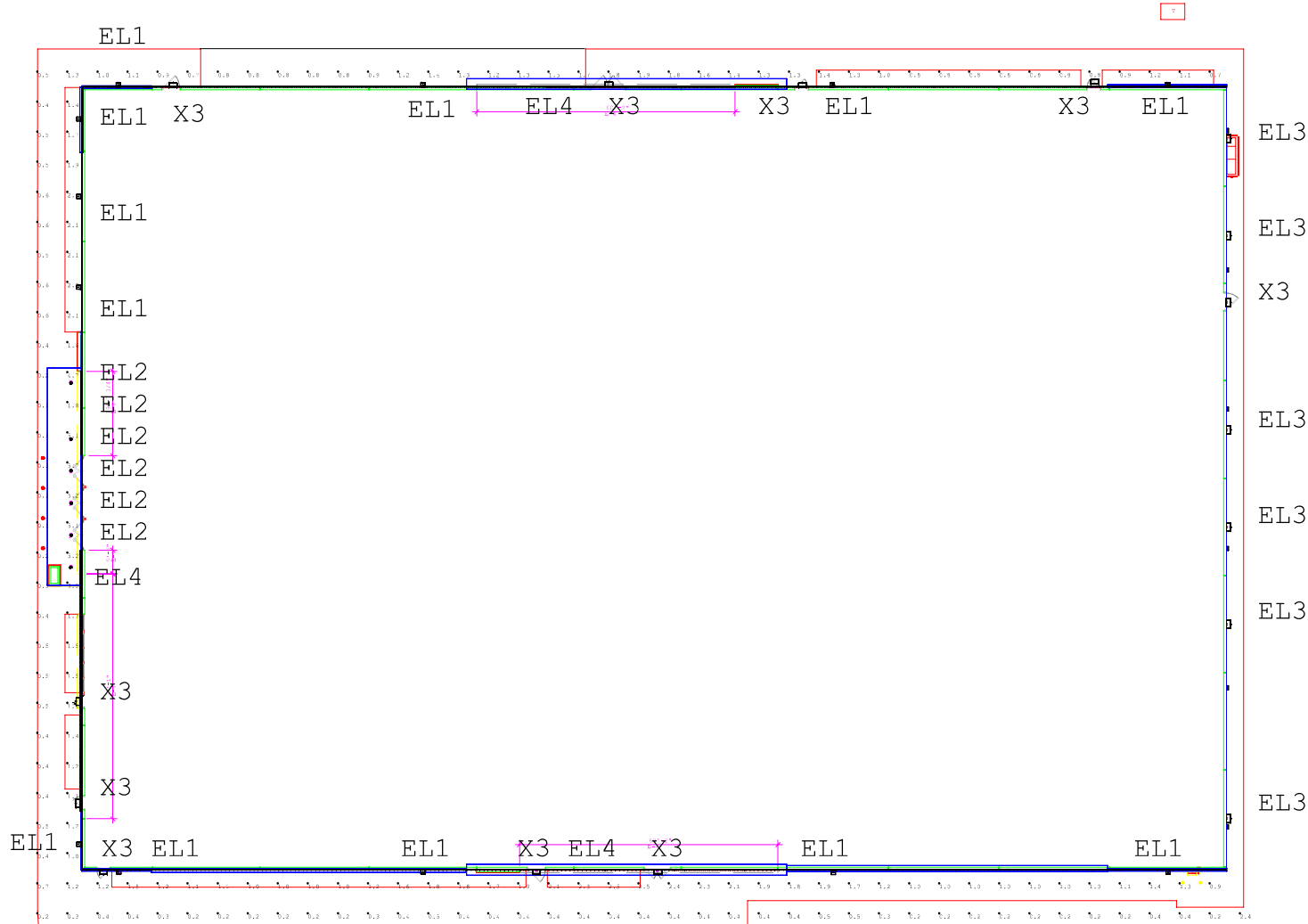

Luminaire Schedule			
Symbol	Qty	Label	Description
⊙	6	EL2	INTENSE LIGHTING: IHOL-6DR-L2-30-D10-40 (HOUSING) INTENSE LIGHTING: IRD602-C-SF-CR (TRIM)
□	10	X3	LSI: XWM 2 LED 03L 30 UE BLK BB
■	12	EL1	FC LIGHTING: FCW1010-120V/277V-BLUE-BK-LD
⌋	3	EL4	ECOSENSE: L50-E-12-12-27-80-MULT-9x59 ACCESSORIES BELOW AS NEEDED: ECOSENSE: CBL-3P-L-UNV-10 (10' LEADER)
⌋	6	EL3	LSI: XWM 2 LED 03L 30 UE BLK
⌋	741LF	BLUE LED	GEBLXNLE1

X3 OFF - NO LIGHT WILL EXTEND BEYOND BUILDING ELEVATIONS

Based on the information provided, all dimensions and luminaire locations show represent recommended positions or positions provided by third party. The engineer and/or architect have the sole responsibility to determine applicability of the layout to existing or future field conditions.
 This lighting pattern represents illumination levels calculated from laboratory data taken under controlled conditions utilizing current industry standard lamp ratings in accordance with IES approved methods. Actual performance of any manufacturer's luminaire may vary due to variation in electrical voltage, tolerance in lamps and other variable field conditions.

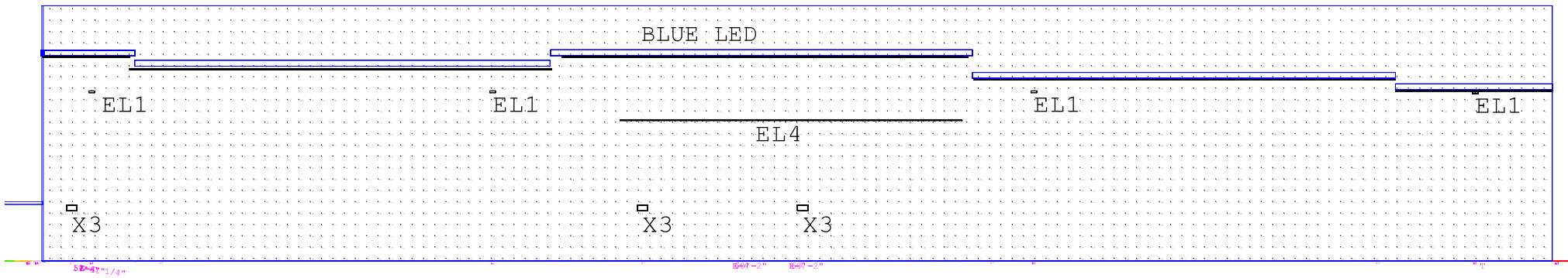

NO LIGHT WILL EXTEND BEYOND BUILDING ELEVATIONS

BLUE LED

EL1

EL1

EL1

EL4

EL4

EL1

EL2

EL2 EL2 EL2 EL2 EL2 EL2

X3

X3

u161.L-463

u87r9

u1-k7g

60-2"

60-2"

NO LIGHT WILL EXTEND BEYOND BUILDING ELEVATIONS

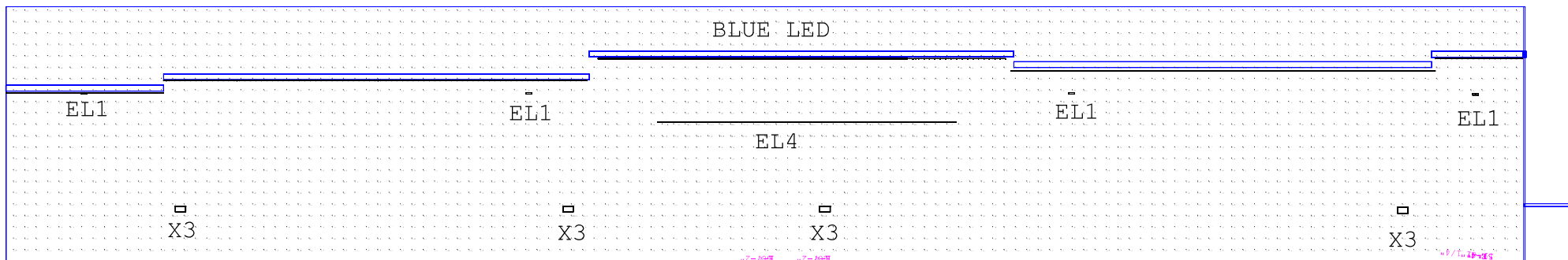

NO LIGHT WILL EXTEND BEYOND BUILDING ELEVATIONS



Date:	Approved:
Type:	
Fixture:	
Project:	

FCW1010

Die-Cast Aluminum Exterior Architectural Wall Mount.



ORDERING

EXAMPLE: FCW1010-277V-LED-3K-3000-SL-F-SB

SERIES	VOLTAGE	SOURCE/TEMPERATURE	LED LUMENS	FINISH	ACCESSORIES
FCW1010	120V 277V	LED BLUE HID 39W MH G12 70W MH G12 PL 2/13Q 2/26Q 2/32Q 2/42T 57T	3750 Lumens (54W Max)	BK Black BZ Bronze CC Custom Color SL Silver WH White	LD LED Dimming (0-10V) D Dimming (0-10V) PE Photo Eye BBU Emergency Backup, Remote (PL only, LED△) F Fuse PCL Polycarbonate Lens (PL or LED only) QR Quartz Re-Strike (HID ballast only) SB Sand-Blasted Lens

SPECIFICATION

MOUNTING

- Mounts directly to standard outlet box. Additional mounting holes allow unit to be attached directly to mounting surface.
- Installation:** <http://tinyurl.com/heg4zcc>

CONSTRUCTION

- Corrosion resistant heavy gauge aluminum. Die-formed and seam welded for solid construction.
- Lens is 1/8" thick, clear tempered glass. Sand-blasted lens optional.
- Neoprene continuous closed cell gasket to seal out contaminants. Captive stainless steel, tamper resistant hex socket screws.

LED

- Lumens stated are the minimum delivered out of the luminaire. LED lifetime is greater than or equal to 70,000 hours with the lumen depreciation greater than L70. All of our luminaires are tested to LM 80 with a CRI of 80+ and color consistency of step 4 MacAdam Ellipse. Integral power supply standard. Input voltage 120V or 277V. Consult factory for dimming, all RGB color changing and any single color options.

FINISH

- Six stage chemical pre-treatment process that includes iron phosphate, to prepare the substrate for a UV stable, super durable standard polyester powder coat.

ELECTRICAL

- Socket** PL: Four pin plug-in type compact fluorescent lamp holder (*lamp by others*). HID: G12 base pulse rated 4KV porcelain socket.
- Ballast** PL: Fluorescent high power factor electronic, UL listed ballast standard. HID: Electronic ballast standard. Ballast has a manufacturer issued 5 year warranty. Electronic universal voltage 120V or 277V is standard. Please consult factory for other voltage options.

LISTING

- ETL, U.S. and CA listed for wet location down position only; damp listing for up position. IP54 rating.

FC Lighting, Inc. reserves the right to change details or specifications without notice. Product use certifies agreement to FC Lighting's terms and conditions.

© 2017. FC Lighting, Inc. 3609 Swenson Ave., St. Charles, IL 60174 p. 800-900-1730 f. 630-889-8106 www.fcighting.com

RF Rev. 1217



Client:		Type: EL1
Fixture Manufacturer: FC LIGHTING	Lamp Manufacturer: N/A	
Cat #: FCW1010-120V/277V-BLUE-BK-LD	Cat #: N/A	
Capitol Light is not responsible for inaccuracies in manufacturers published specifications		



PHOTOMETRY

FCW1010

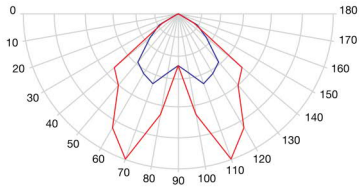

DIMENSIONS

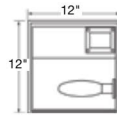

FC Lighting, Inc. reserves the right to change details or specifications without notice. Product use certifies agreement to FC Lighting's terms and conditions.

© 2015. FC Lighting, Inc. 3609 Swenson Ave., St. Charles, IL 60174 p. 800-900-1730 f. 630-889-8106 www.fclighting.com

JR Rev. 1115



Client:		Type: EL1
Fixture Manufacturer: FC LIGHTING	Lamp Manufacturer: N/A	
Cat #: FCW1010-120V/277V-BLUE-BK-LD	Cat #: N/A	
Capitol Light is not responsible for inaccuracies in manufacturers published specifications		

IHOL-6DR / IRD602

6" Gravity LED Lensed Downlight - Wet Location

JOB NAME	CATALOG NUMBER
NOTES	TYPE

ELECTRICAL DATA

LED Light Engine	System Wattage *	CCT / CRI	Delivered Lumens **
M1	12W	3000K / 82 CRI	900lm
M2	25W	3000K / 82 CRI	1700lm
L1	35W	3000K / 82 CRI	2300lm
L2	46W	3000K / 82 CRI	3100lm
L3	60W	3000K / 82 CRI	4600lm
L4	75W	3000K / 82 CRI	5500lm
L5	93W	3000K / 82 CRI	6400lm

* System Wattage include driver and LED Module consumption.

** Delivered lumen output will vary depending on CCT, CRI, optic and lens type.

FEATURES

- Architectural wet location rated luminaire
- Uses same high quality trims throughout Gravity family for a consistent look

LED LIGHT ENGINE

- 12W, 25W, 35W, 46W, 60W, 75W and 93W
- 82 CRI & 2700K, 3000K, 3500K, 4000K
- 92 CRI available in 2700K & 3000K
- 3 Step MacAdam (3 SDCM)
- Rated life of >50,000 hours L70 based on LED testing per LM-80-08 and projected values using IESNA TM21-11

DIMMING

- 0-10V Dimming 1%
- Forward/reverse dimming 1% (120V only)
- EldoLED 0-10V 0.1% or 1%
- Lutron® LDE1 Hi-Lume 1% EcoSystem LED driver with Soft-on, Fade-to-Black dimming technology
- Lutron® LTEA2W Hi-Lume 1% 2-Wire LED driver (120V forward phase only)
- DMX512 RDM 0.1%

OPTICS

- 14° Spot, 20° Spot, 30° Narrow Flood, 40° Flood and 50° Wide Flood
- Optics are field interchangeable

ELECTRICAL SYSTEM (120V OR 277V)

- Power factor >.9, 50/60Hz
- Multiple dimming drivers available
- This product complies with IEEE C62.41 for surge endurance up to 2.5KV. Additional surge protection recommended. Damage from power surge is not covered by warranty.

FRAME CONSTRUCTION

Constructed from 16 gauge and 18 gauge heavy duty powder coated cold rolled steel frame with a large access junction box. ETL listed for through wiring. LED light engine and driver are accessible from above or below ceiling.

REFLECTOR

Specification grade reflector with 1.5mm thickness. Reflector available in black, clear, haze, white or wheat finish. Consult factory for other colors. Lens available in two lens types; Clear Tempered or Solite. Architectural, discrete polished self flange standard. Optional painted white flange is available. Meets RP-1 requirements with controlled light distribution at a 55° cut off.

INSTALLATION

The luminaire is type Non-IC. Insulation must be kept at a minimum of 3" away from fixture. Accommodates up to 1 1/4" ceiling thickness. Universal mounting brackets included. Compatible with C-channel, flat bar, wood joist bar hanger and EMT. Bar hangers must be ordered separately. C-channel is recommended for T-bar ceilings. Max. ambient temperature: 131°F (55°C).

EMERGENCY BACKUP

Remote test switch included. External battery operates LED load of up to 7W at a minimum of 450 lumens for 90 minutes (EM7), or 20W at a minimum of 1350 lumens for 90 minutes (EM20).

LISTING / WARRANTY

- ETL Listed to US and Canadian standards for wet locations
- 5-Year Intense LED Limited Warranty

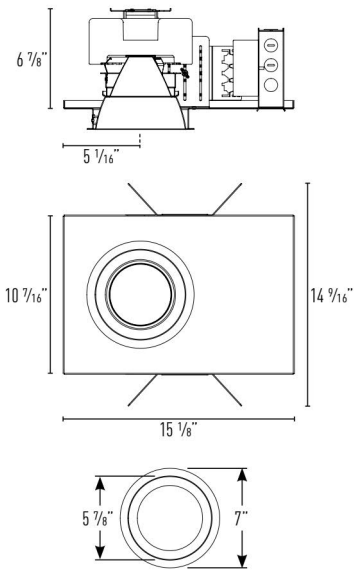

Ceiling Cut Out: 6 1/2"
Maximum Ceiling Thickness: 1 1/4"

Housing Part Number: [Example: IHOL-6DRL230-D10-40]

Housing	Wattage	CCT / CRI	Dimming	Voltage	Optic	Options
IHOL-6DR	<input type="checkbox"/> M1 (12 Watts)	<input type="checkbox"/> 27 (2700K / 82 CRI)	<input type="checkbox"/> blank (Non-Dimming)	<input type="checkbox"/> blank (120V)	<input type="checkbox"/> -14 ⁵ (14° Spot)	<input type="checkbox"/> EM7 (7W Emergency Backup IOTA part #ILB-CP07-A)
	<input type="checkbox"/> M2 (25 Watts)	<input type="checkbox"/> 279 (2700K / 92 CRI)	<input type="checkbox"/> -D10 (0-10V Dimming 10%)	<input type="checkbox"/> 27 (277V)	<input type="checkbox"/> -20 (20° Spot)	<input type="checkbox"/> EM20 (20W Emergency Backup w/ Remote Test Switch IOTA IIR-CP20-HF-S)
	<input type="checkbox"/> L1 (35 Watts)	<input type="checkbox"/> 30 (3000K / 82 CRI)	<input type="checkbox"/> -D101 (0-10V Dimming 1%)		<input type="checkbox"/> -30 (30° Narrow Flood)	<input type="checkbox"/> I100 (C-Channel Bar Hangers)
	<input type="checkbox"/> L2 (46 Watts)	<input type="checkbox"/> 309 (3000K / 92 CRI)	<input type="checkbox"/> -ED10V1 ¹ (eldoLED 0-10V 1%)		<input type="checkbox"/> -40 (40° Flood)	<input type="checkbox"/> I200 (Flat Bar Hangers)
	<input type="checkbox"/> L3 (60 Watts)	<input type="checkbox"/> 35 (3500K / 82 CRI)	<input type="checkbox"/> -ED10V01 ¹ (eldoLED 0-10V 0.1%)		<input type="checkbox"/> -50 (50° Wide Flood)	<input type="checkbox"/> I400 (Wood Joist Bar Hangers)
	<input type="checkbox"/> L4 (75 Watts)	<input type="checkbox"/> 40 (4000K / 82 CRI)	<input type="checkbox"/> -LUT ² (Lutron® LDE1 EcoSystem 1%)			
	<input type="checkbox"/> L5 (93 Watts)		<input type="checkbox"/> -LUT2 ^{2,3} (Lutron® LTEA2W 2-Wire 1%)			
			<input type="checkbox"/> -DMXR ⁴ (DMX512 RDM 0.1%)			

Reflector Part Number: [Example: IRD602HZ-SF-CR]

Reflector	Reflector Finish	Trim	Lens Type
IRD602	<input type="checkbox"/> B ⁶ (Black)	<input type="checkbox"/> -SF (Self Flanged)	<input type="checkbox"/> -CR (Clear Tempered)
	<input type="checkbox"/> C (Clear)	<input type="checkbox"/> -SFW (Self Flanged White)	<input type="checkbox"/> -SL (Solite)
	<input type="checkbox"/> HZ (Haze)		
	<input type="checkbox"/> W (White)		
	<input type="checkbox"/> WHT ⁶ (Wheat)		

Notes:

- eldoLED dimming available with M1, M2, L1 & L2
- Lutron® dimming available with M1, M2, L1 & L2
- Available in 120V only
- DMX512 RDM not available with M1
- 14° Optic available in M1, M2, L1 & L2 only
- Consult factory for lead times

GRAVITY DOWNLIGHT LHM-0626-PP-P-3

INTENSE LIGHTING | 3340 E La Palma Ave. Anaheim, CA 92806 | tel 714 630-9877 | fax 714 630-9883

For Intense Lighting's limited product warranty, go to www.intenselighting.com. For a printed copy of the warranty, you may call 800 961-5321.

© 2019 Intense Lighting, LLC. All rights reserved. Note: This document is subject to change without notice.

intense[®] a LEVITON[®] company



Client:

Fixture Manufacturer: Intense Lighting

Lamp Manufacturer: N/A

Cat #: IHOL-6DR-L2-30-D10-40 / I100 / IRD602-C-SF-CR

Cat #: LED INCL

Capitol Light is not responsible for inaccuracies in manufacturers published specifications

Type:

EL2

Gravity™

JOB NAME		CATALOG NUMBER	
NOTES		TYPE	

IHOL-6DRL130 / IRD602HZ-CR

Report #: 101669895LAX-017 (-14)
101669895LAX-018 (-20)
101669895LAX-019 (-30)
101669895LAX-020 (-40)

CCT / CRI Multipliers:

2700K / 82 CRI (x 0.93)
2700K / 92 CRI (x 0.74)
3000K / 82 CRI (x 1.00)
3000K / 92 CRI (x 0.79)
3500K / 82 CRI (x 1.03)
4000K / 82 CRI (x 1.04)

Lens Multiplier:

Solite Lens (x 0.92)
Clear (x 1.00)

Emergency Multipliers:

7W Emergency (x 0.22)
20W Emergency (x 0.63)

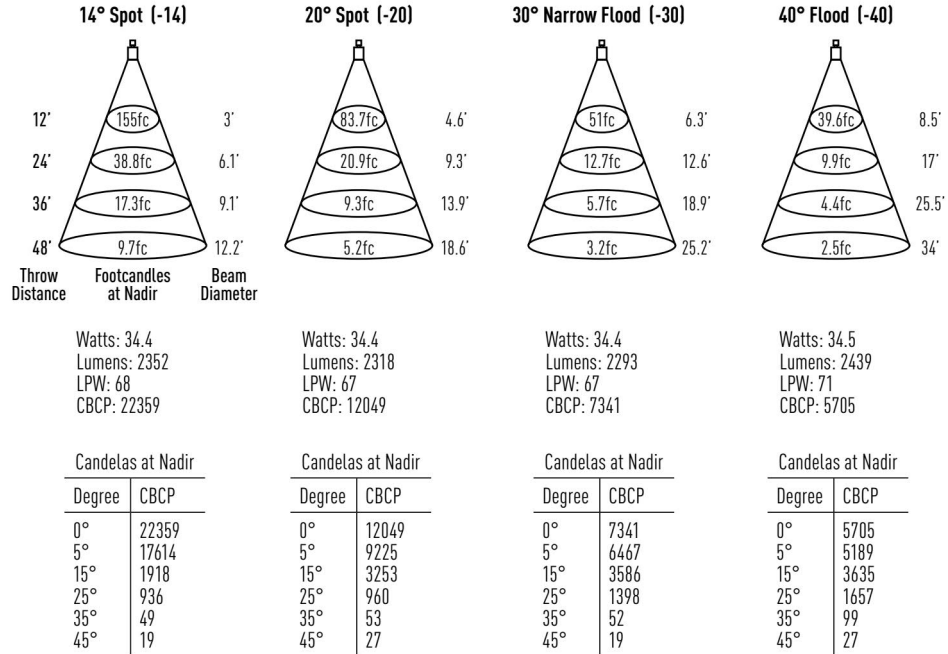

IHOL-6DRL230 / IRD602HZ-CR

Report #: 101669895LAX-021 (-14)
101669895LAX-022 (-20)
101669895LAX-023 (-30)
101669895LAX-024 (-40)

CCT / CRI Multipliers:

2700K / 82 CRI (x 0.93)
2700K / 92 CRI (x 0.74)
3000K / 82 CRI (x 1.00)
3000K / 92 CRI (x 0.79)
3500K / 82 CRI (x 1.03)
4000K / 82 CRI (x 1.04)

Lens Multiplier:

Solite Lens (x 0.92)
Clear (x 1.00)

Emergency Multipliers:

7W Emergency (x 0.16)
20W Emergency (x 0.47)

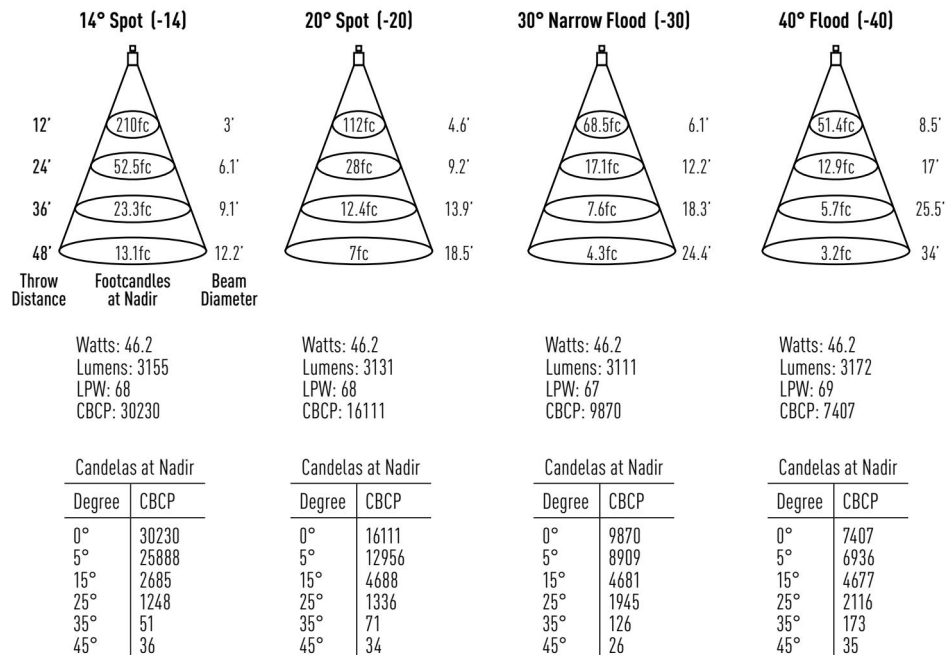

GRAVITY DOWNLIGHT LHM-062619-P-9

INTENSE LIGHTING | 3340 E La Palma Ave. Anaheim, CA 92806 | tel 714 630-9877 | fax 714 630-9883

For Intense Lighting's limited product warranty, go to www.intenselighting.com. For a printed copy of the warranty, you may call 800 961-5321.

© 2019 Intense Lighting, LLC. All rights reserved. Note: This document is subject to change without notice.

intense® | a LEVITON® company



Client:

Fixture Manufacturer: Intense Lighting

Lamp Manufacturer: N/A

Cat #: IHOL-6DR-L2-30-D10-40 / I100 / IRD602-C-SF-CR

Cat #: LED INCL

Capitol Light is not responsible for inaccuracies in manufacturers published specifications

Type:

EL2

DIMMING COMPATIBILITY

JOB NAME		CATALOG NUMBER	
NOTES		TYPE	

0-10V DIMMING

- 120V/277V
- Dims down to 10%, 1% or 0.1% light output
- Consult dimming manufacturer for installation instructions and power packs

COMPATIBLE DIMMERS

Manufacturer	Part Number(s)
HUNT	PS-010-IV-120V, PS-010-WH-120V, PS-010-3W-IV-120, PS-010-3W-WH-120V, PS-010-IV-277V, PS-010-WH-277V, PS-010-3W-IV-277V, PS-010-3W-WH-277V, FD-010: PS-IFC-010-IV, PS-IFC-010-WH-120/277V, FD-010: PS-IFC-010-3W-IV, PS-IFC-010-3W-WH-120/277V, FD-010-120V, FD-010-277V
Leviton	Leviton Centura Fluorescent Control System, IllumaTech™ IP7 Series, DPSPE-212
Lightolier	ZP600FAM120, MP1500FAM120, V2000FAMU
Lithonia	LEQ BC, LEQ LVBC, SLD LVBC, SQ1DC
Lutron	DVTV, NTFTV
Synergy	ISD BC 120/277

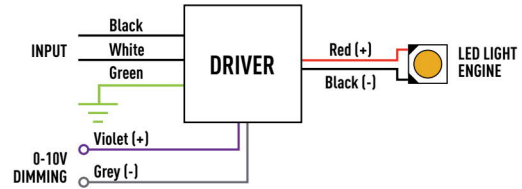

LUTRON ECOSYSTEM® DIMMING

- 120V or 277V
- Dims down to 1%
- Consult dimming manufacturer for installation instructions

COMPATIBLE DIMMERS

CS-1L-WM, CS-2L-WM, CS-1L-CM, CS-2L-CM, EcoSystem ESN, Grafik Eye QS with EcoSystem, Quantum

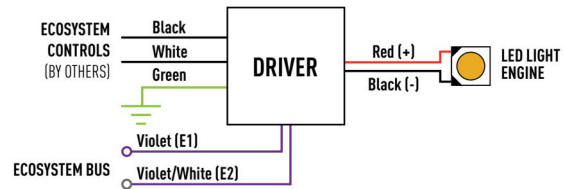

LUTRON HI-LUME® DIMMING

- 120V or 277V
- Dims down to 1%
- Consult dimming manufacturer for installation instructions

COMPATIBLE DIMMERS

AYF-103P, AYF-103P-277, DVF-103, DVF-103P-277, DVSCF-103P, DVSCF-103P-277, HQRD-F6AN-DV, LXF-103PL, LXF-103PL-277, NF-10, NF-103P, NF-103P-277, NF-10-277, NTF-10, NTF-103P, NTF-103P-277, NTF-10-277, RRD-F6AN-DV, SF-12P-277-3, SF-103P, MAF-6AM, MAF-6AM-277, MSCF-6AM, MCSF-6AM-277, MRF2-F6AN-DV, SF-10P, SF-12P-277, SPSF-6A, SPSF-6A-277, SPSF-6AM, SPSF-6AM-277, VF-10, VTF-6AM

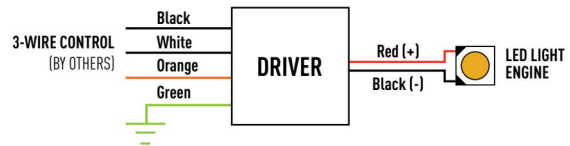

DALI DIMMING

- 120V or 277V
- Dims down to 1% or 0.1% light output

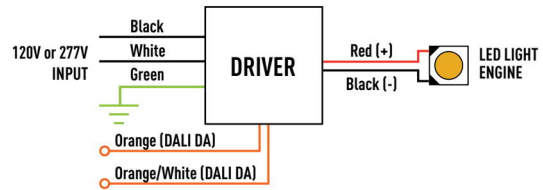

DMX512 RDM DIMMING

- 120V or 277V
- Dims down to 0.1% light output
- RDM channel programmable

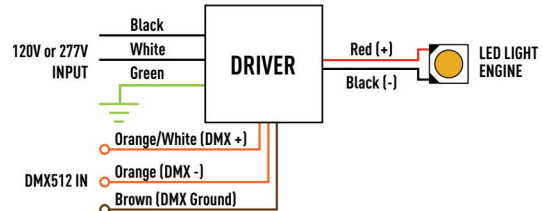

GRAVITY DOWNLIGHT LJM-0626-PP-12

INTENSE LIGHTING | 3340 E La Palma Ave, Anaheim, CA 92806 | tel 714 630-9877 | fax 714 630-9883

For Intense Lighting's limited product warranty, go to www.intenselighting.com. For a printed copy of the warranty, you may call 800 961-5321.

© 2019 Intense Lighting, LLC. All rights reserved. Note: This document is subject to change without notice.

intense® a LEVITON company



Client:		Type:
Fixture Manufacturer: Intense Lighting	Lamp Manufacturer: N/A	EL2
Cat #: IHOL-6DR-L2-30-D10-40 / I100 / IRD602-C-SF-CR	Cat #: LED INCL	
Capitol Light is not responsible for inaccuracies in manufacturers published specifications		

MIRADA WALL SCONCE (XWM)



DOE LIGHTING FACTS

Department of Energy has verified representative product test data and results in accordance with its Lighting Facts Program. Visit www.lightingfacts.com for specific catalog strings.

LIGHT OUTPUT - XWM - 3 5000K CCT

	Lumens	Wattage	LPW
03	3410	29	117
04	4417	40	111
06	6609	59	113
08	8610	82	105

LED Chips are frequently updated therefore values may increase.

COVERAGE DIAGRAM

SIDE VIEW

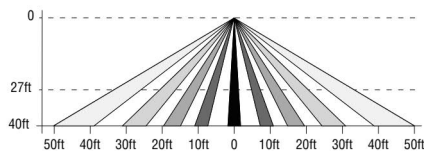

TOP VIEW

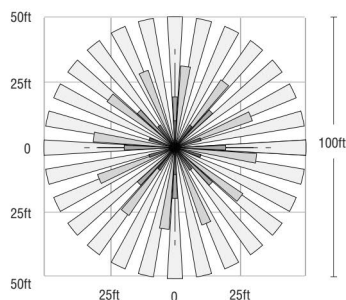

US & Int'l. patents pending

SMARTTEC™ -LSI drivers feature integral sensor which reduces drive current, when ambient temperatures exceed rated temperature

ENERGY SAVING CONTROL OPTIONS - DIM - 0-10 volt dimming enabled with LSI wireless controls.

OPTIONAL INTEGRAL MOTION SENSOR - Passive infrared motion sensor activates switching of luminaire light levels. High level light is activated when passersby enter target zone and increased to full bright in 1-2 seconds. Low light level (30% of maximum drive current) is activated when target zone is absent of motion activity for 5 minutes and is gradually ramped down (10 seconds) to low level. Sensor detection range 110° horizontal x 93° vertical x 10 meters maximum distance.

LEDS - Available with 5000K, 4000K or 3000K color temperature, 70 CRI min.

OPTICS/DISTRIBUTIONS - Ultra-high efficiency reflectors provide three distributions. Choose from Type 2, Type 3 or Type FT.

HOUSING - Three-piece die-cast aluminum housing is smoothly contoured low-profile shape. Mounting hardware is stainless steel or electro-zinc plated steel. Housing and optical unit are sealed with extruded silicone gasket; supply conductors with molded EPDM bushing.

OPTICAL UNIT - Proprietary silicone refractor optics provide exceptional coverage and uniformity. Pressure stabilizing breather allows super-tight protection while preventing cycling from building up internal pressures and vacuums that can stress optical unit seals

WALL MOUNTING - Galvanized-steel universal wall mounting plate easily mounts directly to 4" octagonal or square junction box. EPDM gasket is supplied to be installed between mounting plate and junction box, sealing junction box from entrance of water. Universal plate permits fixture to be mounted in uplighting (indoor only) or downlighting position. Optional pole-mounting bracket permits mounting to standard poles (XPMa).

ELECTRICAL - Two-stage surge protection (including separate surge protection built into electronic driver) meets IEEE C62.41.2-2002, Location Category C. Available with universal voltage power supply 120-277VAC (50/60Hz input) or 347-480VAC.

DRIVER - Drivers are dimming, standard. Components are fully encased in potting material for IP65 moisture resistance. Driver complies with IEC and FCC standards. Driver can be easily accessed.

EMERGENCY OPTIONS - Optional integral emergency battery-back-up options are available. BB option operates in 0°C to 60°C ambient temperature and CWBB operates in -20°C to 60°C ambient temperature. When primary AC power failure occurs, both options operate 10 LEDs for minimum of 90 minutes.

OPERATING TEMPERATURE - -40°C to +50°C (-40°F to +122°F)

FINISH - Fixtures are finished with LSI's DuraGrip® polyester powder coat finishing process. The DuraGrip finish withstands extreme weather changes without cracking or peeling.

WARRANTY - LSI LED fixtures carry a limited 5-year warranty.

PHOTOMETRICS - Please visit our web site at www.lsi-industries.com for detailed photometric data.

SHIPPING WEIGHT (in carton) - 30 lbs./13.6Kg

LISTING - UL listed to ANSI/UL1598, UL8750 and other U.S. and international safety standards. Suitable for wet locations in downlight position.

This product, or selected versions of this product, meet the standards listed below. Please consult factory for your specific requirements.



Project Name _____ Fixture Type _____
 Catalog # _____

10/20/17

© 2017

LSI INDUSTRIES INC.



Client:

Fixture Manufacturer: LSI

Lamp Manufacturer: N/A

Cat #: XWM 2 LED 03L 30 UE BLK

Cat #: N/A

Capitol Light is not responsible for inaccuracies in manufacturers published specifications

Type:
EL3

MIRADA WALL SCONCE (XWM)

LUMINAIRE ORDERING INFORMATION

TYPICAL ORDER EXAMPLE: **XWM FT LED 08L 50 UE WHT IMS**

Prefix	Distribution	Light Source	Output ⁸	Color Temperature	Input Voltage	Finish	Optional Controls	Optional Sensor/Options
XWM - Mirada Wall Sconce	2 - Type 2 3 - Type 3 (Wide Throw) FT - Type 4 (Forward Throw)	LED	03L - 3,400 Lumens 04L - 4,400 Lumens 06L - 6,600 Lumens 08L - 8,600 Lumens	50 - 5000K 40 - 4000K 30 - 3000K	UE - Universal Voltage (120-277) HV - 347-480	BLK - Black BRZ - Bronze GPT - Graphite MSV - Metallic Silver PLP - Platinum Plus WHT - White	Wireless Control System^{1,2} (blank) - None PCM - Platinum Control System GCM - Gold Control System DIM - 0-10 volt dimming (required for satellite fixtures) ALSC - AirLink Synapse Control System Stand-Alone Control (blank) - None DIM - 0-10 volt dimming ³ (from external signal)	Sensor IMS - Integral Motion Sensor ^{4,7} Options BB - Battery Back-up ⁵ CWBB - Cold Weather Battery Back-up ⁵ XPMA - Pole Mounting Bracket

ACCESSORY ORDERING INFORMATION¹ (Accessories are field installed)

Description	Order Number	Description	Order Number
XWM SW BLK - Surface Wiring Box (Available in black only)	356915BLK	DFK208 - Double Fusing	DFK208
FK120 - Single Fusing	FK120	DFK240 - Double Fusing	DFK240
FK277 - Single Fusing	FK277	DFK480 - Double Fusing	DFK480
FK347 - Single Fusing	FK347	IMS/PC Remote Configurator Tool ⁷	584929

FOOTNOTES:

- For wireless controls information and accessories, see Controls Section.
- Requires a SiteManager and override switch. Not compatible with battery back-up, IMS or HL Option.
- Not compatible with IMS Option
- Not compatible with DIM or Wireless Control System
- Not compatible with Wireless Control System
- Not available with BB, CWBB, IMS Option or Wireless Control System
- IMS is the WattStopper Dual Sensor (Daylight & Motion) which is field adjustable, via a handheld remote configurator tool⁸
- Output based on type 3 optics in cool white color temperature, see IES files for exact delivered lumens

DIMENSIONS

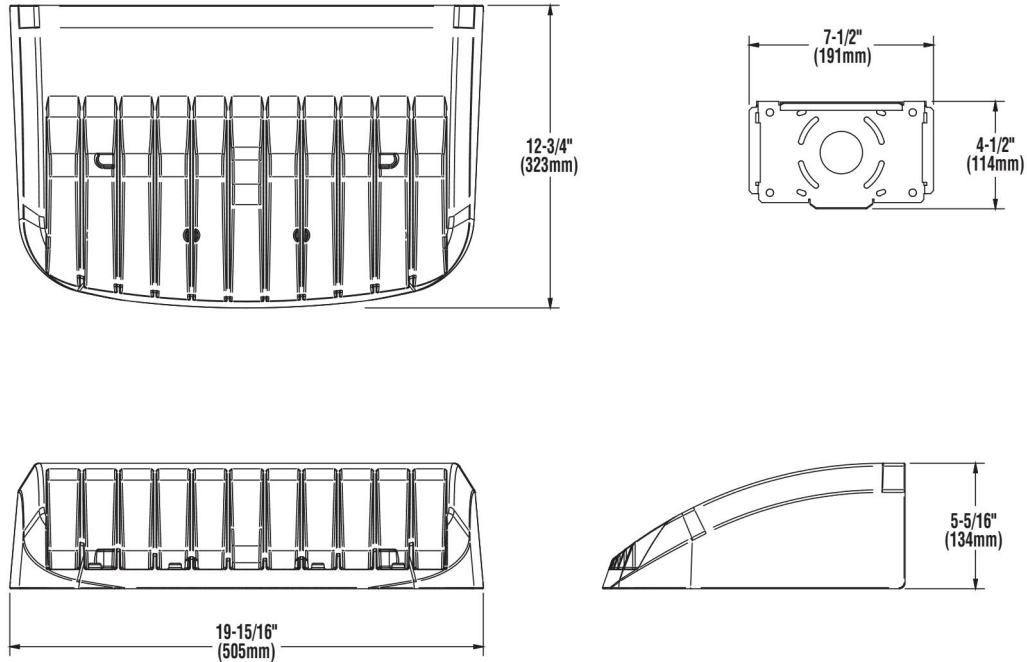

Project Name _____ Fixture Type _____
 Catalog # _____

10/20/17
 © 2017
 LSI INDUSTRIES INC.



Client:	Fixture Manufacturer: LSI	Lamp Manufacturer: N/A	Type: EL3
Cat #: XWM 2 LED 03L 30 UE BLK	Cat #: N/A		
Capitol Light is not responsible for inaccuracies in manufacturers published specifications			



AirLink™

enabled by Synapse®

Wireless Lighting Controller

The AirLink integrated controller is a California Title 24 compliant lighting controller that provides real-time light monitoring and control with utility-grade power monitoring. It includes a 24V sensor input and power supply to connect up to two (2) sensors into the outdoor AirLink wireless lighting system.

Features

- 2% Utility Grade Power Monitoring
- Up to 80% Savings through smart dimming
- True On/Off functionality via switched relay
- Seamlessly integrates into the outdoor AirLink wireless lighting control solution & Self-healing Mesh Networking
- Relay closes on power loss
- Supports a wide range of LED drivers and fixtures
- Class 1 / Class 2 0-10V Dimming Control
- Direct Connect up to two (2) to 24V Occupancy Sensors and Photocells (consult sales for compatible list)
- Secure, over-the-air upgrades to support future enhancements
- Excellent RF Range — 1,000ft LoS between controllers
- Available in a metal cased version with quick connect terminal blocks
- Lights default to on for safety

Specifications

Regulatory Approvals

- FCC, IC, CE certified
- cULus Listed
- California Title 24 compliant

Power and Performance

- Operating environmental: -40°F to 131°F (-40°C to 55°C)
- Input power: 100–277 VAC +/- 10% (Max 305V)47/64 Hz
- Switched output: Default ON; Zero Cross Switching
- Load rating: 5A @ 100V to 277V (+/- 10%)
- Dimming: 0–10V control; Output: Class 1/2 - 20mA Source Max / 50mA Sink Max
- Power monitoring: Utility grade - 2% accuracy
- Sensors inputs: 0–10V (photocell sensors), 0–24V (all other sensors); Sensor power supply: 24VDC @ 50mA

Other

- Dimensions: 8.2" L x 2.3" W x 1.3" H (209mm L x 59mm W x 33mm H) without antennas
- Radio: SNAP 2.4 GHz; 802.15.4; +20 dBm Transmit Power; -105 dBm Receive Sensitivity
- Warranty: 5 years

Contact LSI Controls



Sales
controls.sales@lsi-industries.com



Support
controls.support@lsi-industries.com
1 (800) 436-7800 (support, option 8)



More information
For more information on AirLink, visit our website at www.lsi-airlink.com/airlink



Client:		Type: EL3
Fixture Manufacturer: LSI	Lamp Manufacturer: N/A	
Cat #: XWM 2 LED 03L 30 UE BLK	Cat #: N/A	
Capitol Light is not responsible for inaccuracies in manufacturers published specifications		

DATE	PROJECT	FIRM	TYPE
------	---------	------	------

THE L50 INCLUDES PATENTED OPTICAL DESIGN THAT DELIVERS THE WIDEST RANGE OF BEAM ANGLE OPTIONS FOR PRECISE COVE, WALL GRAZING, WALL WASHING OR LINE OF LIGHT APPLICATIONS. EXCLUSIVE FLIP TO FLAT™ HINGE DESIGN PROVIDES FLEXIBILITY WHEN MANAGING SMALL COVE DETAILS. TROV OFFERS SMOOTH, FLICKER FREE DIMMING DOWN TO 0%.

FEATURES :

- DIM TO 0%, ELV REVERSE PHASE
- 24 BEAM ANGLES
- MULTI-VOLT
- FLIP TO FLAT™
- 6 CCT OPTIONS
- 80+ AND 90+ CRI OPTIONS
- IP66 EXTERIOR OPTIONS



MODEL/ SIZE	INTERIOR/ EXTERIOR	LENGTH	POWER	CCT	CRI	VOLTAGE	OPTICS
L50	E	12" 48"	02 04 06 08 10 12	WHITE CCT 22 27 30 35 40 50	MONO COLOR GR**** BL AM RD***	80 90* Blank For Color MULT (120-277V)	GRAZING 9 x 9 9 x 17 9 x 20 15 x 15 15 x 23 15 x 35 15 x 65 COVE 120** Asym LINE OF LIGHT LOL WASHING 25 x 25 25 x 33 25 x 45 25 x 75 39 x 9 55 x 25 40 x 40 40 x 48 40 x 60 40 x 90 45 x 15 70 x 40 70 x 70

EXAMPLE: L50-E-48-10-27-90-MULT-15x65 *90 CRI not available in 2200K or 5000K **120 is only available with Exterior option. See L35 spec sheet for interior cove options. ***Red is not available in 12W or 10W. ****Green is not available in 12W.

PERFORMANCE	WATTS	OPTIC	LUMEN OUTPUT	EFFICACY
	2W	120°	95 lm/LF (311 lm/m)	48 lm/W
	4W	120°	273 lm/LF (895 lm/m)	68 lm/W
	6W	120°	426 lm/LF (1397 lm/m)	71 lm/W
	8W	120°	586 lm/LF (1922 lm/m)	73 lm/W
	10W	120°	697 lm/LF (2286 lm/m)	70 lm/W
	12W	120°	807 lm/LF (2647 lm/m)	67 lm/W

ALL LUMEN DATA IS FROM 4000K 80CRI FIXTURES. PLEASE SEE PHOTOMETRY SPEC SHEET FOR ADDITIONAL LUMEN DATA.

COLOR RENDERING INDEX	80+, 90+			
COLOR CONSISTENCY	2-STEP MACADAM ELLIPSE			
LUMEN DEPRECIATION / RATED LIFE	WATTS	L70 @ 25C	L70 @ 50C	L90 @ 25C L90 @ 50C
	2W-12W	>150,000	>70,000	>50,000 >25,000

* CALCULATIONS FOR LED FIXTURES ARE BASED ON MEASUREMENTS THAT COMPLY WITH IES LM-80 TESTING PROCEDURES AND IES TM-21 CALCULATOR

ELECTRICAL	POWER CONSUMPTION	2W*/LF (6.6W/M) ; 4W/LF (13.2W/M) ; 6W/LF (19.8W/M) ; 8W/LF (26.4W/M) ; 10W/LF (33W/M) ; 12W/FL (39.6W/M) * 3W*/LF (9.9W/M) at 220V -277V											
		2W/LF		4W/LF		6W/LF		8W/LF		10W/LF		12W/LF	
	MAX FIXTURE RUN LENGTH	Volts	Max Run all 1'	Max Run all 4'	Max Run all 1'	Max Run all 4'	Max Run all 1'	Max Run all 4'	Max Run all 1'	Max Run all 4'	Max Run all 1'	Max Run all 4'	
		120	214	214	186	186	152	152	114	114	91	91	
		220	374	392	340	340	277	277	209	209	95	167	
		277	374	494	374	428	349	349	263	263	95	190	

POWER FACTOR	4W, 6W, 8W, 10W, 12W >0.9, 2W<0.9
OPERATING VOLTAGE	MULTIVOLT: 110-277VAC, 50/60 Hz
DRIVER	INTEGRAL TO FIXTURE; DE-RATED POWER AND SYNCHRONOUS START-UP AT FULL BRIGHTNESS
STARTUP TEMPERATURE	-40° F TO 122° F (-40° C TO 50° C)
OPERATING TEMPERATURE	-40° F TO 122° F (-40° C TO 50° C)
STORAGE TEMPERATURE	-40° F TO 176° F (-40° C TO 80° C)

ECOSENSE LIGHTING INC.
837 NORTH SPRING STREET
SUITE 103
LOS ANGELES, CA 90012

P • 310.496.6255
F • 310.496.6256
T • 855.632.6736
855.6.ECOSEN

SPECIFICATIONS SUBJECT TO CHANGE WITHOUT NOTICE. VISIT ECOSENSELIGHTING.COM FOR THE MOST CURRENT SPECIFICATIONS. FOR A LIST OF PATENTS VISIT ECOSENSELIGHTING.COM/IP-PORTFOLIO/

©2018 ECOSENSE LIGHTING INC. ALL RIGHTS RESERVED. ECOSENSE, THE ECOSENSE LOGO, TRÖV, TRÖV AND ECOSPEC ARE REGISTERED TRADEMARKS OF ECOSENSE LIGHTING INC.

RISE™, SLIM COVE™, FREEDOM TO CREATE™, MACRO™, FLIP-TO-FLAT™ ARE TRADEMARKS OF ECOSENSE LIGHTING INC.

ECOSENSELIGHTING.COM 1/3



Client:		Type: EL4-4'
Fixture Manufacturer: ECOSENSE	Lamp Manufacturer: N/A	
Cat #: L50-E-48-12-27-80-MULT-9x59 / CBL-3P-L-UNV-10	Cat #: N/A	
Capitol Light is not responsible for inaccuracies in manufacturers published specifications		

DATE	PROJECT	FIRM	TYPE
CONTROL	DIMMING	110-277VAC, ELV TYPE 0.07%-100%, REVERSE PHASE, TRAILING EDGE ETC control systems require 0-10V control using EcoSense LDCM. TROV will not work with ETC phase dimmers.	
PHYSICAL	DIMENSIONS HOUSING / LENS WEIGHT CONNECTORS ENVIRONMENT BEAM ANGLE MOUNTING OPTIONS	W 1.6" x H 2" x L 12"/48" ; (41.6mm x 50.5mm x 304.7mm/1201mm) EXTRUDED ALUMINUM; UV STABILIZED POLYCARBONATE; STAINLESS STEEL FASTENERS; PLASTIC ENDCAPS RUBBER OVERMOLD FOR CABLE ASSEMBLY 1.52LBS / 0.69KG (1FT) ; 4.95LBS / 2.25KG (4FT) INTEGRAL MALE/ FEMALE CONNECTORS INDOOR • ETL CERTIFIED FOR DRY/DAMP LOCATIONS IP54 OUTDOOR • ETL CERTIFIED FOR WET LOCATIONS IP66 IMPACT RATED TO IK10 GRAZING, WASHING, COVE, ASYMMETRIC, LINE OF LIGHT INTEGRAL MOUNTING AND ADJUSTABLE AIMING FROM 0°-180° IN 15° INCREMENTS	
FIXTURE RATING & CERTIFICATIONS	CE, ETL CERTIFIED RoHS COMPLIANT ENERGY STAR COMPLIANT DLC COMPLIANT RCM CERTIFIED		
LIMITED WARRANTY 5 YEARS			

WIRING OPTIONS (MVOLT): 110-277VAC

Power Cable Assembly, TROV, Leader/Jumper, 10 foot.....	CBL-3P-L-UNV-10*
Power Cable Assembly, TROV, Leader/Jumper, 50 foot.....	CBL-3P-L-UNV-50*
Power Cable Assembly, TROV, Jumper, 5 foot.....	CBL-3P-L-UNV-05**
Power Cable Assembly, TROV, Jumper, 1 foot.....	CBL-3P-L-UNV-01**
Power Cable Assembly, TROV, Adjustable Jumper, 0" to 7".....	CBL-3P-L-UNV-ADJ
Power Cable Assembly, TROV, Male and Female terminator caps.....	CBL-3P-L-UNV-CAPS

*Two (2) terminators are included with the 10' and 50' power cable. One Leader need per circuit/fixture run. Cables are not plenum rated.
** If using the 5' or 1' power cable assembly as a leader to power a run one set of CBL-3P-L-UNV-CAPS will also be need per cable.

0-10V CONTROL OPTIONS

100-120VAC / 277VAC Linear Dimming Control Module 0-10V - Plenum Rated LDCM-PL-120-277-010V-GR
All products come standard with ELV dimming capabilities. 0-10V Control options required for operation at 0-10V.

OPTIONAL ACCESSORIES

Mounting

Mounting Track and Clips Set, 48 Inch Track, 8 Clips..... MNT-L-TRKCLIP-4848" track and clips set will work with one 48" fixture or four 12" fixtures.
Mounting Track and Clips Set, 12 Inch Track, 2 Clips.....MNT-L-TRKCLIP-1212" track will not work with 48" fixtures.
Mounting Track Clip, TROV, Set of 2..... MNT-L-CLIPClips needed = 12" fixtures need 1 set of 2 and 48" fixture needs 2 sets of 2.
90 Degree L bracket, TROV, Set of 2.....MNT-L-LBKTL-Brackets needed = 12" fixtures need 1 set of 2 and 48" fixture needs 1 set of 2.
Angle Locking Clip, TROV, Pack of 10..... MNT-L-ANGLOCKAngle Locks needed = 12" fixtures need 1 and 48" fixtures need 2.
(Must order separately)
Mounting, Fine Adjustment Bracket, TROV MNT-L-FABFine Adjustment Brackets needed = 12" fixtures need 1 and 48" fixtures need 2.
*Fine Adjustment Bracket is highly recommended for Grazing Optics.
Mounting, Fine Adjustment L-Bracket, TROVMNT-L-LFABFine Adjustment L-Brackets needed = 12" fixtures need 1 and 48" fixtures need 2.
*Fine Adjustment L-Bracket is recommended for Asymmetric Optics when aiming is needed.

Snap-on Lenses

Snap-on Lens, Frosted, 12 inch, L50 LENS-L50-FROST-12
Snap-on Lens, Frosted, 48 inch, L50..... LENS-L50-FROST-48
Snap-on Lens, Clear, 12 inch, L50..... LENS-L50-CLEAR-12
Snap-on Lens, Clear, 48 inch, L50 LENS-L50-CLEAR-48
Snap-on Lenses need = One 12" lens is needed per 12" fixture and one 48" lens is needed per 48" fixture. Snap on Lenses will not work with the asymmetric fixture. Clear lenses can be used to hold colored filters to customize the output color of any TROV fixture, except the ASYM. Color filters supplied by others.

Wall Mount Arm

Wall Mount Arm, 6 inch, TROV WMA-L-CA-06
Wall Mount Arm, 12 inch, TROV..... WMA-L-CA-12
Wall Mount Arm, 18 inch, TROV..... WMA-L-CA-18
Wall Mount Arm, 24 inch, TROV..... WMA-L-CA-24
Wall Mount Arm End Plate Set, TROV, Includes Left and Right..... WMA-L-END
Wall Mount Arm Joiner Plate, TROV WMA-L-JNR
Wall Mount Arms needed = For individual fixture installations two arms and one end set will be needed per fixture. For continuous run installation one endset will be needed per run. Each end set contains one left and one right end plate. One joining set will be needed per joint. One arm per fixture will be need plus one extra arm to complete the run. For example: A 10ft run made with two 4ft and two 1ft fixtures will contain; 1 x WMA-L-END, 3 x WMA-L-JNR, and 5 x WMA-L-CA-12. Leader cables are not included with wall mount arms, end sets, or joiners sets.

Louvers

Louver, Asymmetric, 12 inch, L50 LV-L50-ASYM-12
Louver, Asymmetric, 48 inch, L50 LV-L50-ASYM-48
Louver, Symmetric, 12 inch, L50 LV-L50-SYM-12
Louver, Symmetric, 48 inch, L50 LV-L50-SYM-48
Louver, Honeycomb, 12 inch, L50 LV-L50-HCOMB-12
Louver, Honeycomb, 48 inch, L50 LV-L50-HCOMB-48
Louvers Needed = One 12" louver is needed per 12" fixture and one 48" louver is needed per 48" fixture. 48" louver is made up of four 12" louvers.
Louvers cannot be used with the asymmetric fixture

ECOSENSE LIGHTING INC.
837 NORTH SPRING STREET
SUITE 103
LOS ANGELES, CA 90012

P • 310.496.6255
F • 310.496.6256
T • 855.632.6736
855.6.ECOSEN

SPECIFICATIONS SUBJECT TO CHANGE WITHOUT NOTICE.
VISIT ECOSENSELIGHTING.COM FOR THE MOST CURRENT SPECIFICATIONS.
FOR A LIST OF PATENTS VISIT ECOSENSELIGHTING.COM/IP-PORTFOLIO/
©2018 ECOSENSE LIGHTING INC. ALL RIGHTS RESERVED. ECOSENSE, THE ECOSENSE LOGO, TROV, TROV AND ECOSPEC ARE REGISTERED TRADEMARKS OF ECOSENSE LIGHTING INC.
RISE™, SLIM COVE™, FREEDOM TO CREATE™, MACRO™, FLIP-TO-FLAT™ ARE TRADEMARKS OF ECOSENSE LIGHTING INC.

ECOSENSELIGHTING.COM

2 / 3

20180717



Client:		Type: EL4-4'
Fixture Manufacturer: ECOSENSE	Lamp Manufacturer: N/A	
Cat #: L50-E-48-12-27-80-MULT-9x59 / CBL-3P-L-UNV-10	Cat #: N/A	
Capitol Light is not responsible for inaccuracies in manufacturers published specifications		

DATE	PROJECT	FIRM	TYPE
------	---------	------	------

OPTIONAL ACCESSORIES

Masking Plates

Masking Plate, 3 inch high, 12 inch, L50 & L35 MP-L50-3H-12
 Masking Plate, 3 inch high, 48 inch, L50 & L35 MP-L50-3H-48

Masking Plates needed = One 12" lens is needed per 12" fixture and one 48" lens is needed per 48" fixture.

Landscape Stake

Landscape Stake, 6 inch, TROV, Set of 2 LS-L-STK-06
 Landscape Stake, 12 inch, TROV, Set of 2 LS-L-STK-12
 Landscape Stake, 18 inch, TROV, Set of 2 LS-L-STK-18

Landscape Stakes needed = 12" and 48" fixtures both need one set of 2.

DIMENSIONS + MOUNTING

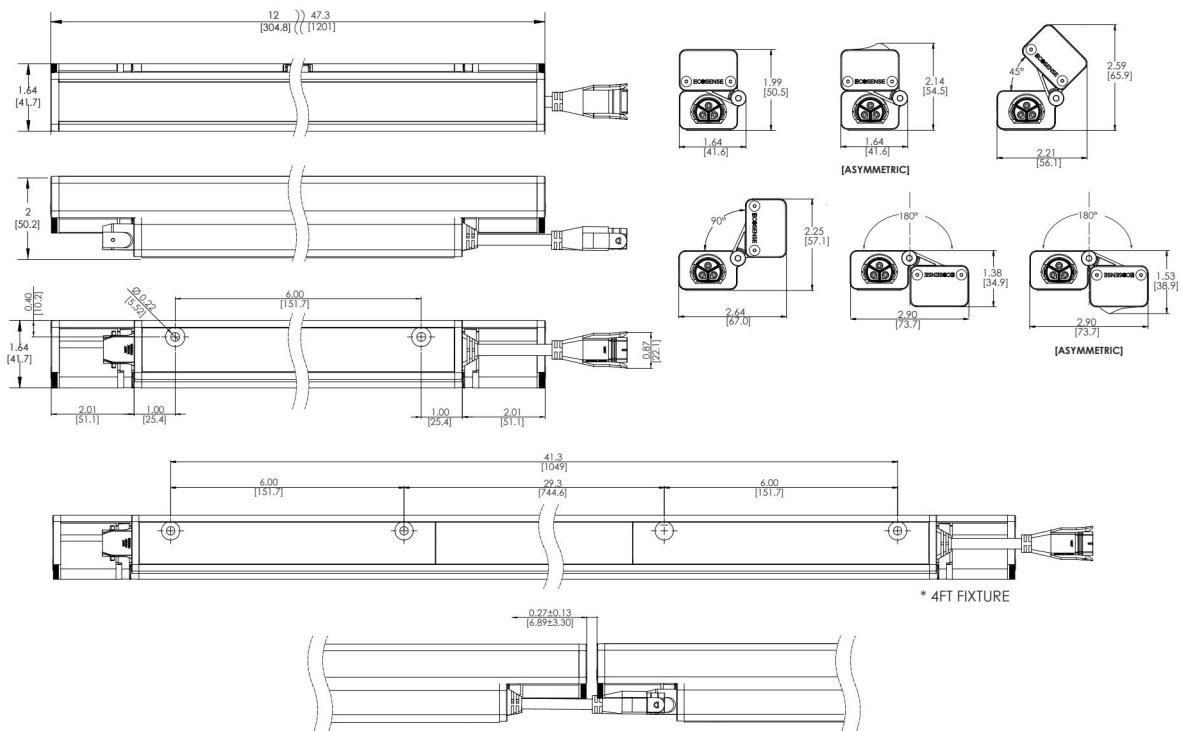

Fine Adjustable Bracket:

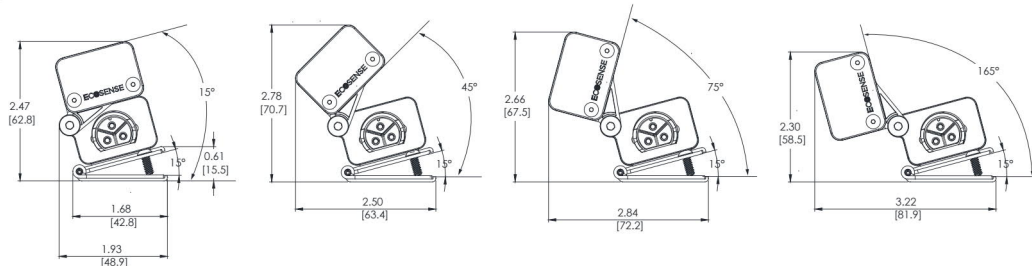

ECOSENSE LIGHTING INC.
 837 NORTH SPRING STREET
 SUITE 103
 LOS ANGELES, CA 90012

P • 310.496.6255
F • 310.496.6256
T • 855.632.6736
 855.6.ECOSEN

SPECIFICATIONS SUBJECT TO CHANGE WITHOUT NOTICE. VISIT ECOSENSELIGHTING.COM FOR THE MOST CURRENT SPECIFICATIONS. FOR A LIST OF PATENTS VISIT ECOSENSELIGHTING.COM/IP-PORTFOLIO/
©2018 ECOSENSE LIGHTING INC. ALL RIGHTS RESERVED. ECOSENSE, THE ECOSENSE LOGO, TRÖV, TROV AND ECOSPEC ARE REGISTERED TRADEMARKS OF ECOSENSE LIGHTING INC.
RISE™, SLIM COVE™, FREEDOM TO CREATE™, MACRO™, FLIP-TO-FLAT™ ARE TRADEMARKS OF ECOSENSE LIGHTING INC.

ECOSENSELIGHTING.COM

3/3

20180717



Client:

Fixture Manufacturer: ECOSENSE

Lamp Manufacturer: N/A

Cat #: L50-E-48-12-27-80-MULT-9x59 / CBL-3P-L-UNV-10

Cat #: N/A

Capitol Light is not responsible for inaccuracies in manufacturers published specifications

Type:

EL4-4'

MIRADA WALL SCONCE (XWM)



DOE LIGHTING FACTS

Department of Energy has verified representative product test data and results in accordance with its Lighting Facts Program. Visit www.lightingfacts.com for specific catalog strings.

LIGHT OUTPUT - XWM - 3 5000K CCT			
	Lumens	Wattage	LPW
03	3410	29	117
04	4417	40	111
06	6609	59	113
08	8610	82	105

LED Chips are frequently updated therefore values may increase.

COVERAGE DIAGRAM

SIDE VIEW

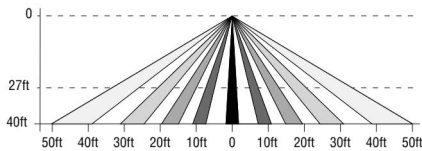

TOP VIEW

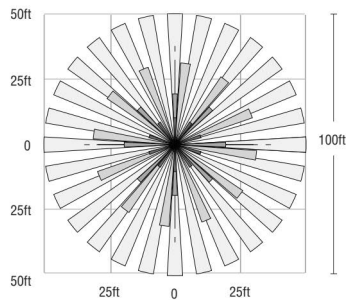

US & Int'l. patents pending

SMARTTEC™ -LSI drivers feature integral sensor which reduces drive current, when ambient temperatures exceed rated temperature

ENERGY SAVING CONTROL OPTIONS - DIM - 0-10 volt dimming enabled with LSI wireless controls.

OPTIONAL INTEGRAL MOTION SENSOR - Passive infrared motion sensor activates switching of luminaire light levels. High level light is activated when passersby enter target zone and increased to full bright in 1-2 seconds. Low light level (30% of maximum drive current) is activated when target zone is absent of motion activity for 5 minutes and is gradually ramped down (10 seconds) to low level. Sensor detection range 110° horizontal x 93° vertical x 10 meters maximum distance.

LEDS - Available with 5000K, 4000K or 3000K color temperature, 70 CRI min.

OPTICS/DISTRIBUTIONS - Ultra-high efficiency reflectors provide three distributions. Choose from Type 2, Type 3 or Type FT.

HOUSING - Three-piece die-cast aluminum housing is smoothly contoured low-profile shape. Mounting hardware is stainless steel or electro-zinc plated steel. Housing and optical unit are sealed with extruded silicone gasket; supply conductors with molded EPDM bushing.

OPTICAL UNIT - Proprietary silicone refractor optics provide exceptional coverage and uniformity. Pressure stabilizing breather allows super-tight protection while preventing cycling from building up internal pressures and vacuums that can stress optical unit seals

WALL MOUNTING - Galvanized-steel universal wall mounting plate easily mounts directly to 4" octagonal or square junction box. EPDM gasket is supplied to be installed between mounting plate and junction box, sealing junction box from entrance of water. Universal plate permits fixture to be mounted in uplighting (indoor only) or downlighting position. Optional pole-mounting bracket permits mounting to standard poles (XPMa).

ELECTRICAL - Two-stage surge protection (including separate surge protection built into electronic driver) meets IEEE C62.41.2-2002, Location Category C. Available with universal voltage power supply 120-277VAC (50/60Hz input) or 347-480VAC.

DRIVER - Drivers are dimming, standard. Components are fully encased in potting material for IP65 moisture resistance. Driver complies with IEC and FCC standards. Driver can be easily accessed.

EMERGENCY OPTIONS - Optional integral emergency battery-back-up options are available. BB option operates in 0°C to 60°C ambient temperature and CWBB operates in -20°C to 60°C ambient temperature. When primary AC power failure occurs, both options operate 10 LEDs for minimum of 90 minutes.

OPERATING TEMPERATURE - -40°C to +50°C (-40°F to +122°F)

FINISH - Fixtures are finished with LSI's DuraGrip® polyester powder coat finishing process. The DuraGrip finish withstands extreme weather changes without cracking or peeling.

WARRANTY - LSI LED fixtures carry a limited 5-year warranty.

PHOTOMETRICS - Please visit our web site at www.lsi-industries.com for detailed photometric data.

SHIPPING WEIGHT (in carton) - 30 lbs./13.6Kg

LISTING - UL listed to ANSI/UL1598, UL8750 and other U.S. and international safety standards. Suitable for wet locations in downlight position.

This product, or selected versions of this product, meet the standards listed below. Please consult factory for your specific requirements.



Project Name _____ Fixture Type _____
 Catalog # _____

10/20/17

© 2017

LSI INDUSTRIES INC.



Client:

Fixture Manufacturer: LSI

Lamp Manufacturer: N/A

Cat #: XWM 2 LED 03L 30 UE BLK BB

Cat #: N/A

Capitol Light is not responsible for inaccuracies in manufacturers published specifications

Type:

X3

MIRADA WALL SCONCE (XWM)

LUMINAIRE ORDERING INFORMATION

TYPICAL ORDER EXAMPLE: **XWM FT LED 08L 50 UE WHT IMS**

Prefix	Distribution	Light Source	Output ⁸	Color Temperature	Input Voltage	Finish	Optional Controls	Optional Sensor/Options
XWM - Mirada Wall Sconce	2 - Type 2 3 - Type 3 (Wide Throw) FT - Type 4 (Forward Throw)	LED	03L - 3,400 Lumens 04L - 4,400 Lumens 06L - 6,600 Lumens 08L - 8,600 Lumens	50 - 5000K 40 - 4000K 30 - 3000K	UE - Universal Voltage (120-277) HV - 347-480	BLK - Black BRZ - Bronze GPT - Graphite MSV - Metallic Silver PLP - Platinum Plus WHT - White	Wireless Control System^{1,2} (blank) - None PCM - Platinum Control System GCM - Gold Control System DIM - 0-10 volt dimming (required for satellite fixtures) ALSC - AirLink Synapse Control System Stand-Alone Control (blank) - None DIM - 0-10 volt dimming ³ (from external signal)	Sensor IMS - Integral Motion Sensor ^{4,7} Options BB - Battery Back-up ⁵ CWBB - Cold Weather Battery Back-up ⁵ XPMA - Pole Mounting Bracket

ACCESSORY ORDERING INFORMATION¹ (Accessories are field installed)

Description	Order Number	Description	Order Number
XWM SW BLK - Surface Wiring Box (Available in black only)	356915BLK	DFK208 - Double Fusing	DFK208
FK120 - Single Fusing	FK120	DFK240 - Double Fusing	DFK240
FK277 - Single Fusing	FK277	DFK480 - Double Fusing	DFK480
FK347 - Single Fusing	FK347	IMS/PC Remote Configurator Tool ⁷	584929

FOOTNOTES:

- For wireless controls information and accessories, see Controls Section.
- Requires a SiteManager and override switch. Not compatible with battery back-up, IMS or HL Option.
- Not compatible with IMS Option
- Not compatible with DIM or Wireless Control System
- Not compatible with Wireless Control System
- Not available with BB, CWBB, IMS Option or Wireless Control System
- IMS is the WattStopper Dual Sensor (Daylight & Motion) which is field adjustable, via a handheld remote configurator tool⁸
- Output based on type 3 optics in cool white color temperature, see IES files for exact delivered lumens

DIMENSIONS

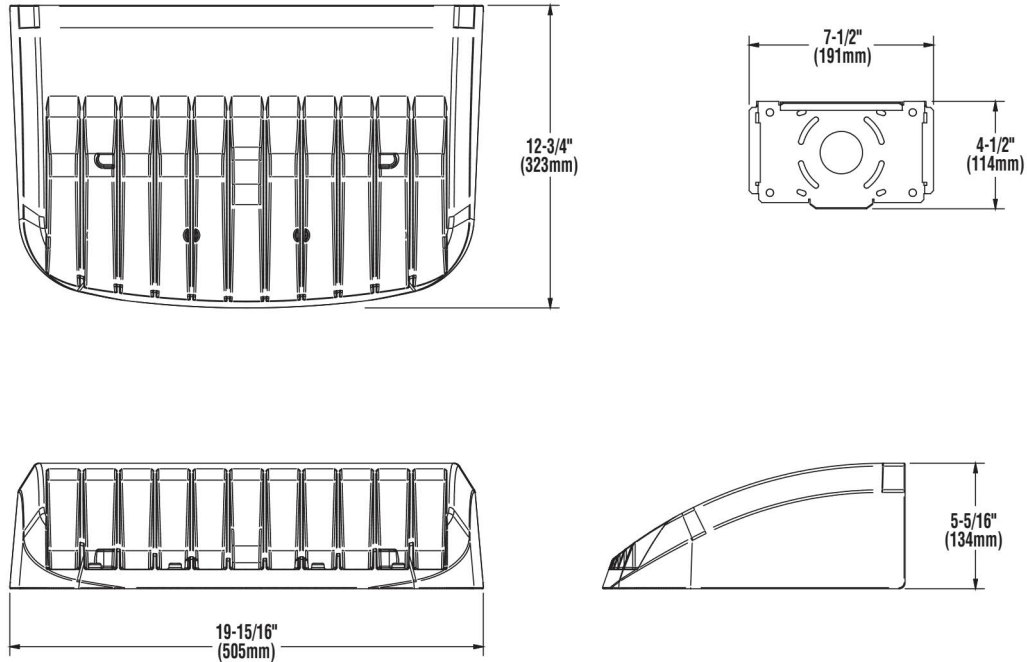

Project Name _____ Fixture Type _____
 Catalog # _____

10/20/17
 © 2017
 LSI INDUSTRIES INC.



Client:		Type:
Fixture Manufacturer: LSI	Lamp Manufacturer: N/A	X3
Cat #: XWM 2 LED 03L 30 UE BLK BB	Cat #: N/A	
Capitol Light is not responsible for inaccuracies in manufacturers published specifications		



AirLink™

enabled by Synapse®

Wireless Lighting Controller

The AirLink integrated controller is a California Title 24 compliant lighting controller that provides real-time light monitoring and control with utility-grade power monitoring. It includes a 24V sensor input and power supply to connect up to two (2) sensors into the outdoor AirLink wireless lighting system.

Features

- 2% Utility Grade Power Monitoring
- Up to 80% Savings through smart dimming
- True On/Off functionality via switched relay
- Seamlessly integrates into the outdoor AirLink wireless lighting control solution & Self-healing Mesh Networking
- Relay closes on power loss
- Supports a wide range of LED drivers and fixtures
- Class 1 / Class 2 0-10V Dimming Control
- Direct Connect up to two (2) to 24V Occupancy Sensors and Photocells (consult sales for compatible list)
- Secure, over-the-air upgrades to support future enhancements
- Excellent RF Range — 1,000ft LoS between controllers
- Available in a metal cased version with quick connect terminal blocks
- Lights default to on for safety

Specifications

Regulatory Approvals

- FCC, IC, CE certified
- cULus Listed
- California Title 24 compliant

Power and Performance

- Operating environmental: -40°F to 131°F (-40°C to 55°C)
- Input power: 100–277 VAC +/- 10% (Max 305V)47/64 Hz
- Switched output: Default ON; Zero Cross Switching
- Load rating: 5A @ 100V to 277V (+/- 10%)
- Dimming: 0–10V control; Output: Class 1/2 - 20mA Source Max / 50mA Sink Max
- Power monitoring: Utility grade - 2% accuracy
- Sensors inputs: 0–10V (photocell sensors), 0–24V (all other sensors); Sensor power supply: 24VDC @ 50mA

Other

- Dimensions: 8.2" L x 2.3" W x 1.3" H (209mm L x 59mm W x 33mm H) without antennas
- Radio: SNAP 2.4 GHz; 802.15.4; +20 dBm Transmit Power; -105 dBm Receive Sensitivity
- Warranty: 5 years

Contact LSI Controls



Sales
controls.sales@lsi-industries.com



Support
controls.support@lsi-industries.com
1 (800) 436-7800 (support, option 8)



More information
For more information on AirLink, visit our website at www.lsi-airlink.com/airlink



Client:		Type: X3
Fixture Manufacturer: LSI	Lamp Manufacturer: N/A	
Cat #: XWM 2 LED O3L 30 UE BLK BB	Cat #: N/A	
Capitol Light is not responsible for inaccuracies in manufacturers published specifications		

Design #	0390056A.13
Sheet	4 of 19
Client	

MAIN EVENT

Address

64 CENTENNIAL BLD
HIGHLAND RANCH, CO. 80129

Account Rep. MSW/JA

Designer REF

Date 07.18.17

Approval / Date

Client	
Spikes	
Estimating	
Art	
Engineering	
Landlord	

Revision / Date

15	KMC 7/20/17: add site cont?
14	CS 6/29
13	CS 6/29
12	AMS 8/18/17: rme optios
11	AMS 8/18/17: add filler
10	RMS 9/14/17: correct stud scale
9	SDM 9/12/17: revised "E"
8	REE 02/28/17: update
7	AMA 1/24/18: NEW ELEV & LED
6	SL 1/15/18: SIGN MATCH: 393248
5	SL 1/15/18: SIGN MATCH: 393248
4	Street Color: on-slim "
3	SL 2/23/18: add out. w/ "
2	SL 2/23/18: add out. w/ "
1	SL 2/23/18: add out. w/ "



chandlersigns.com

National Headquarters

84705 Sovereign Ridge #103
19400 Hwy 101, Suite 100
19400 Hwy 101, Suite 100

San Antonio

17335 San Pkwy Ave
San Antonio, TX 78232

West Coast

2525 Leveaux Ridge Dr
Walton, CA 95086

Northeast US

2501 Bayport Road
Lynchburg, VA 40026

Florida

1588 Saddle Hill Blvd
Beverly Hills, FL 33077

Georgia

111 Woodstone Pkwy
Lawrenceville, GA 30046

South Texas

90503 153 265 Street
Houston, TX 77027

The drawings are the property of Chandler Signs, L.P., L.L.P. All rights to its use for reproduction are reserved by Chandler Signs, L.P., L.L.P.

FINAL ELECTRICAL CONNECTION BY CUSTOMER



Performance Data

Color	Light Engine	Light Guide	System Wavelength (nm)	System Lumens (ft.m)	LPW	CRI	Color Temperature
Blue	GEBLAN.E1	WITHOUT GUIDE	3.39 (11.12)	23 (75)	5	-	467
	GEBLAN.E1	with white GUIDE (GEBLAN.G15)	3.39 (11.12)	20 (68)	7	-	467
	GEBLAN.E1	with guide (GEBLAN.G15)	3.39 (11.12)	19 (63)	7	-	467

Light Output

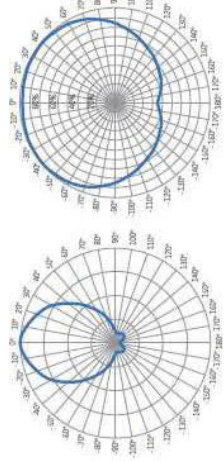

LED light engine with light guide

Technical Specifications

Dimensions w/o Guide:	0.41 in. x 0.96 in. x 0.43 in. (10mm x 24.38mm x 11mm)
Dimensions w/ Guide:	1 in. x 0.96 in. x 1.08 in. (25mm x 24.38mm x 28mm)
Viewing Angle w/o Guide:	110°
Viewing Angle w/ Guide:	330°
Power Supplies:	GEPS24-30; GEPS24-80 & GEPS24-100U
Output Voltage:	24 VDC
Input Voltage:	GEPS24-20: 90-264 VAC @ 50/60Hz GEPS24-80: 108-264 VAC @ 50/60Hz GEPS24-100U: 108-305 VAC @ 50/60Hz
Operating Temp. Range:	-40°C to 55°C
Storage Temp. Range:	-40°C to 75°C
Limited Warranty:	up to 5 years
System Certifications:	Assembled light engine and light guide: IP66; outdoor rated Power supply: IP66; separate enclosure required, damp location rated

LED light engine with light guide



For IES files, application information and additional product support, visit us at www.gelightsolutions.com

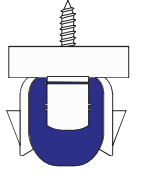

BLUE GE CONTOUR LED STRIPS MTD. WITH ACRYLIC BUTTONS ON APPROX. 18" CTRS.

CONTOUR LEDS

940-02± TOTAL LENGTH OF SINGLE ROW OF GE CONTOUR BLUE LEDS SPANNING TOP ALL ELEVATIONS AS SHOWN

INCLUDE COVER AROUND LED CONTOUR - TO BE POINTED DOWNWARDS

BLUE GE CONTOUR LED STRIPS MTD. WITH ACRYLIC BUTTONS ON APPROX. 18" CTRS. 277V

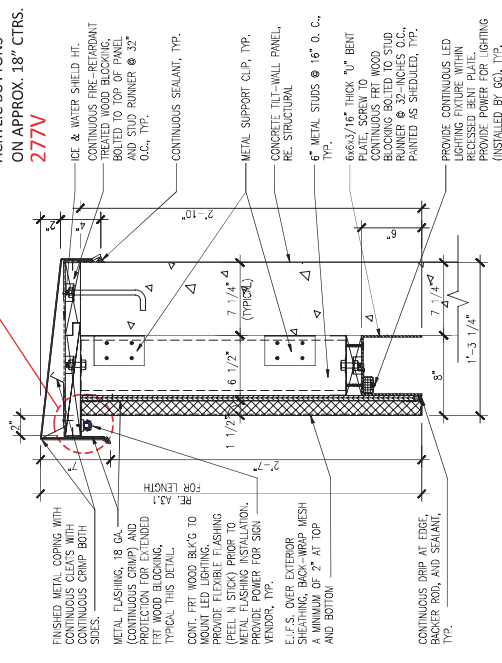

METAL COPING DETAIL

1"=1'-0"





*Chesterfield Topsoil
and Supply, Inc.*
←

OUTLOTS AVAILABLE
1.5 - 4.0 ACRES
Summit
314-863-9991

Summit
314-863-9991





